

WELL SCHEDULE

U. S. DEPT. OF THE INTERIOR

GEOLOGICAL SURVEY

WATER RESOURCES DIVISION

MASTER CARD

Record by JN. Shows Source of data _____ Date _____ Map _____

State 28 County (or town) 34

Latitude: 31 29 38 N Longitude: 08 58 57 Sequential number: 1

Lat-long accuracy: 3 T. 6 S. R. 10 Sec 17 SE $\frac{1}{4}$, SW $\frac{1}{4}$ B & M

Local well number: 00050C1706N10W Other number: _____

Local use: 117 Owner or name: _____

Owner or name: J. McLEMORE Address: _____

Ownership: County, Fed Gov't, City, Corp or Co, Private, State Agency, Water Dist P

Use of water: (A) Air cond, Bottling, Comm, Dewater, Power, Fire, Dom, Irr, Med, Ind, P S, Rec, (S) Stock, Instat, Unused, Repressure, Recharge, Desal-P S, Desal-other, Other H

Use of well: (A) Anode, Drain, Seismic, Heat Res, Obs, Oil-gas, Recharge, Test, Unused, Withdraw, Waste, Destroyed W

DATA AVAILABLE: Well data Freq. W/L meas.: Field aquifer char.

Hyd. lab. data: _____

Qual. water data; type: _____

Freq. sampling: _____ Pumpage inventory: yes, no, period: _____

Aperture cards: _____

Log data: _____

WELL-DESCRIPTION CARD

SAME AS ON MASTER CARD Depth well: _____ ft 278 Meas. rept accuracy 6

Depth cased: _____ ft Casing type: _____; Diam. in _____

Finish: (C) porous concrete, (F) gravel w. (perf.), (G) gravel w. (screen), (H) horiz. gallery, (J) open end, (P) perf., (S) screen, (T) sd. pt., (W) shored, (X) open hole, (Z) other S

Method: (A) air bored, (B) cable, (C) dug, (D) hyd jetted, (H) rot., (J) percussion, (P) reverse, (R) rotary, (T) trenching, (V) driven, (W) drive wash, (Z) other H

Date drilled: 963 Pump intake setting: _____ ft _____

Driller: H.H. BOLER address _____

Lift (type): (A) air, (B) bucket, (C) cent, (J) jet, (L) multiple, (M) multiple, (N) none, (P) piston, (R) rot, (S) submerg, (T) turb, other J Deep Shallow

Power (type): nat, diesel, elec, gas, gasoline, hand, gas, wind; H.P. 1/2 Trans. or meter no. 3

Descrip. MP _____ ft below LSD. Alt. MP _____

Alt. LSD: _____ Accuracy: (source) _____

Water Level: _____ ft above below MP; _____ ft below LSD 40 Accuracy: _____

Date meas: 563 Yield: _____ gpm _____ Method determined _____

Drawdown: _____ ft _____ Accuracy: _____ Pumping period _____ hrs _____

QUALITY OF WATER DATA: Iron _____ ppm Sulfate _____ ppm Chloride _____ ppm Hard. _____ ppm

Sp. Conduct _____ K x 10⁶ Temp. _____ °F Date sampled _____

Taste, color, etc. _____

Well No. Q 5

Latitude-longitude N
S
d m s d m s

HYDROGEOLOGIC CARD

SAME AS ON MASTER CARD Physiographic Province: 03 Section: _____

0 Drainage Basin: 130 Subbasin: _____

Topo of well site: (D) depression, stream channel, dunes, flat, hilltop, sink, swamp, (C) (E) (F) (H) (K) (L) (Ø) (P) (S) (T) (U) (V) offshore, pediment, hillside, terrace, undulating, valley flat 27 H

MAJOR AQUIFER: _____ system _____ series TM _____ aquifer, formation, group EA

Lithology: _____ Origin: 3 Aquifer Thickness: _____ ft

Length of well open to: _____ ft _____ Depth to top of: _____ ft _____

MINOR AQUIFER: _____ system _____ series _____ aquifer, formation, group _____

Lithology: _____ Origin: _____ Aquifer Thickness: _____ ft

Length of well open to: _____ ft _____ Depth to top of: _____ ft _____

Intervals Screened: _____

Depth to consolidated rock: _____ ft _____ Source of data: _____

Depth to basement: _____ ft _____ Source of data: _____

Surficial material: _____ Infiltration characteristics: _____

Coefficient Trans: _____ gpd/ft _____ Coefficient Storage: _____

Coefficient Perm: _____ gpd/ft²; Spec cap: _____ gpm/ft; Number of geologic cards: _____

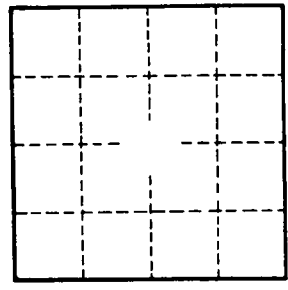
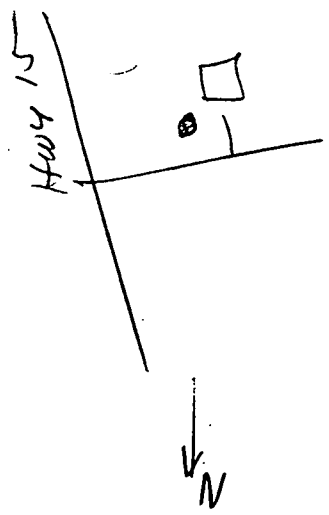

Well No. Q5