

WELL SCHEDULE

U. S. DEPT. OF THE INTERIOR

GEOLOGICAL SURVEY

WATER RESOURCES DIVISION

MASTER CARD

Record by J.A. CALLAHAN Source of data DWG Date 2-27-68 Map

State MISS 28 County (or town) JONES 34

Latitude: 31 41 43 N Longitude: 089 08 39 Sequential number: 1

Lat-long accuracy: 30 T. 8 S, R 11 Sec 6, NW 1/4, NW 1/4

Local well number: G055 B060 8N11W Other number: #4 B & M

Local use: 064 264 14 Owner or name: CITY OF LAUREL

Owner or name: LAUREL Address: LAUREL MISS

Ownership: County, Fed Gov't, (M) City, Corp or Co, Private, State Agency, Water Dist 7

Use of water: Air cond, Bottling, Comm, Dewater, Power, Fire, Dom, Irr, Med, Ind, (P) Rec

Stock, Instit, Unused, Repressure, Recharge, Desal-P S, Desal-other, Other 8

Use of well: Anode, Drain, Seismic, Heat Res, Obs, Oil-gas, Recharge, Test, Unused, (W) Withdraw, Waste, Destroyed 9

DATA AVAILABLE: Well data Freq. W/L meas.: Field aquifer char. 7

Hyd. lab. data:

Qual. water data; type: USGS 2.5.64

Freq. sampling: Pumpage inventory: no, period:

Aperture cards:

Log data:

WELL-DESCRIPTION CARD

SAME AS ON MASTER CARD Depth well: 405 ft 405 Meas. DWG 3

Depth cased: 345 ft 345 Casing type: Steel Diam. 24x12 in 24

Finish: porous concrete, gravel w. (perf.), gravel w. (screen), horz. gallery, open end, (S) screen, sd. pt., shored, open hole, other 5

Method: Drilled: air bored, cable, dug, (H) hyd rot., jetted, air percussion, rotary, reverse trenching, driven, drive wash, other 4

Date Drilled: 7/1950 950 Pump intake setting: ft 36 38

Driller: LAYNE-CENTRAL CO., JACKSON MISS

Lift (type): air, bucket, cent, jet, multiple, multiple, none, piston, rot, submerg, turb, other (T) turb Deep Shallow

Power (type): diesel, (elec) elec, gas, gasoline, hand, gas, wind; H.P. 60 Trans. or meter no.

Descrip. MP above below LSD. Alt. MP 279.7 Fount. 279.26 279 Accuracy: (source) SURVEYED 47 1

Water Level 126 ft above 126 below MP; 126 below LSD Accuracy: Measured 52 4

Date meas: 364 Yield: 100 15 gpm 480 Method determined 4

Drawdown: ft Accuracy: Pumping period 7 hrs 66 58

QUALITY OF WATER DATA: Iron 24 Sulfate 9.2 Chloride 0 Hard. 11 1

Sp. Conduct 142 K x 10⁶ 1 Temp. 69 Date sampled 3-64 364

Taste, color, etc.

JAN 14 1975

RECORDED AND INDEXED
JAN 14 1975

Well No. G 55

Well No. G55

Latitude-longitude _____
N
S
d m s d m s

HYDROGEOLOGIC CARD

1 SAME AS ON MASTER CARD 19 Physiographic Province: 03 20 21 Section: _____

22 Drainage Basin: D 23 24 Subbasin: 13.0 25 26

Topo of well site: (D) (C) (E) (F) (H) (K) (L) depression, stream channel, dunes, flat, hilltop, sink, swamp, (O) (P) (S) (T) (U) (V) offshore, pediment, hillside, terrace, undulating, valley flat 27

MAJOR AQUIFER: Tertiary system Miocene series T.M. Catahoula aquifer, formation, group C.A. 28 29 30 31

Lithology: Sand 32 33 Origin: deltaic 34 35 Aquifer Thickness: 3 ft

36 Length of well open to: 60 ft 37 38 39 Depth to top of: 345 ft 40 41 42 43

MINOR AQUIFER: _____ system _____ series _____ aquifer, formation, group _____ 44 45 46 47

Lithology: _____ 48 49 Origin: _____ 50 51 Aquifer Thickness: _____ ft

52 Length of well open to: _____ ft 53 54 55 Depth to top of: _____ ft 56 57 58 59

Intervals Screened: 345-405 60' of 12" #7 Brown C

Depth to consolidated rock: _____ ft 60 61 62 Source of data: _____ 64

Depth to basement: _____ ft 63 64 Source of data: _____ 69

Surficial material: _____ 70 71 Infiltration characteristics: _____ 72

Coefficient Trans: 34,000 gpd/ft 343 73 74 Coefficient Storage: _____ 76 78

Coefficient Perm: 485 gpd/ft²; Spec cap: 14.5 gpm/ft; Number of geologic cards: _____ 79

322' of 24"
23' of 12"

WL recorder installed
2/12/75

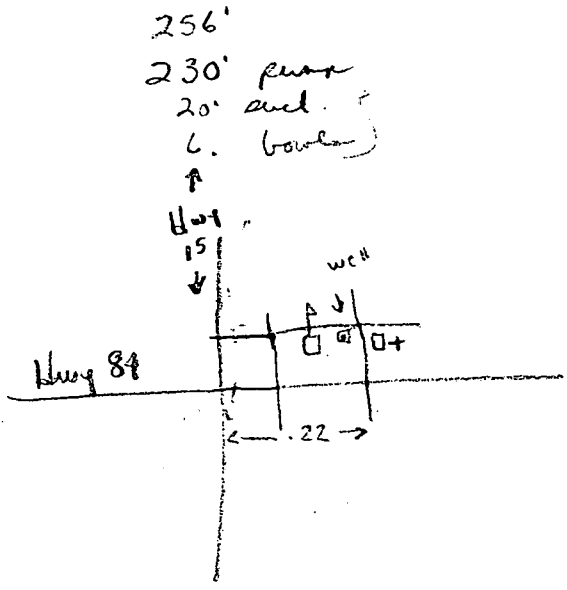
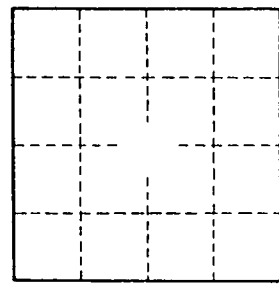

Well No.

G55