

WRD Exp. (GW)
April 1966

Well No. D44

WELL SCHEDULE

U. S. DEPT. OF THE INTERIOR

GEOLOGICAL SURVEY

WATER RESOURCES DIVISION

MASTER CARD

Record by TN SHOUS Source of data _____ Date _____ Map _____

State 28 County 4 (or town) _____

Latitude: 31 46 41 N Longitude: 08 90 23 5 Sequential number: 1

Lat-long accuracy: 3 70 T. 9 S, R. 10 Sec 6, SW & NW B & M

Local well number: D044CB0609N10W Other number: _____

Local use: 028 Owner or name: SANDERSVILLE SCHOOL

Owner or name: SANDERSVILLE SH Address: _____

Ownership: County, Fed Gov't, City, Corp or Co, Private, State Agency, Water Dist C

Use of Air cond, Bottling, Comm, Dewater, Power, Fire, Dom, Irr, Med, Ind, P S, Rec, water: _____

Use of well: Anode, Drain, Seismic, Heat Res, Obs, Oil-gas, Recharge, Test, Unused, Withdraw, Waste, Destroyed W

DATA AVAILABLE: Well data Freq. W/L meas.: Field aquifer char.

Hyd. lab. data: _____

Qual. water data; type: _____

Freq. sampling: _____ Pumpage inventory: yes, no, period: _____

Aperture cards: _____

Log data: _____

WELL-DESCRIPTION CARD

SAME AS ON MASTER CARD Depth well: _____ ft 220 Meas. 6 accuracy _____

Depth cased; (first perf.) _____ ft _____ Casing type: _____; Diam. _____ in 2

Finish: porous concrete, gravel w. (perf.), gravel w. (screen), horiz. gallery, open end, perf., screen, sd. pt., shored, open hole, other _____

Method Drilled: air bored, cable, dug, hyd rot., jetted, air percussion, rotary, reverse trenching, driven, drive wash, other _____

Date Drilled: 9-5-8 Pump intake setting: _____ ft _____

Driller: P. CLARK name _____ address _____

Lift (type): air, bucket, cent, jet, multiple (cent.), multiple (turb.), none, piston, rot, submerg, turb, other J Deep Shallow

Power (type): diesel, elec, gas, gasoline, hand, gas, wind; H.P. _____ LP T Trans. or meter no. _____

Descrip. MP _____ ft above _____ below LSD. Alt. MP _____

Alt. LSD: _____ Accuracy: _____

Water Level _____ ft above _____ below MP; Ft below LSD 60 Accuracy: _____

Date meag: 7.5.8 Yield: _____ gpm _____ Method determined _____

Drawdown: _____ ft _____ Accuracy: _____ Pumping period _____ hrs _____

QUALITY OF WATER DATA: Iron _____ ppm Sulfate _____ ppm Chloride _____ ppm Hard. _____ ppm

Sp. Conduct _____ K x 10⁶ Temp. _____ °F Date sampled _____

Taste, color, etc. _____

PUNCHED AND VERIFIED
ROLLA, MISSOURI

WELL NO. D44

Well No. D44

Latitude-longitude N
S
d m s d m s

HYDROGEOLOGIC CARD

SAME AS ON MASTER CARD 03 **Section:** _____
Province: _____

D **Drainage Basin:** 130 **Subbasin:** _____

Topo of well site: (D) depression, stream channel, dunes, flat, hilltop, sink, swamp, (E) (F) (H) (K) (L) (O) (P) (S) (T) (U) (V) H
offshore, pediment, hillside, terrace, undulating, valley flat

MAJOR AQUIFER: _____ T **series** _____ Y.G **aquifer, formation, group** _____
system _____

Lithology: _____ M.L **Origin:** _____ 6 **Aquifer Thickness:** _____ ft

Length of well open to: _____ ft _____ **Depth to top of:** _____ ft _____

MINOR AQUIFER: _____ **series** _____ **aquifer, formation, group** _____
system _____

Lithology: _____ **Origin:** _____ **Aquifer Thickness:** _____ ft

Length of well open to: _____ ft _____ **Depth to top of:** _____ ft _____

Intervals Screened: _____

Depth to consolidated rock: _____ ft _____ **Source of data:** _____

Depth to basement: _____ ft _____ **Source of data:** _____

Surficial material: _____ **Infiltration characteristics:** _____

Coefficient Trans: _____ **Coefficient Storage:** _____

Coefficient Perm: _____ **Spec cap:** _____ **Number of geologic cards:** _____

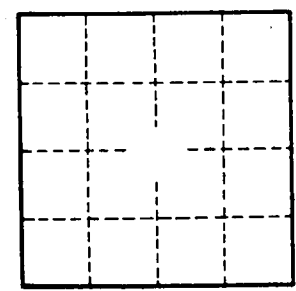
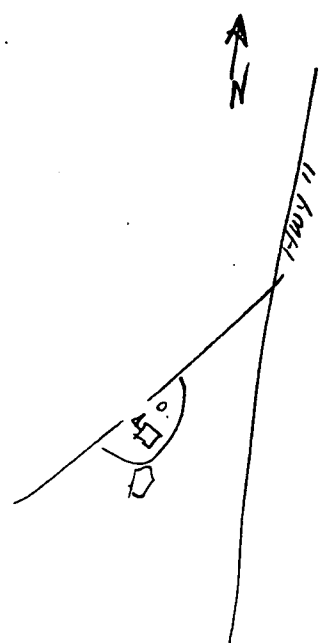

Well No. D44