

WELL SCHEDULE

U. S. DEPT. OF THE INTERIOR

GEOLOGICAL SURVEY

WATER RESOURCES DIVISION

MASTER CARD

Record by TN SHOWE Source of data _____ Date _____ Map _____

State 28 County 34
(or town) _____

Latitude: 31^{deg} 42^{min} 41^{sec} N Longitude: 08^{degrees} 85^{min} 73^{sec} 8 Sequential number: 1

Lat-long accuracy: 30 T. 10^N S, R. 10^E Sec 25, SW $\frac{1}{4}$, SW $\frac{1}{4}$, _____ B & M

Local well number: D042CC2510N10W Other number: _____

Local use: 028 Owner or name: _____

Owner or name: HUMBLE OIL CO. Address: _____

Ownership: County, Fed Gov't, City, Corp or Co, Private, State Agency, Water Dist N

Use of water: (A) Air cond, Bottling, Comm, Dewater, Power, Fire, Dom, Irr, Med, Ind, P S, Rec, _____
(S) Stock, Instit, Unused, Repressure, Recharge, Desal-P S, Desal-other, Other N

Use of well: (A) Anode, Drain, Seismic, Heat Res, Obs, Oil-gas, Recharge, Test, Unused, Withdraw, Waste, Destroyed A

DATA AVAILABLE: Well data Freq. W/L meas.: Field aquifer char.

Hyd. lab. data: _____

Qual. water data; type: _____

Freq. sampling: _____ Pumpage inventory: yes, no, period: _____

Aperture cards: _____

Log data: _____

WELL-DESCRIPTION CARD

SAME AS ON MASTER CARD Depth well: _____ ft 484 Meas. rept accuracy 6

Depth cased: _____ ft 462 Casing type: _____; Diam. _____ in 2

Finish: (C) porous concrete, (F) gravel w. (perf.), (G) gravel w. (screen), (H) horiz. gallery, (φ) open end, (P) perf., (S) screen, (T) sd. pt., (W) shored, (X) open hole, (Z) other S

Method Drilled: (A) air rot, (B) bored, (C) cable, (D) dug, (H) rot., (J) jetted, (P) air percussion, (R) reverse, (T) trenching, (V) driven, (W) drive wash, (Z) other H

Date Drilled: 962 Pump intake setting: _____ ft _____

Driller: CP CLARK name address _____

Lift (type): (A) air, (B) bucket, (C) cent, (J) multiple, (L) multiple, (M) multiple, (N) none, (P) piston, (R) rot, (S) submerg, (T) turb, other 1 Deep Shallow

Power (type): nat diesel, elec, gas, gasoline, hand, gas, wind; LP H.P. 11/2 Trans. or meter no. 7

Descrip. MP _____ ft above _____ ft below LSD. Alt. MP _____

Alt. LSD: _____ Accuracy: (source) 4

Water Level _____ ft above MP; _____ ft below LSD 85 Accuracy: _____

Date meas: 262 Yield: _____ gpm _____ Method determined _____

Drawdown: _____ ft _____ Accuracy: _____ Pumping period _____ hrs _____

QUALITY OF WATER DATA: Iron _____ ppm Sulfate _____ ppm Chloride _____ ppm Hard. _____ ppm

Sp. Conduct _____ K x 10⁶ Temp. _____ °F Date sampled _____

Taste, color, etc. _____

FURNISHED BY THE DIVISION

WELL NO. D42

Well No. D42

Latitude-longitude N
S
d m s d m s

HYDROGEOLOGIC CARD

SAME AS ON MASTER CARD 03 **Section:** _____
Province: _____

D **Drainage Basin:** 130 **Subbasin:** _____

Topo of well site: (D) depression, stream channel, dunes, flat, hilltop, sink, swamp, (C) (E) (F) (H) (K) (L) (O) (P) (S) (T) (U) (V) offshore, pediment, hillside, terrace, undulating, valley flat S

MAJOR AQUIFER: _____ system _____ series TE _____ aquifer, formation, group C:0

Lithology: _____ **Origin:** _____ **Aquifer Thickness:** _____ ft

Length of well open to: _____ ft **Depth to top of:** _____ ft

MINOR AQUIFER: _____ system _____ series _____ aquifer, formation, group _____

Lithology: _____ **Origin:** _____ **Aquifer Thickness:** _____ ft

Length of well open to: _____ ft **Depth to top of:** _____ ft

Intervals Screened: _____

Depth to consolidated rock: _____ ft **Source of data:** _____

Depth to basement: _____ ft **Source of data:** _____

Surficial material: _____ **Infiltration characteristics:** _____

Coefficient Trans: _____ gpd/ft **Coefficient Storage:** _____

Coefficient Perm: _____ gpd/ft²; **Spec cap:** _____ gpm/ft; **Number of geologic cards:** _____

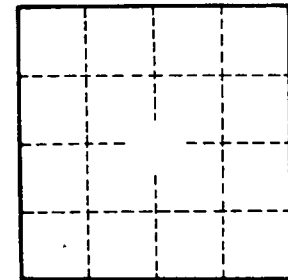
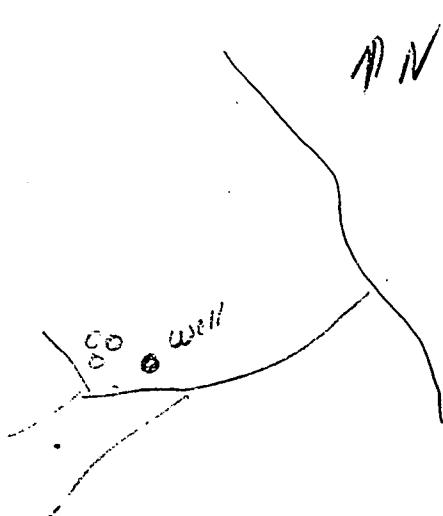

Well No. _____

D42