

PUNCHED and VERIFIED  
ROLLA COMPUTATION BRANCH

WRD Exp. (GW)  
April 1966

Well No. B23

### WELL SCHEDULE

U. S. DEPT. OF THE INTERIOR

GEOLOGICAL SURVEY

WATER RESOURCES DIVISION

#### MASTER CARD

Record by Shows 65 Source of data \_\_\_\_\_ Date \_\_\_\_\_ Map \_\_\_\_\_

State 28 County (or town) 34

Latitude: 31 deg 42 min 27 sec N Longitude: 08 deg 9 min 13 sec 06 W Sequential number: 1

Lat-long accuracy: 3 T. 9 S, R 12 Sec 32, SW 1/4, NE 1/4

Local well number: B023CA3209N12W Other number: \_\_\_\_\_ B & M

Local use: UKN Owner or name: \_\_\_\_\_

Owner or name: WAHOLLINGSWORTH Address: \_\_\_\_\_

Ownership: County, Fed Gov't, City, Corp or Co, (P) Private, State Agency, Water Dist \_\_\_\_\_

Use of water: (S) Stock, (T) Insitit, (U) Unused, (V) Repressure, (W) Recharge, (X) Desal-P S, (Y) Desal-other, (Z) Other \_\_\_\_\_

Use of well: (A) Anode, (D) Drain, (G) Seismic, (H) Heat Res, (I) Obs, (J) Oil-gas, (K) Recharge, (L) Test, (M) Unused, (N) Withdraw, (O) Waste, (P) Destroyed \_\_\_\_\_

DATA AVAILABLE: Well data  Freq. W/L meas.:  Field aquifer char.

Hyd. lab. data: \_\_\_\_\_

Qual. water data; type: \_\_\_\_\_

Freq. sampling: \_\_\_\_\_ Pumpage inventory:  yes  no; period: \_\_\_\_\_

Aperture cards: \_\_\_\_\_

Log data: \_\_\_\_\_

#### WELL-DESCRIPTION CARD

SAME AS ON MASTER CARD Depth well: \_\_\_\_\_ ft 90 Meas. rept. accuracy \_\_\_\_\_

Depth cased: \_\_\_\_\_ ft Casing type: Steel; Diam. 2 in

Finish: (C) porous concrete, (F) gravel w. (perf.), (G) gravel w. (screen), (H) horiz. gallery, (I) open end, (J) perf., (K) screen, (L) sd. pt., (M) shored, (N) open hole, (O) other \_\_\_\_\_

Method Drilled: (A) air rot, (B) bored, (C) cable, (D) dug, (E) hyd rot, (F) jetted, (G) air percussion, (H) rotary, (I) reverse trenching, (J) driven, (K) drive wash, (L) other \_\_\_\_\_

Date Drilled: \_\_\_\_\_ Pump intake setting: \_\_\_\_\_ ft \_\_\_\_\_

Driller: \_\_\_\_\_ name \_\_\_\_\_ address \_\_\_\_\_

Lift (type): (A) air, (B) bucket, (C) cent. jet, (D) multiple, (E) multiple, (F) none, (G) piston, (H) rot., (I) submerg., (J) turb., (K) other \_\_\_\_\_ Deep  Shallow

Power (type): (A) diesel, (B) elec, (C) gas, (D) gasoline, (E) hand, (F) gas, (G) wind; H.P. 3/4 Trans. or meter no. 5

Descrip. MP \_\_\_\_\_ above \_\_\_\_\_ ft below LSD. Alt. MP \_\_\_\_\_

Alt. LSD: \_\_\_\_\_ Accuracy: (source) \_\_\_\_\_

Water Level: \_\_\_\_\_ ft above \_\_\_\_\_ ft below MP; \_\_\_\_\_ ft below LSD Accuracy: \_\_\_\_\_

Date meas: \_\_\_\_\_ Yield: \_\_\_\_\_ gpm \_\_\_\_\_ Method determined \_\_\_\_\_

Drawdown: \_\_\_\_\_ ft Accuracy: \_\_\_\_\_ Pumping period: \_\_\_\_\_ hrs \_\_\_\_\_

QUALITY OF WATER DATA: Iron \_\_\_\_\_ ppm Sulfate \_\_\_\_\_ ppm Chloride \_\_\_\_\_ ppm Hard. \_\_\_\_\_ ppm

Sp. Conduct \_\_\_\_\_ K x 10<sup>6</sup> \_\_\_\_\_ Temp. \_\_\_\_\_ °F \_\_\_\_\_ Date sampled \_\_\_\_\_

Taste, color, etc. \_\_\_\_\_

Well No. B23

Well No. B 23

Latitude-longitude \_\_\_\_\_  
N  
S  
d m s d m s

HYDROGEOLOGIC CARD

SAME AS ON MASTER CARD 03 Section: \_\_\_\_\_  
Province: \_\_\_\_\_

D Drainage Basin: \_\_\_\_\_ Subbasin: \_\_\_\_\_  
22 23 24 25 26

Topo of well site: (D) depression, stream channel, dunes, flat, hilltop, sink, swamp, (E) (F) (H) (K) (L) (O) (P) (S) (T) (U) (V) \_\_\_\_\_  
offshore, pediment, hillside, terrace, undulating, valley flat 27 S

MAJOR AQUIFER: Tertiary system, Miocene series, TM aquifer, formation, group, CA  
28 29 30 31

Lithology: \_\_\_\_\_ Origin: \_\_\_\_\_ Aquifer Thickness: \_\_\_\_\_ ft  
32 33 34

Length of well open to: \_\_\_\_\_ ft Depth to top of: \_\_\_\_\_ ft  
35 37 38 40 41 43

MINOR AQUIFER: \_\_\_\_\_ system, \_\_\_\_\_ series, \_\_\_\_\_ aquifer, formation, group, \_\_\_\_\_  
44 45 46 47

Lithology: \_\_\_\_\_ Origin: \_\_\_\_\_ Aquifer Thickness: \_\_\_\_\_ ft  
48 49 50

Length of well open to: \_\_\_\_\_ ft Depth to top of: \_\_\_\_\_ ft  
51 53 54 56 57 59

Intervals Screened: \_\_\_\_\_  
Depth to consolidated rock: \_\_\_\_\_ ft Source of data: \_\_\_\_\_ 64

Depth to basement: \_\_\_\_\_ ft Source of data: \_\_\_\_\_ 69

Surficial material: \_\_\_\_\_ Infiltration characteristics: \_\_\_\_\_ 72

Coefficient Trans: \_\_\_\_\_ gpd/ft Coefficient Storage: \_\_\_\_\_ 76 78

Coefficient Perm: \_\_\_\_\_ gpd/ft<sup>2</sup>; Spec cap: \_\_\_\_\_ gpm/ft; Number of geologic cards: \_\_\_\_\_ 79

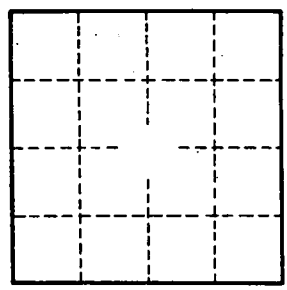
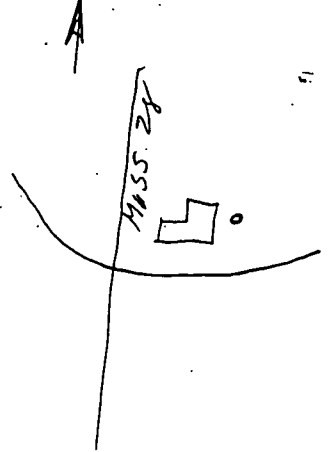

Well No. \_\_\_\_\_

B 23