

WELL SCHEDULE

U. S. DEPT. OF THE INTERIOR

GEOLOGICAL SURVEY

WATER RESOURCES DIVISION

PURCHASED BY VERIFIED
ROLLA COMPUTATION BRANCH

MASTER CARD

Record by TN Shows Source of data Driller Date 4-28-67 Map Jasper Co. Hwy

State MISSISSIPPI County Jasper Sequential number: 31

Latitude: 31 deg 57 min 57 sec N Longitude: 08 deg 58 min 05 sec W

Lat-long accuracy: 1 T, 2 S, R, 13 W, Sec 33, SW 1/4, SE 1/4

Local well number: M 0 0 2 P D 3 3 0 2 N 1 3 E Other number: _____

Local use: 0 1 7 Owner or name: T. L. James Construction Co

Owner or name: T L JAMES CONSTRUCTION Address: Vossburg, Miss.

Ownership: County, Fed Gov't, City, Corp or Co, (P) Private, State Agency, Water Dist _____

Use of Air cond, Bottling, Comm, Dewater, Power, Fire, Dom, Irr, Med, Ind, P S, Rec, _____

water: (S) (T) (U) (V) (W) (X) (Y) (Z) Cement Plant N

Use of well: (A) (D) (G) (H) (I) (J) (K) (L) (M) (N) (O) (P) (Q) (R) (S) (T) (U) (V) (W) (X) (Y) (Z) Withdraw W

DATA AVAILABLE: Well data 1 Freq. W/L meas.: _____ Field aquifer char. _____

Hyd. lab. data: _____

Qual. water data; type: Complete Chemical Anal. 6-8-67

Freq. sampling: 0 Pumpage inventory: no, period: _____

Aperture cards: _____

Log data: _____

WELL-DESCRIPTION CARD

SAME AS ON MASTER CARD Depth well: 483 ft Meas. 483 Meas. accuracy 330

Depth cased: 423 ft Casing type: _____; Diam. 6x4 in

Finish: (C) concrete, (F) gravel w. concrete, (G) gravel w. (screen), (H) horiz. gallery, (I) open end, (J) other _____

Method: (A) air rot, (B) bored, (C) cable, (D) dug, (E) hyd, (F) jetted, (G) air percussion, (H) rotary, (I) reverse, (J) trenching, (K) driven, (L) drive _____

Date Drilled: 4-7-67 Pump intake setting: 251 T.O. of tail pipe

Driller: Peoples Drq. Co., Enterprise, Miss.

Lift (type): (A) air, (B) bucket, (C) cent, (D) jet, (E) multiple, (F) multiple, (G) none, (H) piston, (I) rot, (J) submerg, (K) turb, (L) other _____

Power (type): diesel, elec gas, gasoline, hand, gas, wind; H.P. 25 Trans. or meter no. _____

Descrip. MP _____ ft above LSD . Alt. MP _____

Alt. LSD: 520 Accuracy: 520

Water Level: 227 ft above below MP; Ft below LSD 227 Accuracy: _____

Date meas: 4-7-67 Yield: 225 gpm 225 Method determined _____

Drawdown: _____ ft Accuracy: _____ Pumping period _____ hrs

QUALITY OF WATER DATA: Iron _____ Sulfate _____ Chloride _____ Hard. _____

Sp. Conduct 680 K x 10⁶ Temp. 72 °F Date sampled 6-8-67

Taste, color, etc. pH = 7.3

403'-6" casing
10'-4" 1 1/2"
60'-screen-4" .012-SS.

403

Well No.

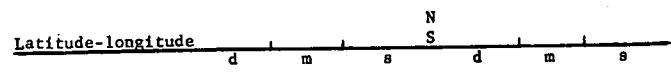

HYDROGEOLOGIC CARD

SAME AS ON MASTER CARD Physiographic Province: Coastal Plain 03 Section: East Gulf

Coastal Plain D Drainage Basin: 130 Subbasin: 26

Topo of well site: (D) depression, stream channel, dunes, flat, hilltop, sink, swamp, (K) (L) (U) (V) offshore, pediment, hillside, terrace, undulating, valley flat 27

MAJOR AQUIFER: Tertiary system, Eocene series, TE aquifer, formation, group, Cockfield Formation C

Lithology: S Origin: 2 Aquifer Thickness: _____ ft

Length of well open to: _____ ft 60 Depth to top of: _____ ft

MINOR AQUIFER: _____ system, _____ series, _____ aquifer, formation, group

Lithology: _____ Origin: _____ Aquifer Thickness: _____ ft

Length of well open to: _____ ft _____ Depth to top of: _____ ft

Intervals Screened:

Depth to consolidated rock: _____ ft _____ Source of data: _____ 64

Depth to basement: _____ ft _____ Source of data: _____ 69

Surficial material: _____ Infiltration characteristics: _____ 72

Coefficient Trans: _____ gpd/ft _____ Coefficient Storage: _____ 78

Coefficient Perm: _____ gpd/ft²; Spec cap: _____ gpm/ft; Number of geologic cards: _____ 79

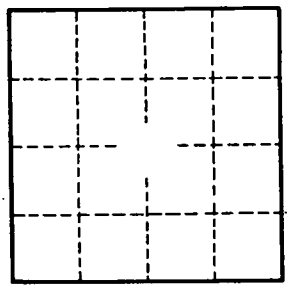
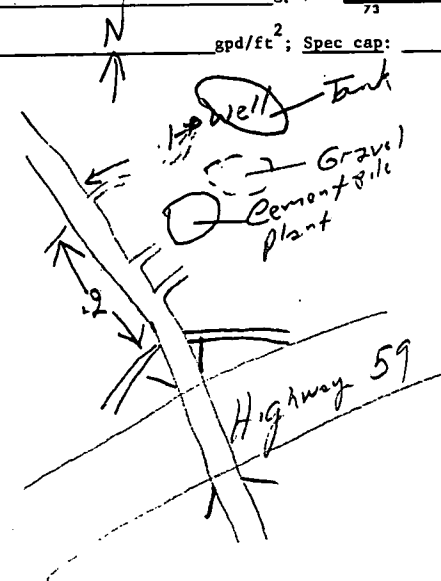

Well No. M2