

WRD Exp. (GW)
April 1966

Well No. 19

WELL SCHEDULE

3520 L-451

U. S. DEPT. OF THE INTERIOR

GEOLOGICAL SURVEY

WATER RESOURCES DIVISION

PUNCHED and VERIFIED
ROLLA COMPUTATION BRANCH

MASTER CARD

Record by R. Hirt Source of data owner Date 2-27-67 Map _____

State Miss 28 County (or town) Jasper 31

Latitude: 32 02 25 N Longitude: 08 9 16 0 6 Sequential number: 1

Lat-long accuracy: 3 T. 20 S. R. 10 W. Sec. 3 SE 1 NW 1

Local well number: 009 DB0302N10E Other number: _____

Local use: 018 Owner or name: Pineview Golf Sta. & Cafe, (D. Simmons)
Address: Bay Springs

Owner or name: PINEVIEW LAKE Address: _____

Ownership: County (C) Fed Gov't (F) City, Corp or Co. (M) Private (P) State Agency (S) Water Dist (W) P

Use of water: (A) Air cond, Bottling, Comm, Dewater, Power, Fire, (H) Dom Irr, Med, Ind, P S, Rec, (I) (M) (N) (P) (R)

(S) Stock, Instat, Unused, Repressure, Recharge, Desal-P S, Desal-other, Other H

Use of well: (A) Anode, Drain, Seismic, Heat Res, Obs, Oil-gas, Recharge, Test, Unused, (W) Withdraw, (X) Waste, Destroyed W

DATA AVAILABLE: Well data 2 Freq. W/L meas.: 0 Field aquifer char. 0

Hyd. lab. data: _____

Qual. water data; type: _____

Freq. sampling: _____ Pumpage inventory: no, period: _____

Aperture cards: _____

Log data: _____

10/26/89
58.00

WELL-DESCRIPTION CARD

SAME AS ON MASTER CARD Depth well: 545 ft 545 Meas. repr. accuracy 2 1/2

Depth cased: _____ ft Casing type: Steel; Diam. 4x3x in

Finish: porous concrete, gravel w. (perf.), (screen), (horiz. gallery), open end, (S) (T) (W) (X) (Z) 3

Method: (A) air bored, cable, dug, (H) hyd jetted, (P) air reverse trenching, driven, drive wash, (V) (W) (Z) H

Drilled: rot, percussion, rotary, other _____

Date Drilled: 1951 951 Pump intake setting: _____ ft

Driller: H.J. Maxey Laurel, Miss

Lift (type): (A) air, bucket, cent, jet, (M) multiple, (N) none, (P) piston, (R) rot, (S) submerg, (T) turb, other T Deep 0 Shallow 40

Power (type): diesel, elec gas, gasoline, hand, gas, wind; H.P. 7 Trans. or meter no. _____

Alt. LSD: 395 Accuracy: _____

Water Level 45 ft above MP; Ft 45 below LSD Accuracy: _____

Date meag: 1951 51 Yield: _____ gpm Method determined _____

Drawdown: _____ ft Accuracy: _____ Pumping period: _____ hrs

QUALITY OF WATER DATA: Iron _____ ppm Sulfate _____ ppm Chloride _____ ppm Hard. _____ ppm

Sp. Conduct _____ K x 10⁶ Temp. _____ °F Date sampled _____

Taste, color, etc. _____

12/22/80
70
10.75
59.22
1.0
58.22
375
58
317
undrad 2" well
with bit comp.
may not be
1951 well

Well No. 19

Well No. J9

Latitude-longitude d m s N S d m s

HYDROGEOLOGIC CARD

SAME AS ON MASTER CARD Physiographic Province: 03 Section: _____

Drainage Basin: 0 Subbasin: 130

Topo of well site: (D) depression, stream channel, dunes, flat, hilltop, sink, swamp, (C) _____, (E) _____, (F) _____, (M) _____, (K) _____, (L) _____, (N) _____, (P) _____, (S) _____, (T) terrace, (U) _____, (V) _____

MAJOR AQUIFER: Tertiary Eocene system series TE aquifer, formation, group Cockfield CO

Lithology: Sand Origin: deltaic 3 Aquifer Thickness: _____ ft

Length of well open to: _____ ft Depth to top of: _____ ft

MINOR AQUIFER: _____ system series _____ aquifer, formation, group _____

Lithology: _____ Origin: _____ Aquifer Thickness: _____ ft

Length of well open to: _____ ft Depth to top of: _____ ft

Intervals Screened: _____

Depth to consolidated rock: _____ ft Source of data: _____

Depth to basement: _____ ft Source of data: _____

Surficial material: _____ Infiltration characteristics: _____

Coefficient Trans: _____ gpd/ft Coefficient Storage: _____

Coefficient Perm: _____ gpd/ft²; Spec cap: _____ gpm/ft; Number of geologic cards: _____

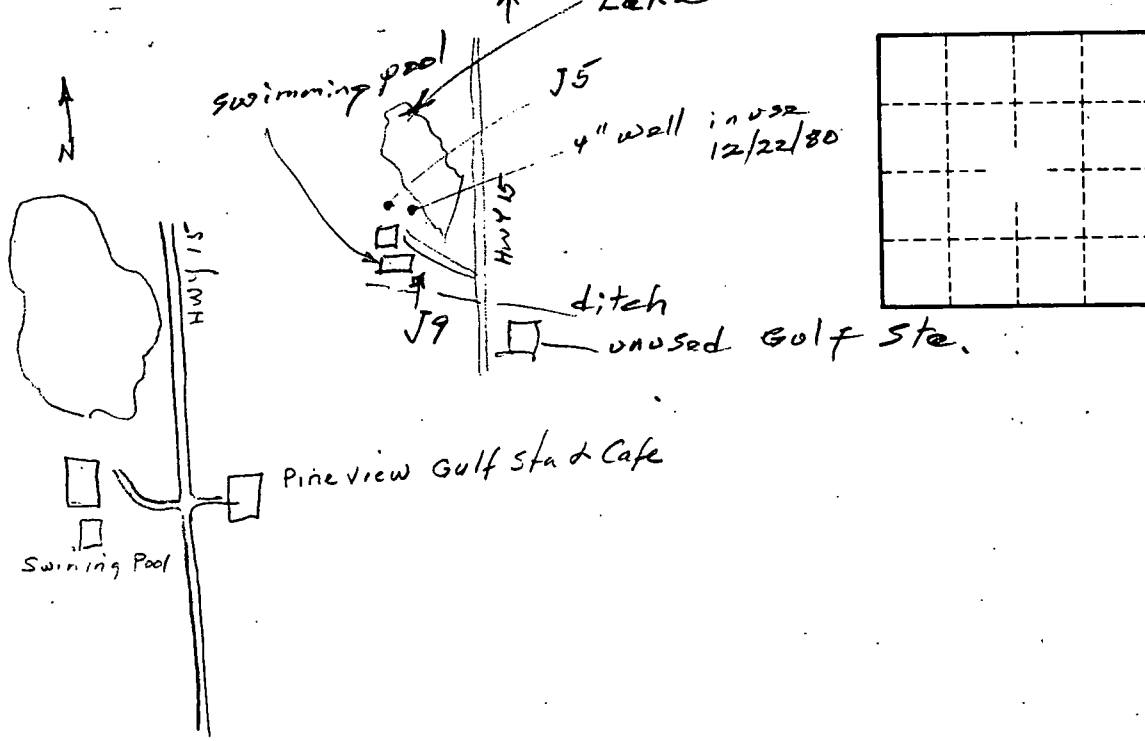

Well No. J9

