

WELL SCHEDULE

U. S. DEPT. OF THE INTERIOR

GEOLOGICAL SURVEY

WATER RESOURCES DIVISION

PUNCHED AND VERIFIED  
ROLLA COMPUTATION BRANCH

MASTER CARD

Record by J.A. Callahan Source of data MRBOWC Date 5-24-67 Map Miss Hwy Map

State Miss County (or town) Jasper Sequential number: 31

Latitude: 32° 05' 12" N Longitude: 088° 55' 00" W

Lat-long accuracy: 2' T. 3' S, R. 13' W, Sec 24, SW 1/4, NE 1/4

Local well number: H004CA2403N13E Other number: B & M

Local use: 017 Owner or name: Will Byrd

Owner or name: WILL BYRD Address: Fachuta Miss

Ownership: County, Fed Gov't, City, Corp or Co Private, State Agency, Water Dist P

Use of water: (A) Air cond, (B) Bottling, (C) Comm, (D) Dewater, (E) Power, (F) Fire, (G) Dom, (H) Irr, (I) Med, (J) Ind, (K) P S, (L) Rec, (M) Stock, (N) Instit, (O) Unused, (P) Repressure, (Q) Recharge, (R) Desal-P S, (S) Desal-other, (T) Other H

Use of well: (A) Anode, (B) Drain, (C) Seismic, (D) Heat Res, (E) Obs, (F) Oil-gas, (G) Recharge, (H) Test, (I) Unused, (J) Withdraw, (K) Waste, (L) Destroyed W

DATA AVAILABLE: Well data  Freq. W/L meas.:  Field aquifer char.

Hyd. lab. data:

Qual. water data; type:

Freq. sampling:  Pumpsage inventory:  yes  no  period:

Aperture cards:  yes

Log data:

WELL-DESCRIPTION CARD

SAME AS ON MASTER CARD Depth well: 216 ft Meas. rept 216 accuracy 6

Depth cased; (first perf.): 210 ft Casing type: steel; Diam. 2 in

Finish: porous concrete, gravel w. (perf.), gravel w. (screen), horiz. gallery, open end, perf., screen, sd. pt., stored, open hole, other S

Method Drilled: (A) air rot, (B) bored, (C) cable, (D) dug, (E) hyd rot, (F) jetted, (G) air percussion, (H) rotary, (I) reverse, (J) trenching, (K) driven, (L) wash, (M) other H

Date Drilled: 11/65 9.65 Pump intake setting:          ft

Driller: Peoples Drlg Co, Enterprise Miss

Lift (type): (A) air, (B) bucket, (C) cent jet, (D) multiple, (E) multiple, (F) none, (G) piston, (H) rot, (I) submerg, (J) turb, (K) other J Deep  Shallow

Power (type): diesel, elec, nat gas, gasoline, hand, gas, wind; H.P. 1 hp S Trans. or meter no.         

Descrip. MP          ft above LSD, Alt. MP         

Alt. LSD:          Accuracy: (source)         

Water Level 65 ft above MP; Ft below LSD 65 Accuracy: rept

Date meas: 11/65 N.65 Yield:          gpm Method determined         

Drawdown:          ft Accuracy:          Pumping period          hrs

QUALITY OF WATER DATA: Iron          ppm Sulfate          ppm Chloride          ppm Hard.          ppm

Sp. Conduct 220 K x 10 2 Temp.          °F Date sampled         

Taste, color, etc. Fe stain

Well No. 44

Well No. H4

Latitude-longitude 32.05.12<sup>N</sup> 088.55.00<sup>W</sup>

HYDROGEOLOGIC CARD

SAME AS ON MASTER CARD Physiographic Province: 03 Section: \_\_\_\_\_  
 Drainage Basin: D 13P Subbasin: \_\_\_\_\_  
 Topo of well site: (D) (C) (E) (F) (H) (K) (L) \_\_\_\_\_  
 (S) (P) (T) (U) (V) \_\_\_\_\_  
 offshore, pediment, hillside, terrace, undulating, valley flat S  
 MAJOR AQUIFER: Tertiary Eocene TE Cochise Santa 55  
 system series aquifer, formation, group  
 Lithology: Sand S Origin: deltaic 3 Aquifer Thickness: \_\_\_\_\_ ft  
 Length of well open to: 6 ft 6 Depth to top of: \_\_\_\_\_ ft 189  
 MINOR AQUIFER: \_\_\_\_\_ \_\_\_\_\_ aquifer, formation, group \_\_\_\_\_ Aquifer Thickness: \_\_\_\_\_ ft  
 Lithology: \_\_\_\_\_ \_\_\_\_\_ Origin: \_\_\_\_\_ \_\_\_\_\_ Thickness: \_\_\_\_\_ ft  
 Length of well open to: \_\_\_\_\_ ft \_\_\_\_\_ Depth to top of: \_\_\_\_\_ ft \_\_\_\_\_  
 Intervals Screened: 2" 210-216  
 Depth to consolidated rock: \_\_\_\_\_ ft \_\_\_\_\_ Source of data: \_\_\_\_\_ \_\_\_\_\_  
 Depth to basement: \_\_\_\_\_ ft \_\_\_\_\_ Source of data: \_\_\_\_\_ \_\_\_\_\_  
 Surficial material: \_\_\_\_\_ P Infiltration characteristics: \_\_\_\_\_ 4  
 Coefficient Trans: \_\_\_\_\_ gpd/ft \_\_\_\_\_ Coefficient Storage: \_\_\_\_\_ \_\_\_\_\_  
 Coefficient Perm: \_\_\_\_\_ gpd/ft<sup>2</sup>; Spec cap: \_\_\_\_\_ gpm/ft; Number of geologic cards: \_\_\_\_\_ \_\_\_\_\_

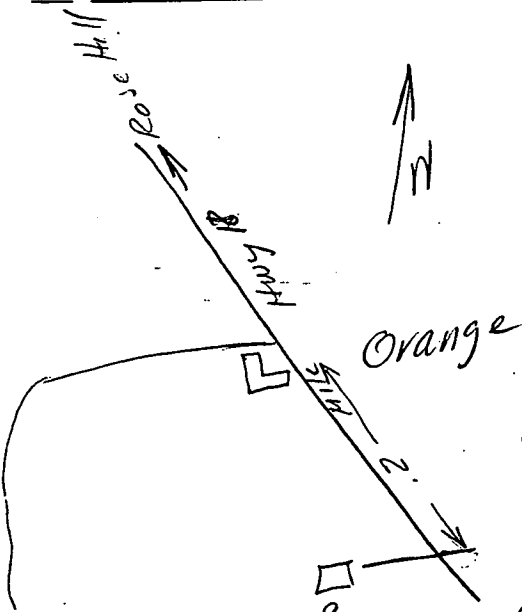

- Yellow sandy clay 0-28
- & small sand str.
- Blue clay & sand str. 28-42
- Blue clay 42-90
- lime & lime rock 90-147
- Gray shale 147-158
- Gray shale & brown shale 158-189
- White sand 189-216

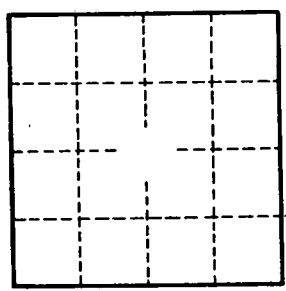

Well No. H4