

Date: **10/13/30/1974**

LOGS
 R-198* Log 1991 D Top 200-10-0
 R-198* Log 1991 E Top 200-10-0
 R-189* Log No. 1901-169

ANAL.
 R-114* Year 1951

AQUIFERS
 R-90* 2561 Top 91-620-120
 Unit ID 93-124SPRT Name of Unit
 R-90* 2561 Top 91-620-120
 Unit ID 93- Name of Unit

HYDRAULICS
 R-98* 99# Unit tested 100-103-
 R-105* 99# Test No. 106#
 107- Transmissivity (gal/d)/ft
 108- Hydraul. cond. (gal/d)/ft
 110- Storage coeff. Boundaries

R-121* Begin 122# Network 258#

Water Level Data Collection (1)

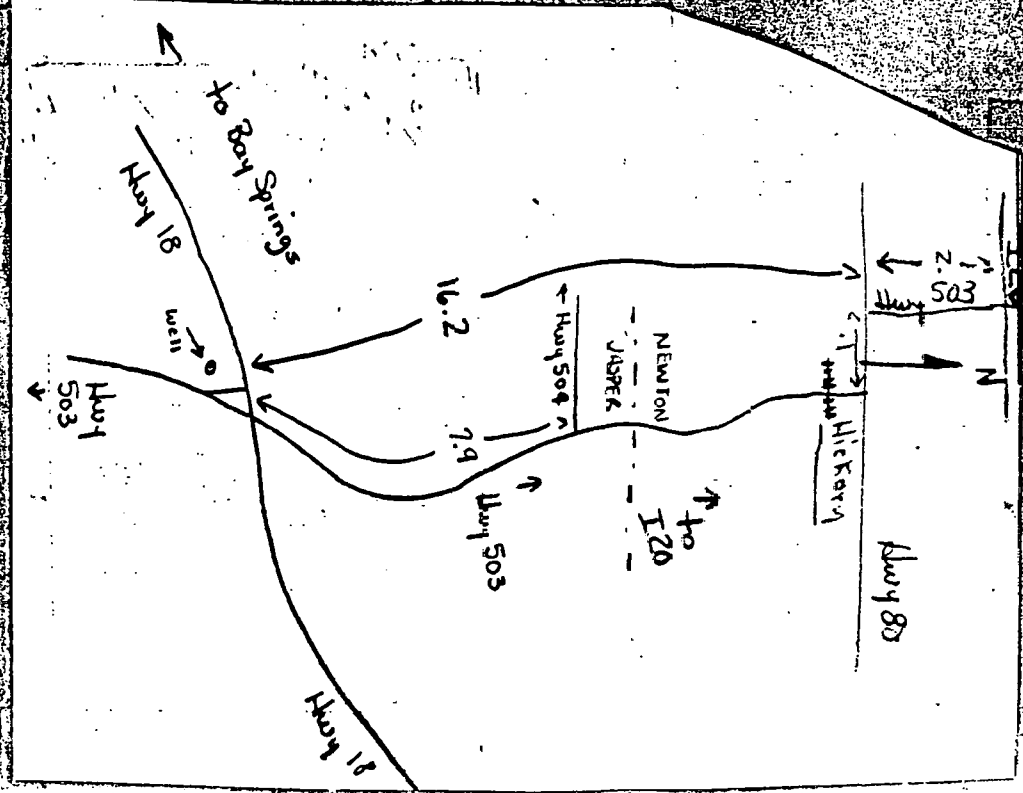

JASPER
 GII
 JASPER
 Log #169
 3

MISSISSIPPI
 BOARD OF WATER COMMISSIONERS
 416 North State Street
 Jackson, Mississippi 39201

CODED

WATER WELL DRILLERS LOG

1974 GRINER DRILLING SERVICE JASPER
 date well completed firm name county well located

LANDOWNER: TALLAHALA
 WATER ASSN. (EXTENTION)
 MISSIONARY UNIT #1
 (mailing address)
 WELL LOCATION: SW/4 SW/4 SE/4
 sec. 10 T. 3 N. R. 12 E
 (distance) miles (direction) of (nearest town)
 WELL PURPOSE:
 (home, irrigation, municipal, industrial)

description of formations encountered	from	to
Top soil	0	3
Red sand w/ clay	3	112
Clay with thin str.	112	328
Sand (poor)	328	392
Clay w/ limestone	392	540
Sandy clay	540	572
Clay + Rocks	572	620
Sand	620	739
Clay + Rocks	739	1018

WELL COMPLETION DATA:
 (1) diameter (inches) 6 5/8"
 (2) total depth (feet) 690'
 (3) static water level (feet) 285 (below/above top of ground)
 (4) casing BI 619' (material) (depth)
 6 7/8" (size) if telescope see back.
 (5) screen 60' 630' (length) (depth to top)
 4" .008 304 S.S. (size) (material)
 (6) pump 20 75 (HP) (yield gpm)
 Elect. (type power)
 (7) electric log Yes (yes or no)
 LISGS (organization running log)
 (8) how well bottom plugged BACK
 WASH VALVE

CODED

DRILLERS REMARKS:

MSDOK
 3/00/7-01
 GW.
 1760

DEPARTMENT OF ENVIRONMENTAL QUALITY - OLWR

PUBLIC SUPPLY WELLS PROJECT

GPS LOG

USER NAME(S): Hotwbeak DATE: 8/9/96
UNIT DEQ #: 82859 FILE #: B080922C
HEALTH DEPT. #: 310017-01 ELEV. _____
USGS #: G11 OLWR #: GW-1760
OWNER: Tallahala W/A - Baxter QUAD: Paulding
LOCATION: SW-SE S 10 T 3 N R 12 E COUNTY: Jasper
LOCATION DESCRIPTION: AT Ground Tank at SW Corner of Intersection
of Hwy 18 + Hwy 503,
CASING DIA: 6" (5.5 mi. North of Paulding) PUMP TYPE & SIZE: Submersible
GPS FIELD LOCATION: LAT. 32° 06' 29.8" LONG. 89° 03' 19.9
GPS CORRECTED LOCATION: LAT. 32.10858026 LONG. 89.05569700
REMARKS: GPS at Well.

