

WELL SCHEDULE

U. S. DEPT. OF THE INTERIOR

GEOLOGICAL SURVEY

WATER RESOURCES DIVISION

PUNCHED AND VERIFIED  
ROLLING DEPARTMENT

MASTER CARD

Record by J. A. Callahan Source of data Mv. Maxie Date 12-15-66 Map         
 State Miss County (or town) Jasper Sequential number: 31  
 Latitude: 32° 04' 16" N Longitude: 089° 15' 32" W  
 Lat-long accuracy: 3' T. 3 S, R. 10 W, Sec 27, SW  $\frac{1}{4}$ , SW  $\frac{1}{4}$ , NE  $\frac{1}{4}$   
 Local well number: E 007 CA 270 3 N 1 O E Other number:         
 Local use:        Owner or name: Town of Louin  
 Owner or name: LOUIN Address: Louin Miss  
 Ownership: County, Fed Gov't (M) City Corp or Co, Private, State Agency, Water Dist M  
 Use of water: Air cond, Bottling, Comm, Dewater, Power, Fire, Dom, Irr, Med, Ind, (P) S Rec, Stock, Instit, Unused, Repressure, Recharge, Desal-P S, Desal-other, Other u  
 Use of well: Anode, Drain, Seismic, Heat Res, Obs, Oil-gas, Recharge, Test, (U) Unused, Withdraw, Waste, Destroyed u  
 DATA AVAILABLE: Well data        Freq. W/L meas.:        Field aquifer char.         
 Hyd. lab. data:         
 Qual. water data; type: MS60N Complete 8-30-61  
 Freq. sampling:        Pumpage inventory:         
 Aperture cards:         
 Log data:       

WELL-DESCRIPTION CARD

SAME AS ON MASTER CARD Depth well: 431 ft Meas. rept 431 accuracy         
 Depth cased; (first perf.) 421 ft Casing type:       ; Diam. 4x2 1/2 in 4  
 Finish: porous concrete, gravel w. (perf.), gravel w. (screen), horiz. open end, perf., (S) screen, sd. pt., shored, open hole, other S  
 Method Drilled: air bored, cable, dug, hyd jetted, air rot., (P) reverse, (T) trenching, driven, drive wash, other         
 Date Drilled: 3/1955 Pump intake setting: 955 ft         
 Driller:        name address         
 Lift (type): air, bucket, cent, jet, multiple, multiple, (N) none, piston, rot, submerg, turb, other N Deep        Shallow 40  
 Power (type): diesel, elec, gas, gasoline, hand, gas, wind; H.P. Trans. or meter no.         
 Descrip. MP        ft above LSD. Alt. MP         
 Alt. LSD:        Accuracy: (source)         
 Water Level:        ft above below MP; Ft below LSD        Accuracy:         
 Date meas:        Yield: 120 gpm 120 Method determined         
 Drawdown:        ft Accuracy:        Pumping period        hrs         
 QUALITY OF WATER DATA: Iron        ppm Sulfate        ppm Chloride        ppm Hard.        ppm  
 Sp. Conduct        K x 10<sup>6</sup> Temp.        °F Date sampled       

Well No.

E7

Well No. E 7

Latitude-longitude 32 04 16 <sup>N</sup> 089 15 32 <sub>S</sub>  
d m s d m s

HYDROGEOLOGIC CARD

**SAME AS ON MASTER CARD** Physiographic Province: 03 Section: \_\_\_\_\_

Drainage Basin: D 1310 Subbasin: \_\_\_\_\_

Topo of well site: (D) depression, stream channel, dunes, flat, hilltop, sink, swamp, (E) offshore, pediment, (S) hillside, terrace, undulating, valley flat \_\_\_\_\_

MAJOR AQUIFER: Tertiary system Eocene series TE Cockfield Carbone aquifer, formation, group \_\_\_\_\_

Lithology: sand Origin: Deltaic \_\_\_\_\_

Length of well open to: \_\_\_\_\_ ft Depth to top of: \_\_\_\_\_ ft

MINOR AQUIFER: \_\_\_\_\_ system \_\_\_\_\_ series \_\_\_\_\_ aquifer, formation, group \_\_\_\_\_

Lithology: \_\_\_\_\_ Origin: \_\_\_\_\_

Length of well open to: \_\_\_\_\_ ft Depth to top of: \_\_\_\_\_ ft

Intervals Screened:

Depth to consolidated rock: \_\_\_\_\_ ft Source of data: \_\_\_\_\_

Depth to basement: \_\_\_\_\_ ft Source of data: \_\_\_\_\_

Surficial material: \_\_\_\_\_ Infiltration characteristics: \_\_\_\_\_

Coefficient Trans: \_\_\_\_\_ gpd/ft Coefficient Storage: \_\_\_\_\_

Coefficient Perm: \_\_\_\_\_ gpd/ft<sup>2</sup>; Spec cap: \_\_\_\_\_ gpm/ft; Number of geologic cards: \_\_\_\_\_

30' of 2 1/2" screen (stainless steel)  
14 + 16 gauge

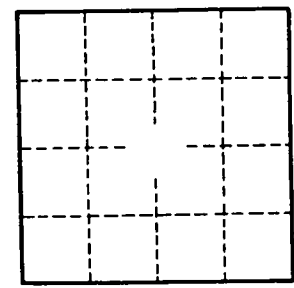
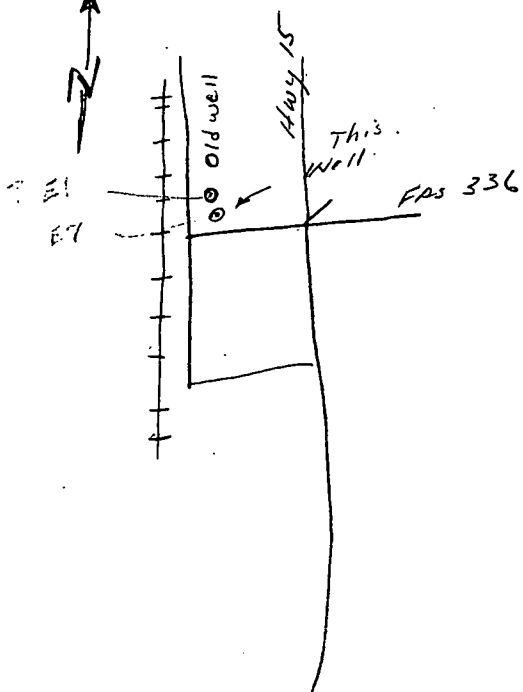

Well No. \_\_\_\_\_

E

M H VASSETT