

### WELL SCHEDULE

U. S. DEPT. OF THE INTERIOR

GEOLOGICAL SURVEY

WATER RESOURCES DIVISION

#### MASTER CARD

Record by J. D. Callahan Source of data Owner Date 5-23-67 Map Highway map

State Miss County 28 Jasper Sequential number: 31

Latitude: 32° 12' 22" 9" N Longitude: 08° 19' 08" 15" W

Local well number: B004A1104N11E Other number: \_\_\_\_\_

Local use: 026 Owner or name: W. P. Tally

Owner or name: W. P. TALLY Address: Garlandsville, Miss

Ownership: County, Fed Gov't, City, Corp or Co, Private, State Agency, Water Dist \_\_\_\_\_

Use of water: (S) (T) (U) (V) (W) (X) (Y) (Z) \_\_\_\_\_

Use of well: (A) (D) (G) (H) (I) (J) (K) (L) (M) (N) (O) (P) (Q) (R) (S) (T) (U) (V) (W) (X) (Y) (Z) \_\_\_\_\_

DATA AVAILABLE: Well data  Freq. W/L meas.:  Field aquifer char.

Hyd. lab. data: \_\_\_\_\_

Qual. water data; type: \_\_\_\_\_

Freq. sampling: \_\_\_\_\_ Pumpage inventory:  yes  no

Aperture cards: \_\_\_\_\_

Log data: \_\_\_\_\_

#### WELL-DESCRIPTION CARD

SAME AS ON MASTER CARD Depth well: 122 ft Meas. 122 ft accuracy \_\_\_\_\_

Depth cased: 112 ft Casing type: steel Diam. 2 1/2 in

Finish: porous concrete, gravel w. (perf.), gravel w. (screen), gravel w. (horiz. gallery), gravel w. (horiz. end), open perf., screen, sd. pt., shored, open hole, other \_\_\_\_\_

Method: (A) (B) (C) (D) (E) (F) (G) (H) (I) (J) (K) (L) (M) (N) (O) (P) (Q) (R) (S) (T) (U) (V) (W) (X) (Y) (Z) \_\_\_\_\_

Date Drilled: 4/3/58 Pump intake setting: 958 ft

Driller: Forest Drilling, Forest Hill

Lift (type): (A) (B) (C) (D) (E) (F) (G) (H) (I) (J) (K) (L) (M) (N) (O) (P) (Q) (R) (S) (T) (U) (V) (W) (X) (Y) (Z) \_\_\_\_\_

Power (type): diesel, elec, gas, gasoline, hand, gas, wind; H.P. 1 Trans. or meter no. 7

Descrip. MP \_\_\_\_\_ ft above \_\_\_\_\_ ft below LSD. Alt. MP \_\_\_\_\_

Alt. LSD: \_\_\_\_\_ Accuracy: \_\_\_\_\_

Water Level: 25 ft above MP; \_\_\_\_\_ ft below LSD Accuracy: \_\_\_\_\_

Date meas: 4/3/58 Yield: 458 gpm Method determined \_\_\_\_\_

Drawdown: \_\_\_\_\_ ft Accuracy: \_\_\_\_\_ Pumping period \_\_\_\_\_ hrs

QUALITY OF WATER DATA: Iron \_\_\_\_\_ Sulfate \_\_\_\_\_ Chloride \_\_\_\_\_ Hard. \_\_\_\_\_

Sp. Conduct \_\_\_\_\_ K x 10<sup>6</sup> Temp. \_\_\_\_\_ °F Date sampled \_\_\_\_\_

Taste, color, etc. \_\_\_\_\_

Well No.

Well No. B4

Latitude-longitude 32 12 29<sup>N</sup> 089 08 15<sup>S</sup>

HYDROGEOLOGIC CARD

SAME AS ON MASTER CARD 19 03 Physiographic Province: Section: 20 21

D Drainage Basin: 13P Subbasin: 22 23 25 26

Topo of well site: (D) depression, stream channel, dunes, flat, hilltop, sink, swamp, (E) (F) (H) (K) (L) (O) offshore, pediment, (S) hillside, (T) terrace, undulating, valley flat (U) (V) 27 S

MAJOR AQUIFER: Tertiary, Eocene TE Cockfield CO system series aquifer, formation, group 28 29 30 31

Lithology: Sand 25 Origin: deltic 3 Aquifer Thickness: ft 32 33 34

Length of well open to: 10 ft 10 Depth to top of: ft 35 37 41 43

MINOR AQUIFER: system series aquifer, formation, group 44 45 46 47

Lithology: Origin: Aquifer Thickness: ft 48 49 50

Length of well open to: ft 51 53 54 56 Depth to top of: ft 57 59

Intervals Screened: 112 - 122

Depth to consolidated rock: ft 60 63 Source of data: 64

Depth to basement: ft 65 68 Source of data: 69

Surficial material: 70 71 Infiltration characteristics: 72

Coefficient Trans: gpd/ft 73 75 Coefficient Storage: 76 78

Coefficient Perm: gpd/ft<sup>2</sup>; Spec cap: gpm/ft; Number of geologic cards: 79

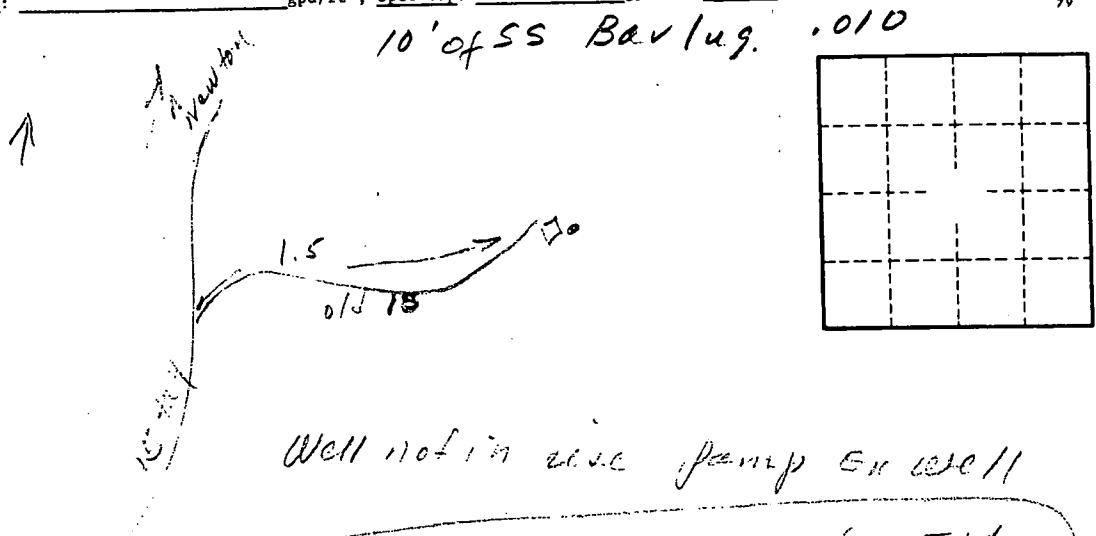

Well not in use pump on well

1 hp 2 stage deep well set. FM  
8 gal tank 500 gph  
122 ft.

Water had excessive amount of iron  
Pump set 60'

Well No.

B4