

Can probably be measured

WRD Exp. (GW)  
April 1966

Well No. Q181

GW01962

WELL SCHEDULE

ST 142

U. S. DEPT. OF THE INTERIOR

GEOLOGICAL SURVEY

WATER RESOURCES DIVISION

PUNCHED and VERIFIED  
ROLLA COMPUTATION BRANCH

MASTER CARD

Record by J.A. Callahan Source of data Barth & Assoc. Date 9-6-66 Map \_\_\_\_\_

State Miss County 28 Jackson (or town) 30

Latitude: 30 21 28 N Longitude: 08 8 31 31 Sequential number: 1

Lat-long accuracy: 20 T. 8 R. 5 Sec 30 18' \_\_\_\_\_

Local well number: Q181 AD3008505U Other number: Q181 #2

Local use: 009 Owner or name: FORMLY Jackson Co. Board of Supervisors Address: Bayou Casotte

Owner or name: PASCAGOULA Address: \_\_\_\_\_

Ownership:  (C) County,  (F) Fed Gov't,  (M) City, Corp or Co, Private,  (N) State Agency,  (P) Water Dist,  (S) \_\_\_\_\_

Use of water:  (A) Air cond,  (B) Bottling,  (C) Comm,  (D) Dewater,  (E) Power,  (F) Fire,  (H) Dom,  (I) Irr,  (M) Med,  (N) Ind,  (P) S, Rec,  (R) \_\_\_\_\_

Use of well:  (A) Anode,  (D) Drain,  (G) Seismic,  (H) Heat Res,  (O) Obs,  (P) Oil-gas,  (R) Recharge,  (T) Test,  (U) Unused,  (W) Withdraw,  (X) Waste,  (Z) Destroyed

DATA AVAILABLE: Well data  70 Freq. W/L meas.: \_\_\_\_\_  71 Field aquifer char. \_\_\_\_\_ 72

Hyd. lab. data: \_\_\_\_\_ 73

Qual. water data; type: \_\_\_\_\_ 74

Freq. sampling: \_\_\_\_\_  75 Pumpage inventory: yes \_\_\_\_\_ no: period: \_\_\_\_\_ 76

Aperture cards: \_\_\_\_\_ yes 77

Log data: \_\_\_\_\_ 78 79

7/1187  
BRR  
T = 28°C  
PI = 8.58  
COND = 1500

WELL-DESCRIPTION CARD

SAME AS ON MASTER CARD Depth well: 682 ft 682 Meas. accuracy 6

Depth cased; (first perf.) 632 ft 632 Casing type: steel; Diam. 10 in 10

Finish: porous concrete, gravel w. screen, gravel w. screen, horiz. gallery, open end, perf., screen, sd. pt., shored, open hole, other \_\_\_\_\_

Method: (A) air bored, (B) cable, (C) dug, (D) hyd rot, (H) percussion, (J) rotary, (P) air reverse, (R) trenching, (T) driven, (V) drive wash, (W) other \_\_\_\_\_

Date Drilled: Feb 65 965 Pump intake setting: \_\_\_\_\_ ft \_\_\_\_\_

Driller: Carlos Well Supply Co, Memphis Tenn

Lift (type): (A) air, (B) bucket, (C) cent, (J) jet, (L) multiple, (M) multiple, (N) none, (P) piston, (R) rot, (S) submerg, (T) turb, other \_\_\_\_\_ Deep \_\_\_\_\_ Shallow \_\_\_\_\_

Power (type): diesel,  elec, gas, gasoline, hand, gas, wind, H.P. \_\_\_\_\_ Trans. or meter no. \_\_\_\_\_

Descrip. MP 12 ft above LSD. Alt. MP \_\_\_\_\_

Alt. LSD: 10 Accuracy: (source) Court. I. 10 3

Water Level 59 ft above MP; Ft below LSD 59 Accuracy: Drillers 0

Date meas: 10-6-65 065 Yield: 375 gpm 200 Method determined

Drawdown: 50 ft 50 Accuracy: \_\_\_\_\_ Pumping period \_\_\_\_\_ hrs \_\_\_\_\_

QUALITY OF WATER DATA: Iron \_\_\_\_\_ Sulfate \_\_\_\_\_ Chloride \_\_\_\_\_ Hard. \_\_\_\_\_

Sp. Conduct \_\_\_\_\_ K x 10<sup>6</sup> \_\_\_\_\_ Temp. \_\_\_\_\_ °F \_\_\_\_\_ Date sampled \_\_\_\_\_

Taste, color, etc. \_\_\_\_\_

Well No.

Q181

Well No. Q181

Latitude-longitude 50 21 28 088 31 31  
d m s d m s

HYDROGEOLOGIC CARD

SAME AS ON MASTER CARD Physiographic Province: 03 Section: \_\_\_\_\_

D Drainage Basin: 130 Subbasin: \_\_\_\_\_

Topo of well site: (D) depression, stream channel, dunes, flat, hilltop, sink, swamp, (P) offshore, pediment, hillside, (T) terrace, (U) undulating, valley flat 7

MAJOR AQUIFER: Tertiary, Miocene T.M. Pascagoula P.A.  
system series aquifer, formation, group

Lithology: Sand S Origin: Deltaic 3 Aquifer Thickness: \_\_\_\_\_ ft

Length of well open to: \_\_\_\_\_ ft 50 Depth to top of: \_\_\_\_\_ ft \_\_\_\_\_

MINOR AQUIFER: \_\_\_\_\_ 45 45 632 632

Intervals Screened: \_\_\_\_\_

Depth to consolidated rock: \_\_\_\_\_ ft \_\_\_\_\_ Source of data: \_\_\_\_\_

Depth to basement: \_\_\_\_\_ ft \_\_\_\_\_ Source of data: \_\_\_\_\_

Surficial material: \_\_\_\_\_ Infiltration characteristics: \_\_\_\_\_

Coefficient Trans: \_\_\_\_\_ gpd/ft \_\_\_\_\_ Coefficient Storage: \_\_\_\_\_

Coefficient Perm: \_\_\_\_\_ gpd/ft<sup>2</sup>; Spec cap: \_\_\_\_\_ gpm/ft; Number of geologic cards: \_\_\_\_\_

Well loc in <sup>1/4</sup> Sec 30 150' East of 27<sup>th</sup> St on Douglas. T8S 5W

Well & Pump Data via file

Depth	Material
15	Sp Soil
30	Lt Blue Shale
40	nd
45	nd + Blue Shale
50	ge
60	idy Shale
70	nd
100	nd + Shale
215	nd (65' coarse)
470	nd Blue Shale
475	nd Sand Vack
490	nd Blue Shale
623	nd Shale - gray
633	nd y Shale
678	nd Peering Sand

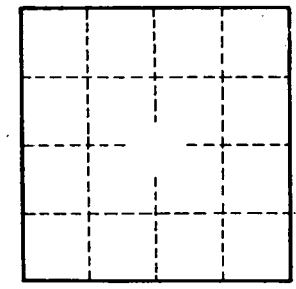
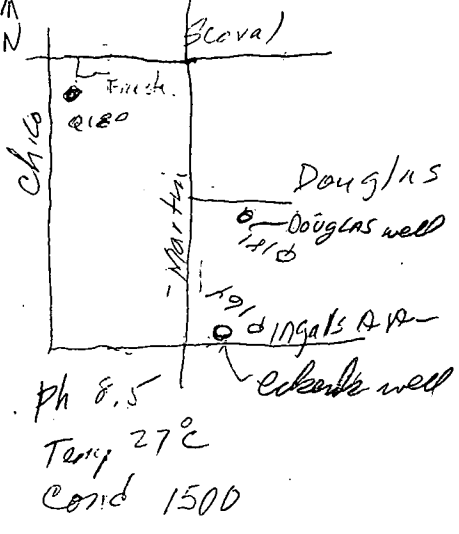

Well No. Q181

