

PUNCHED and VERIFIED  
ROLLA COMPUTATION BRANCH

WRD Exp. (GW)  
April 1966

Well No. Q36

### WELL SCHEDULE

U. S. DEPT. OF THE INTERIOR      GEOLOGICAL SURVEY      WATER RESOURCES DIVISION

#### MASTER CARD

Record by T.N. SHOWS Source of data DRILLER Date 8-18-60 Map \_\_\_\_\_

State 28 County (or town) JACKSON 30

Latitude: 30<sup>deg</sup> 25<sup>min</sup> 23<sup>sec</sup> N Longitude: 08<sup>deg</sup> 82<sup>min</sup> 71<sup>sec</sup> W Sequential number: 1

Lat-long accuracy: 3<sup>70</sup> T. 7<sup>S</sup> R. 5<sup>W</sup> Sec 23 SE 1/4, SE 1/4, NW 1/4 B & M

Local well number: Q036DD2307S05W Other well number: \_\_\_\_\_

Local use: 000 Owner or name: \_\_\_\_\_

Owner or name: MISS ST SCALES Address: ORANGE GROVE, MISS

Ownership: (C) County, Fed Gov't, (F) City, Corp or Co, (M) Private, (N) State Agency, (P) Water Dist, (S) \_\_\_\_\_ 67 5

Use of water: (A) Air cond, (B) Bottling, (C) Comm, (D) Dewater, (E) Power, (F) Fire, (H) Dom, (I) Irr, (M) Med, (N) Ind, (P) S, (R) Rec, (S) Stock, (T) Instit, (U) Unused, (V) Reppure, (W) Recharge, (X) Desal-P S, (Y) Desal-other, (Z) Other \_\_\_\_\_ 68 H

Use of well: (A) Anode, (D) Drain, (G) Seismic, (H) Heat Res, (O) Obs, (P) Oil-gas, (R) Recharge, (T) Test, (U) Unused, (W) Withdraw, (X) Waste, (Z) Destroyed \_\_\_\_\_ 69 W

DATA AVAILABLE: Well data  Freq. W/L meas.:  Field aquifer char.  \_\_\_\_\_ 70 71 72

Hyd. lab. data: \_\_\_\_\_ 73

Qual. water data; type: USGS 5-6-62 \_\_\_\_\_ 74 P

Freq. sampling: \_\_\_\_\_ Pumpage inventory:  yes,  no, period: \_\_\_\_\_ 75 76

Aperture cards: \_\_\_\_\_ yes \_\_\_\_\_ 77

Log data: \_\_\_\_\_ 78 79

#### WELL-DESCRIPTION CARD

SAME AS ON MASTER CARD Depth well: \_\_\_\_\_ ft 221 Meas. accuracy \_\_\_\_\_ 24 6

Depth cased: (first perf.) \_\_\_\_\_ ft 211 Casing type: steel; Diam. \_\_\_\_\_ in \_\_\_\_\_ 25 26 27 28 29 30

Finish: (C) porous concrete, (F) gravel w. (perf.), (G) gravel w. (screen), (H) horiz. gallery, (O) open end, (P) perf., (S) screen, (T) sd. pt., (W) shored, (X) open hole, (Z) other \_\_\_\_\_ 31 5

Method Drilled: (A) air rot, (B) bored, (C) cable, (D) dug, (H) hyd rot., (J) jetted, (P) air percussion, (R) reverse, (T) trenching, (V) driven, (W) drive wash, (Z) other \_\_\_\_\_ 32 H

Date Drilled: 8-17-60 9:60 Pump intake setting: \_\_\_\_\_ ft \_\_\_\_\_ 33 34 35 36 37 38

Driller: John Colville, Moss Point, Miss. \_\_\_\_\_ 39

Lift (type): (A) air, (B) bucket, (C) cent., (J) jet, (L) multiple, (M) multiple, (N) none, (P) piston, (R) rot., (S) submerg, (T) turb., (U) other \_\_\_\_\_ 40 J Deep \_\_\_\_\_ Shallow \_\_\_\_\_

Power (type): (nat) diesel, elec, gas, gasoline, hand, gas, wind; (LP) H.P. \_\_\_\_\_ 41 5 Trans. or meter no. \_\_\_\_\_

Descrip. MP \_\_\_\_\_ ft above LSD, Alt. MP \_\_\_\_\_ 42

Alt. LSD: \_\_\_\_\_ Accuracy: (source) \_\_\_\_\_ 43 10 47 4

Water Level 19.40 ft above below MP; Ft below LSD 19 Accuracy: \_\_\_\_\_ 48 49 50 51 A

Date meas: 8-18-60 8:60 Yield: 5 gpm \_\_\_\_\_ 52 53 54 55 56 57 58 59 0 Method determined \_\_\_\_\_

Drawdown: \_\_\_\_\_ ft \_\_\_\_\_ Accuracy: \_\_\_\_\_ Pumping period: \_\_\_\_\_ hrs \_\_\_\_\_ 60 61 62 63 64 65 66 67 68

QUALITY OF WATER DATA: Iron \_\_\_\_\_ ppm \_\_\_\_\_ Sulfate \_\_\_\_\_ ppm \_\_\_\_\_ Chloride \_\_\_\_\_ ppm \_\_\_\_\_ Hard. \_\_\_\_\_ ppm \_\_\_\_\_ 69 70 71 72

Sp. Conduct \_\_\_\_\_ K x 10<sup>6</sup> \_\_\_\_\_ Temp. \_\_\_\_\_ °F \_\_\_\_\_ Date sampled \_\_\_\_\_ 73 74 75 76 77 79

Taste, color, etc. \_\_\_\_\_ 80

Well No. Q36

Well No. 036

Latitude-longitude N  
S  
d m s d m s

HYDROGEOLOGIC CARD

SAME AS ON MASTER CARD 03 Section: 03  
Physiographic Province: 03

D Drainage Basin: 130 Subbasin: 26

(D) (C) (E) (F) (M) (K) (L)  
Topo of well site: depression, stream channel, dunes, flat, hilltop, sink, swamp,  
(O) (P) (S) (T) (U) (V)  
offshore, pediment, hillside, terrace, undulating, valley flat 27

MAJOR AQUIFER: TP aquifer, formation, group GF

Lithology: US Origin: 3 Aquifer Thickness: 3 ft

Length of well open to: 10 ft Depth to top of: 41 ft

MINOR AQUIFER:    aquifer, formation, group   

Lithology:    Origin:    Aquifer Thickness:    ft

Length of well open to:    ft Depth to top of:    ft

Intervals Screened:   

Depth to consolidated rock:    ft Source of data:   

Depth to basement:    ft Source of data:   

Surficial material:    Infiltration characteristics:   

Coefficient Trans:    gpd/ft Coefficient Storage:   

Coefficient Perm:    gpd/ft<sup>2</sup>; Spec cap:    gpm/ft; Number of geologic cards:   

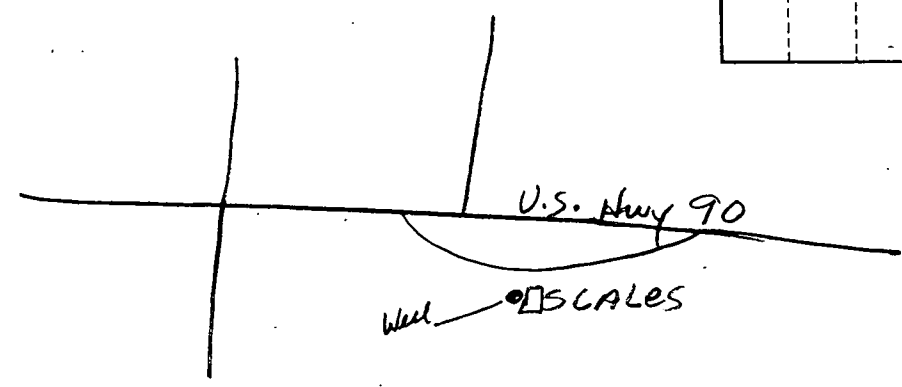
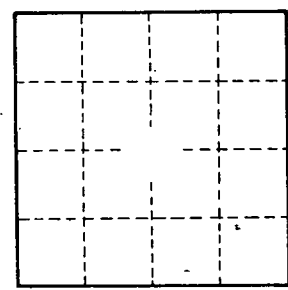

Well No.

036