

PUNCHED and VERIFIED
ROLLA COMPUTATION BRANCH

WRD Exp. (GW) SITE ID 50262508831101 Well No. 416
April 1966

WELL SCHEDULE

U. S. DEPT. OF THE INTERIOR GEOLOGICAL SURVEY WATER RESOURCES DIVISION

MASTER CARD

Record by EHB Source of data DR Date _____ Map Pascoula Quad

State 623 28 County (or town) JACKSON 310

Latitude: 30 deg 25 min 55 sec N Longitude: 088 deg 37 min 58 sec W Sequential number: 2

Lat-long accuracy: 2 T. 7 S. R. 5 E. Sec. 18 NE NE SE SW SW B & H

Local well number: 0016AA1907505W Other number: _____

Local use: 024 Owner or name: _____

Owner or name: THIOKOL CHEM Address: _____

Ownership: County, Fed Gov't, City, Corp or Co, Private, State Agency, Water Dist N

Use of water: (A) Air cond, (B) Bottling, (C) Comm, (D) Dewater, (E) Power, (F) Fire, (H) Dom, (I) Irr, (M) P S, (N) Rec, (P) Stock, (T) Instit, (U) Unused, (V) Recharge, (W) Recharge, (X) Desal-P S, (Z) Desal-other. Other NH

Use of well: (A) Anode, (D) Drain, (G) Seismic, (H) Heat Res, (P) Obs, (R) Oil-gas, (T) Recharge, (U) Test, (W) Unused, (X) Withdraw, (Z) Waste, Destroyed W 02

DATA AVAILABLE: Well data Freq. W/L meas.: Field aquifer char.

Hyd. lab. data: WELL CEMENTED - 9/29/89

Qual. water data; type: USGS

Freq. sampling: Pumpage inventory: yes no period: _____

Aperture cards: yes no

Log data: _____

WELL-DESCRIPTION CARD

SAME AS ON MASTER CARD Depth well: _____ ft 967 Meas. 3

Depth cased: (first perf.) _____ ft 907 Casing Type: _____; Diam. 8 in 8

Finish: (C) porous concrete, (F) gravel w. (perf.), (G) gravel w. (screen), (H) horiz. gallery, (P) open end, (S) perf., (T) screen, (W) sd. pt., (X) shored, (Z) open hole. other S

Method Drilled: (A) air rot, (B) bored, (C) cable, (D) dug, (H) hyd rot., (J) jetted, (P) percussion, (R) rotary, (T) reverse, (V) trenching, (W) driven, (Z) drive wash, other H

Date Drilled: 952 Pump intake setting: _____ ft 100

Driller: SUTTER name address

Lift (type): (A) air, (B) bucket, (C) cent, (J) jet, (L) multiple, (M) multiple, (N) none, (P) piston, (R) rot, (S) submerg, (T) turb, other 7 Deep Shallow

Power (type): nat diesel, elec, gas, gasoline, hand, gas, wind; H,P. 20 or 25 LP Trans. or meter no. _____

Descrip. MP _____ ft above LSD. Alt. MP _____

Alt. LSD: _____ ft below LSD. Accuracy: (source) 7 4

Water Level: _____ ft above MP; _____ ft below LSD +18 Accuracy: _____ G

Date meag: 752 Yield: _____ gpm 300 Method determined _____

Drawdown: _____ ft Accuracy: _____ Pumping period: _____ hrs _____

QUALITY OF WATER DATA: Iron _____ ppm Sulfate _____ ppm Chloride 360 Hard. 4

Sp. Conduct 2000 K x 10⁶ 5 Temp. °F 28.0 Date sampled _____ 674

Taste, color, etc. Ph 8.4

Well No. 916

Latitude-longitude _____
N
S
d m s d m s

HYDROGEOLOGIC CARD

SAME AS ON MASTER CARD Physiographic Province: _____ Section: 03

Drainage Basin: D Subbasin: 13

Topo of well site: (D) depression, stream channel, dunes, flat, hilltop, sink, swamp, (K) (L) (P) (S) (T) (U) (V) offshore, pediment, hillside, terrace, undulating, valley flat

MAJOR AQUIFER: system _____ series TM aquifer, formation, group PA

Lithology: US Origin: 3 Aquifer Thickness: _____ ft

Length of well open to: _____ ft Depth to top of: 899 ft

MINOR AQUIFER: system _____ series _____ aquifer, formation, group _____

Lithology: _____ Origin: _____ Aquifer Thickness: _____ ft

Length of well open to: _____ ft Depth to top of: _____ ft

Intervals Screened:

Depth to consolidated rock: _____ ft Source of data: _____

Depth to basement: _____ ft Source of data: _____

Surficial material: _____ Infiltration characteristics: _____

Coefficient Trans: _____ gpd/ft Coefficient Storage: _____

Coefficient Perm: _____ gpd/ft; Spec cap: _____ gpm/ft; Number of geologic cards: _____

16
9
9
9
5
5
6
5
4
4
6
5
5
5

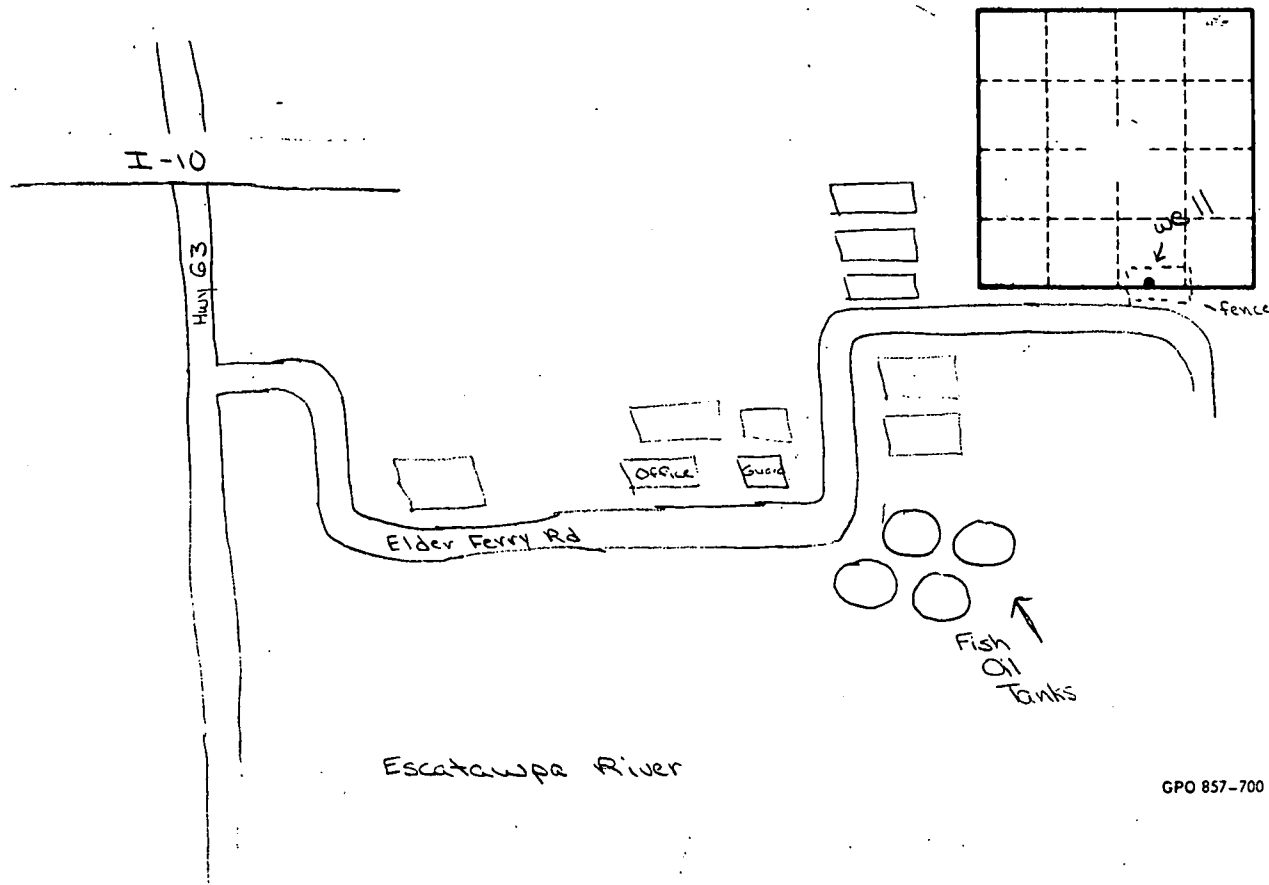

MISSISSIPPI DEPARTMENT OF NATURAL RESOURCES
Bureau of Land and Water Resources

P. O. Box 10631
Jackson, Mississippi 39209
WATER WELL PLUGGING
DECOMMISSIONING

COUNTY WELL LOCATED Jackson		PERMIT NUMBER	
WELL NUMBER #710-16	CODED	NAME OF DRILLING FIRM	
Q 16			
DATE WELL PLUGGED 09-29-89			
NAME & MAILING ADDRESS OF LANDOWNER Morton International, Inc.		NAME OF WELL CONTRACTOR WHO DRILLED THE WELL Sutter Well Works	
P. O. Box 666			
Moss Point, MS 39563		NAME OF LANDOWNER WHEN WELL WAS DRILLED Thiokol Corporation	
WELL LOCATION NE¹/₄ of NE¹/₄ 19	SEC 075	TOWNSHIP 05W	RANGE 05W
DISTANCE	DIRECTION	NEAREST TOWN. Moss Point	
OTHER LANDMARK 1/4 mi east of Dynachem.			
WELL PURPOSE: Home, Irrigation, Municipal, Industrial, Fish Pond, etc.			
WELL DATA		DATE WELL COMPLETED July 1952	
Well Depth 967'	Casing Diameter (In.) 8"	Casing Length (Ft.) 100-967'	
Type of Casing C/S	Hole Depth 967'	Depth to Static Water Level 2'1"	

DESCRIBE HOW THE WELL OR HOLE WAS PLUGGED:
(AMOUNT OF CASING AND/OR SCREEN THAT WAS REMOVED, OR LEFT IN HOLE,
MATERIAL USED IN PLUGGING, ETC.)

Attempt to pull pump assy. & could not. Washed over pump
assy. to ± 70. Spear & pull pump assy. attempt to run 2 7/8"
pipe in hole. Tagged at ± 70'. Attempt to remove obstruction &
could not. Mixed & pumped 165 sack (195 cuft.) of Class A neat
into well from 70'. Let set 4hrs. Circulate Class A cement plug
from 70' to surface. Weld plate on casing.

I CERTIFY THAT THE WELL WAS PLUGGED OR ABANDONED IN ACCORDANCE WITH THE STATE OF MISSISSIPPI REGULATIONS.

Jerry D Mark
SIGNATURE

10/4/89
DATE

Updated 2-28-92 *jjj*