

302-1010 088 3115
✓

FORM 9-1642
(1-68)

PUNCHED
MAR 17 1975

Well No. P349

WELL SCHEDULE

E-109# 198

U. S. DEPT. OF THE INTERIOR

GEOLOGICAL SURVEY

WATER RESOURCES DIVISION

PUNCHED
MAY 8 1973

MASTER CARD

Record by L.A. Callahan Source of data obs. owner Date 12/30/71 Map

State 28 County (or town) JACKSON 30

Latitude: 30⁵ 02⁷ 10¹¹ 1¹⁹ N Longitude: 08¹² 8¹⁵ 34¹⁹ 15¹⁹ Sequential number: 1

Lat-long accuracy: 3²⁰ T. 8²⁰ N. 8²⁰ S. 6²⁰ R. 6²⁰ E. 8²⁰ Sec 8

Local well number: P349 0808306W Other well number: Well #3

Local use: 672 82 Owner or name: Ingalls Shipyard

Owner or name: INGALLS SHIPYARD Address: West Rank, Jack. Tenn.

Ownership: County, Fed Gov't, City, Corp or Co, Private, State Agency, Water Dist: N

Use of water: (A) Air cond, (B) Bottling, (C) Comm, (D) Dewater, (E) Power, (F) Fire, (G) Dom, (H) Irr, (I) Med, (J) Ind, (K) P S, (L) Rec, (M) Stock, (N) Insatit, (O) Unused, (P) Repressure, (Q) Recharge, (R) Desal-P S, (S) Desal-other, (T) Other: N

Use of well: (A) Anode, (B) Drain, (C) Seismic, (D) Heat Res, (E) Obs, (F) Oil-gas, (G) Recharge, (H) Test, (I) Unused, (J) Withdraw, (K) Waste, (L) Destroyed: W

DATA AVAILABLE: Well data Freq. W/L meas: Field aquifer char:

Hyd. lab. data:

Qual. water data; type: USGS

Freq. sampling: Pumpage inventory: yes no, period:

Aperture cards: yes

Log data: Sch.

WELL-DESCRIPTION CARD

SAME AS ON MASTER CARD Depth well: 782 ft Meas. rept accuracy: 3

Depth cased: (first perf.) 722 ft Casing type: 8 1/2 in

Finish: (C) concrete, (F) porous gravel w. (perf.), (G) gravel w. (screen), (H) horiz. open gallery, (I) end, (J) other, (K) perf., (L) screen, (M) sd. pt., (N) shored, (O) open hole, (P) other: G

Method: (A) air, (B) bored, (C) cable, (D) dug, (E) hyd, (F) jetted, (G) air, (H) reverse, (I) trenching, (J) driven, (K) drive, (L) rot., (M) percussive, (N) rotary, (O) wash, (P) other: H

Date Drilled: 972 Pump intake setting: 36 ft

Driller: MORRISON address: L.A.

Lift (type): (A) air, (B) bucket, (C) cent, (D) jet, (E) multiple, (F) multiple, (G) none, (H) piston, (I) rot, (J) submerg, (K) turb, (L) other: 7 Deep Shallow

Power (type): (A) diesel, (B) elec, (C) gas, (D) gasoline, (E) hand, (F) gas, (G) wind, (H) H.P.: 50 Trans. or meter no. 41

Descrip. MP 10 ft above below LSD, Alt. MP 4

Alt. LSD: 10 Accuracy: (source) 4

Water Level: 87 ft above below MP; Ft above below LSD Accuracy: 0

Date meas: 672 Yield: 0 #psi gpm 670 Method determined: 4

Drawdown: 73 ft 74 Accuracy: 24 hrs

QUALITY OF WATER DATA: Iron 5 ppm Sulfate 260 ppm Chloride 473 ppm Hard. 72

Sp. Conduct 1600 K x 10 5 Temp. 26 °F 260 Date sampled 4/25 473

Taste, color, etc. ph 8.2 Amber color

7/7/83
T=28.0
L=2000
r=1.6
DL=12.01

Well No. P349

Latitude-longitude N
S
d m s d m s

HYDROGEOLOGIC CARD

SAME AS ON MASTER CARD Physiographic Province: 03 Section: _____

130 Subbasin: _____

Topo of well site: (D) YAM (C) (E) (F) (H) (K) (L) (O) (P) (S) (T) (U) (V) _____

MAJOR AQUIFER: system _____ series TM aquifer, formation, group MZ

Lithology: _____ Origin: 3 Aquifer Thickness: _____ ft

80 Length of well open to: _____ ft 60 Depth to top of: _____ ft 71.9

MINOR AQUIFER: system _____ series _____ aquifer, formation, group _____

Lithology: _____ Origin: _____ Aquifer Thickness: _____ ft

 Length of well open to: _____ ft Depth to top of: _____ ft

Intervals Screened: _____

Depth to consolidated rock: _____ ft _____ Source of data: _____

Depth to basement: _____ ft _____ Source of data: _____

Surficial material: _____ Infiltration characteristics: _____

Coefficient Trans: 39,000 gpd/ft 393 Coefficient Storage: _____

Coefficient Perm: 490 gpd/ft²; Spec cap: 8.2 gpm/ft; Number of geologic cards: _____

Well located about 25' N Westly from P293.

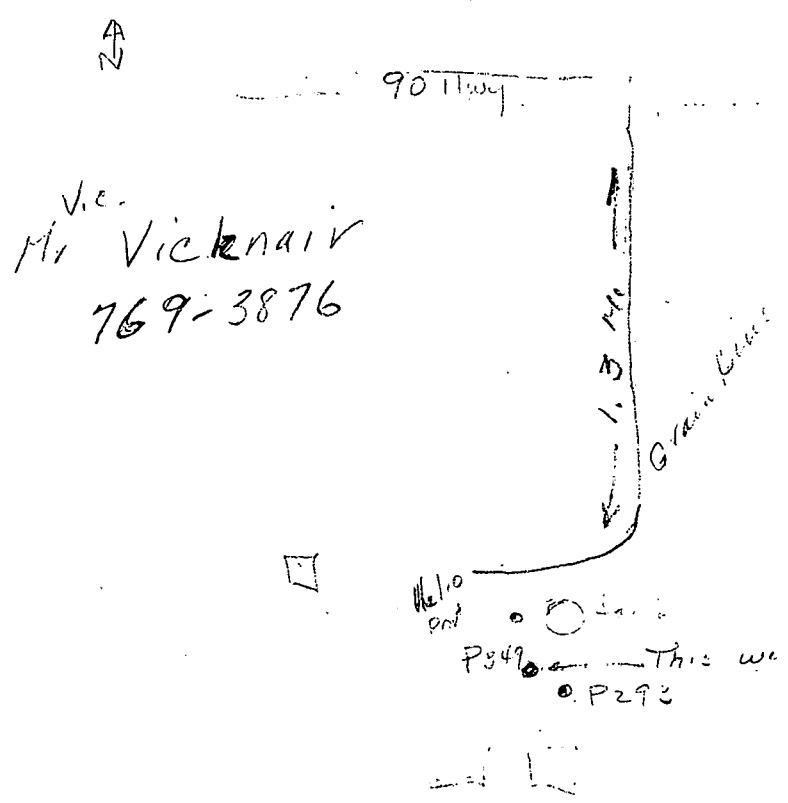

H = 80.00
 L = 3.57
 76.43
 MP = 2.23
 74.20

T = 28°C
 PH = 8.8
 COND = 1600

Well No. P349