

PUNCHED and VERIFIED  
ROLLA COMPUTATION BRANCH

GW7208

Well No. P 218

WRD Exp. (GW)  
April 1966

WELL SCHEDULE

U. S. DEPT. OF THE INTERIOR

GEOLOGICAL SURVEY

WATER RESOURCES DIVISION

Z3=Z\*Z4=\*

MASTER CARD

Record by J. HARRELL Source of data BOWC Date 4/16/68 Map

State 28 County (or town) JACKSON 30

Latitude: 30 22 25 N Longitude: 08 83 70 7 Sequential number: 2

Lat-long accuracy: 4 T. 80 R. 6 Sec 9, SW SW

Local well number: P218CC0908506W Other number: B & M

Local use: 024 Owner or name: Gautier Utility

Owner or name: SEASHORE UTIL Address: Box 8127 JACKSON, MISS District

Ownership: County, Fed Gov't, City, Corp or Co, Private, State Agency, Water Dist M

Use of water: (A) Air cond, Bottling, Comm, Dewater, Power, Fire, Dom, Irr, Med, Ind, P S, Rec, (S) Stock, Instit, Unused, Repressure, Recharge, Desal-P S, Desal-other, Other R

Use of well: (A) Anode, Drain, Seismic, Heat Res, Obs, Oil-gas, Recharge, Test, Unused, Withdraw, Waste, Destroyed W Z

DATA AVAILABLE: Well data 0 Freq. W/L meas.: 0 Field aquifer char. 0

Hyd. lab. data: 0

Qual. water data; type: 0

Freq. sampling: 0 Pumpage inventory: 0 yes no, period: 0

Aperture cards: 0

Log data: D

WELL-DESCRIPTION CARD

SAME AS ON MASTER CARD Depth well: 840 ft 840 Meas. 3

Depth cased; (first perf.): 800 ft 800 Casing type: 0; Diam. 6x4 in 6

Finish: (C) porous concrete, (F) gravel w. concrete, (G) gravel w. (perf.), (H) gravel w. (screen), (I) horiz. gallery, (J) open end, (K) open hole, (L) other, (M) perf., (N) screen, (O) sd. pt., (P) shored, (Q) open hole, (R) other, (S) other, (T) other, (U) other, (V) other, (W) other, (X) other, (Y) other, (Z) other S

Method Drilled: (A) air rot, (B) bored, (C) cable, (D) dug, (E) hyd rot., (F) jetted, (G) air rot., (H) percussion, (I) rotary, (J) air reverse, (K) air reverse, (L) air reverse, (M) air reverse, (N) air reverse, (O) air reverse, (P) air reverse, (Q) air reverse, (R) air reverse, (S) air reverse, (T) air reverse, (U) air reverse, (V) air reverse, (W) air reverse, (X) air reverse, (Y) air reverse, (Z) air reverse H

Date Drilled: 3/5/64 964 Pump intake setting: 0 ft 0

Driller: Sutton Well Works name address

Lift (type): (A) air, (B) bucket, (C) cent, (D) jet, (E) multiple, (F) multiple, (G) multiple, (H) multiple, (I) multiple, (J) multiple, (K) multiple, (L) multiple, (M) multiple, (N) multiple, (O) multiple, (P) multiple, (Q) multiple, (R) multiple, (S) multiple, (T) multiple, (U) multiple, (V) multiple, (W) multiple, (X) multiple, (Y) multiple, (Z) multiple T Deep 0 Shallow 40

Power (type): (A) diesel, (B) elec, (C) gas, (D) gasoline, (E) hand, (F) gas, (G) wind, (H) H.P., (I) H.P., (J) H.P., (K) H.P., (L) H.P., (M) H.P., (N) H.P., (O) H.P., (P) H.P., (Q) H.P., (R) H.P., (S) H.P., (T) H.P., (U) H.P., (V) H.P., (W) H.P., (X) H.P., (Y) H.P., (Z) H.P. 5 U Trans. or meter no. 0

Descrip. MP 0 ft above below LSD, Alt. MP 0

Alt. LSD: 0 Accuracy: (source) 4

Water Level: +9 ft above below MP; Ft +9 LSD +9 Accuracy: 0

Date meas: 3/5/64 369 Yield: @ 50psi gpm 60 Method determined 0

Drawdown: 0 ft 0 Accuracy: 0 Pumping period 0 hrs 0

QUALITY OF WATER DATA: Iron ppm 0 Sulfate ppm 0 Chloride ppm 0 Hard. ppm 0

Sp. Conduct 0 K x 10<sup>6</sup> Temp. 0 °F 0 Date sampled 0

Taste, color, etc. 0

MP = .80  
11/7/85  
WL = 18.33

Well No. P 218

Latitude-longitude \_\_\_\_\_  
d m s d m s

HYDROGEOLOGIC CARD

Physiographic Province: 03 Section: \_\_\_\_\_

Drainage Basin: D Subbasin: 13S \_\_\_\_\_

Topo of well site: (D) depression, stream channel, dunes, flat, hilltop, sink, swamp, (C) (E) (F) (H) (K) (L) (O) (P) (S) (T) (U) (V) offshore, pediment, hillside, terrace, undulating, valley flat \_\_\_\_\_

MAJOR AQUIFER: system \_\_\_\_\_ series TM \_\_\_\_\_ aquifer, formation, group PA \_\_\_\_\_

Lithology: \_\_\_\_\_ Origin: 3 \_\_\_\_\_ Aquifer Thickness: \_\_\_\_\_ ft

Length of well open to: \_\_\_\_\_ ft 40 \_\_\_\_\_ Depth to top of: \_\_\_\_\_ ft \_\_\_\_\_

MINOR AQUIFER: system \_\_\_\_\_ series \_\_\_\_\_ \_\_\_\_\_ aquifer, formation, group \_\_\_\_\_

Lithology: \_\_\_\_\_ Origin: \_\_\_\_\_ \_\_\_\_\_ Aquifer Thickness: \_\_\_\_\_ ft

Length of well open to: \_\_\_\_\_ ft \_\_\_\_\_ Depth to top of: \_\_\_\_\_ ft \_\_\_\_\_

Intervals Screened: \_\_\_\_\_ 4" \_\_\_\_\_

Depth to consolidated rock: \_\_\_\_\_ ft \_\_\_\_\_ Source of data: \_\_\_\_\_

Depth to basement: \_\_\_\_\_ ft \_\_\_\_\_ Source of data: \_\_\_\_\_

Surficial material: \_\_\_\_\_ Infiltration characteristics: \_\_\_\_\_

Coefficient Trans: \_\_\_\_\_ gpd/ft \_\_\_\_\_ Coefficient Storage: \_\_\_\_\_

Coefficient Perm: \_\_\_\_\_ gpd/ft<sup>2</sup>; Spec cap: \_\_\_\_\_ gpm/ft; Number of geologic cards: \_\_\_\_\_

IN GAUTIER

105' of 6" casg, rest 4"  
40' of 4" SS 12 ga. screen

10-26-82

H.c.I.Q.	33.00
Cut	13.24
	19.76
M.P.	.80
W.L.	18.96

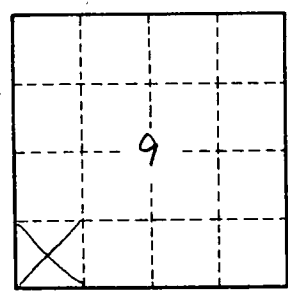

10-26-82

One well destroyed (covered w/ cement)

Second well (4" PVC casg - submersible pump)

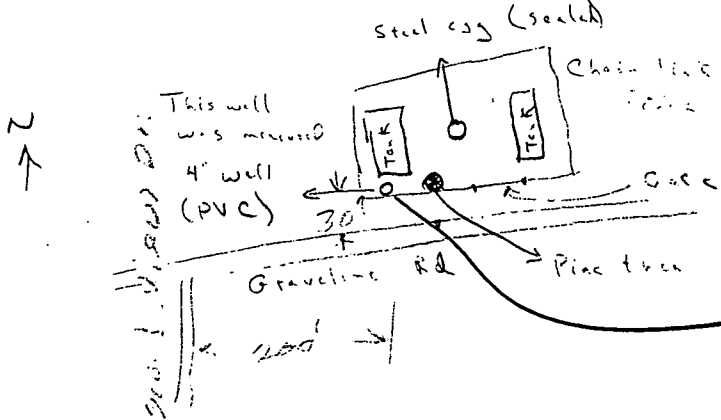

4" plastic pipe GPO 857-700  
 may be flowing small amount  
 of water could be measured  
 with plug + hose - 2/11/92  
 PEG

Well No. \_\_\_\_\_

P 218