

PUNCHED and VERIFIED
ROLLA CAMPBELL

E log # 157

GW01955

P150

WRD Exp. (GW)
April 1966

Well No.

WELL SCHEDULE

U. S. DEPT. OF THE INTERIOR

GEOLOGICAL SURVEY

WATER RESOURCES DIVISION

MASTER CARD

Record by PE Grantham Source of data Dlg Date 4-7-66 Map Pascagoula Quad.
 State Miss County Jackson Sequential number: 30
 Latitude: 30 deg 21 min 15 sec N Longitude: 08 degrees 83 min 04 sec W
 Lat-long accuracy: 2 T, 8 S, 6 E, 5 W, SE Irr, IRR B & M
 Local well number: P150 Other number: 0508506
 Local use: 064157 06719 Owner or name: City of Pascagoula
 Owner or name: PASCAGOULA Address: Pascagoula, Miss
 Ownership: County, Fed Gov't, (M) City, Corp or Co, Private, State Agency, Water Dist M
 Use of water: (A) Air cond, Bottling, Comm, Dewater, Power, Fire, Dom, Irr, Med, Ind, (P) S Rec, (S) Stock, Instit, Unused, Repressure, Recharge, Desal-P S, Desal-other, Other P
 Use of well: (A) Anode, Drain, Seismic, Heat Res, Obs, Oil-gas, Recharge, Test, Unused, (W) Withdraw Waste, Destroyed W
 DATA AVAILABLE: Well data 2 Freq. W/L meas.: 0 Field aquifer char. Z
 Hyd. lab. data: _____
 Qual. water data; type: Sample Pick up but not used
 Freq. sampling: 0 Pumpage inventory: no, period: _____
 Aperture cards: _____
 Log data: E-log Driller logs

WELL-DESCRIPTION CARD

SAME AS ON MASTER CARD Depth well: 785 ft Meas. 785 accuracy 3
 Depth cased: 725 ft Casing type: Steel; Diam. 12x8 in 12
 Finish: (C) porous concrete, (F) gravel w. (perfv.), (G) gravel w. (screen), (H) horiz. gallery, end, (P) open perf., (S) sd. pt., (T) shored, (W) open hole, (X) other, (Z) other G
 Method Drilled: (A) air rot, (B) bored, (C) cable, (D) dug, (H) hyd rot, (J) jetted, (P) air percussion, (R) reverse, (T) trenching, (V) driven, (W) drive wash, (Z) other H
 Date Drilled: 2/65 9:65 Pump intake setting: _____ ft
 Driller: Layne Central Co. Jackson Miss address _____
 Lift (type): (A) air, (B) bucket, (C) cent, (J) jet, (L) multiple, (M) multiple, (N) none, (P) piston, (R) rot, (S) submerg, (T) turb, (Z) other 7 Deep 7 Shallow 40
 Power (type): diesel, (elec) elec, gas, gasoline, hand, gas, wind; H.P. 40 Y Trans. or meter no. _____
 Descrip. MP Breather hole east side # 2 ft above below LSD, Alt. MP _____
 Alt. LSD: 10 Accuracy: 10 C.I. 10
 Water Level: 55.06 ft above below MP; 55 ft above below LSD Accuracy: _____
 Date meas: 4-6-67 4:67 Yield: 840 gpm 730 Method determined 1
 Drawdown: _____ ft Accuracy: _____ Pumping period: _____ hrs
 QUALITY OF WATER DATA: Iron _____ ppm Sulfate _____ ppm Chloride _____ ppm Hard. _____
 Sp. Conduct. _____ K x 10⁶ Temp. 81 °F Date sampled 4-6-67

Well No. P150

Well No. P150

Latitude-longitude 30° 21' 15" N 088° 33' 04" W
d m s d m s

HYDROGEOLOGIC CARD

SAME AS ON MASTER CARD Physiographic Province: 03 Section: _____

Drainage Basin: D 139 Subbasin: _____

Topo of well site: (D) (C) (E) (F) (H) (K) (L) F
depression, stream channel, dunes, flat, hilltop, sink, swamp,
(O) (P) (S) (T) (U) (V)
offshore, pediment, hillside, terrace, undulating, valley flat

MAJOR AQUIFER: Tertiary, Miocene TM aquifer, formation, group PA

Lithology: sand US Origin: Deltaic 3 Aquifer Thickness: 97 ft

97 Length of well open to: 60 ft 60 Depth to top of: 702 ft

MINOR AQUIFER: _____ aquifer, formation, group _____

Lithology: _____ Origin: _____ Aquifer Thickness: _____ ft

Length of well open to: _____ ft _____ Depth to top of: _____ ft

Intervals Screened: 8"

Depth to consolidated rock: _____ ft _____ Source of data: _____

Depth to basement: _____ ft _____ Source of data: _____

Surficial material: _____ Infiltration characteristics: _____

Coefficient Trans: 52000 gpd/ft 523 Coefficient Storage: _____

Coefficient Perm: 540 gpd/ft²; Spec cap: 19 gpm/ft; Number of geologic cards: _____

- 0-13 Sandy red clay
- 13-20 Clay + sd str.
- 20-25 lo. + Black sd
- 25-35 silty clay
- 35-66 clay + sd
- 66-129 sd
- 129-150 clay
- 150-170 sd
- 170-215 silty
- 215-305 clay
- 305-385 silty
- 385-400 clay + sd str.
- 400-424 clay
- 424-461 sd
- 461-507 clay
- 507-522 sand shale
- 522-565 sd shale
- 565-580 Gumbo sh.
- 580-702 sh. Kintle
- 702-799 sand

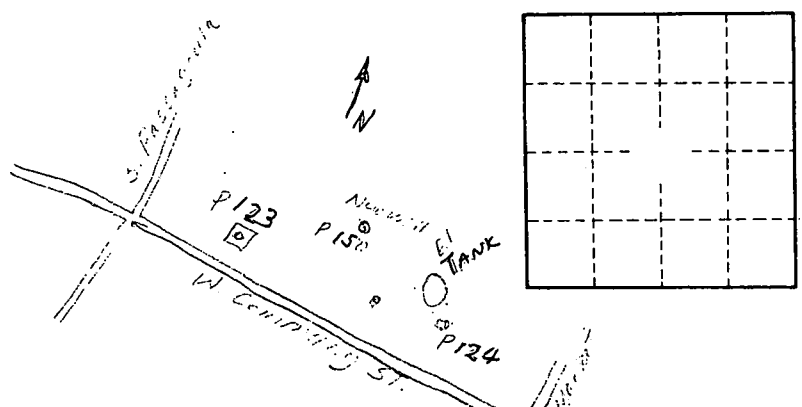

Temp 27°
Ph 8.6
Cond 1425

69.01 MP 1" hb. in pump base
67.77 East side of base 15d

W.L. 24 of -7-29-65

Well No. P150