

9-185
(October 1950)

UNITED STATES
DEPARTMENT OF THE INTERIOR
GEOLOGICAL SURVEY
WATER RESOURCES DIVISION

5116/68

WELL SCHEDULE

Date May 8, 1959 Field No. P123
Record by Reed + others Office No. P106
Source of data _____

1. Location: State Miss. County Jackson

Map

_____ $\frac{1}{4}$ sec. _____ T _____ N R _____ E
S W

2. Owner: City of Resaca Address _____

Tenant _____ Address _____

Driller Merces Runyan Address _____

3. Topography _____

4. Elevation 6.25 ft. above MSL Ground Surveyed
below

5. Type: Dug, drilled driven, bored, jetted _____ 19 _____

6. Depth: Rept. 340 ft. Meas. _____ ft.

7. Casing: Diam. 8 in., to _____ in., Type _____

Depth _____ ft., Finish _____

8. Chief Aquifer _____ From _____ ft. to _____ ft.

Others _____

9. Water level 44.74 ft. rept. 4-18 10.60 above
Pump base which is 1 ft. above
meas. below surface

10. Pump: Type Turbine Capacity _____ G. M.
Power: Kind Electric Horsepower 50

11. Yield: Flow _____ G. M., Pump _____ G. M., Meas., Rept. Est. _____
Drawdown _____ ft. after _____ hours pumping _____ G. M.

12. Use: Dom., Stock, PS, RR., Ind., Irr., Obs. _____

Adequacy, permanence _____

13. Quality _____ Temp 73 °F.

Taste, odor, color _____ Sample 5/13/59
No _____

Unfit for _____ Complete

14. Remarks: (Log, Analyses, etc.) _____ USPHS rare element
and 2167

UNITED STATES
DEPARTMENT OF THE INTERIOR
GEOLOGICAL SURVEY
WATER RESOURCES DIVISION

Form 100
(October 1957)

WATER RESOURCES DIVISION

Pascagoula St

Market St

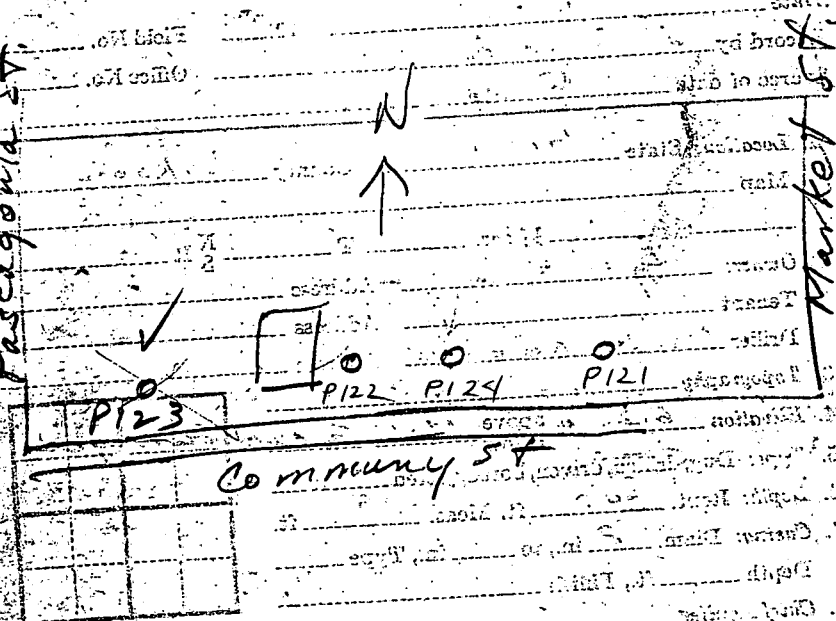

W