

WRD Exp. (GW)  
April 1966

GW01869  
302151088334901

Well No.

P115

WELL SCHEDULE

U. S. DEPT. OF THE INTERIOR

GEOLOGICAL SURVEY

WATER RESOURCES DIVISION

PEG  
1-14-92

REPLACEMENT

Heinz Pet Products

MASTER CARD

Record by TNS Source of data \_\_\_\_\_ Date 4-9-58 Map \_\_\_\_\_

State 203 28 County (or town) JKSN 4 30

Latitude: 30 27 17 N Longitude: 087 33 47 Sequential number: 1

Lat-long accuracy: 3 T. 8 S. R. 6 W. Sec 5 Irr. NW

Local well number: P115 B050 B506W Other number: \_\_\_\_\_

Local use: 064 Owner or name: Star-Kist, Inc

Owner or name: QUAKER OATS CO Address: ALFA

Ownership: County, Fed Gov't, City, Corp or Co, Private, State Agency, Water Dist N

Use of water: (A) Air cond, Bottling, Comm, Dewater, Power, Fire, Dom, Irr, Med, Ind, P S, Rec, (S) (T) (U) (V) (W) (X) (Y) (Z) N

Use of well: (A) Anode, Drain, Seismic, Heat Res, Obs, Oil-gas, Recharge, Test, Unused, Withdraw, Waste, Destroyed (D) (E) (F) (G) (H) (I) (J) (K) (L) (M) (N) (O) (P) (Q) (R) (S) (T) (U) (V) (W) (X) (Y) (Z) W

DATA AVAILABLE: Well data  Freq. W/L meas.:  Field aquifer char.

Hyd. lab. data: \_\_\_\_\_

Qual. water data; type: USGS 5-5-62

Freq. sampling:  Pumpage inventory: no, period: \_\_\_\_\_

Aperture cards: \_\_\_\_\_

Log data: D

WELL-DESCRIPTION CARD

SAME AS ON MASTER CARD Depth well: ft 316 Meas. rept accuracy 3

Depth cased: (first perf.) ft 266 Casing type: \_\_\_\_\_; Diam. 12X8 in 12

Finish: (C) concrete, (F) porous gravel w. (G) gravel w. (H) horiz. open (I) screen, (J) gallery, end, (K) none, (L) perfor., (M) screen, (N) sd. pt., (O) shored, (P) open hole, (Q) other G

Method Drilled: (A) air bored, (B) cable, (C) dug, (D) hyd jetted, (E) air percussion, (F) rotary, (G) reverse trenching, (H) driven, (I) drive wash, (J) other H

Date Drilled: 2/1/58 - permit 958 Pump intake setting: \_\_\_\_\_ ft \_\_\_\_\_

Driller: LAYNE JACKSON

Lift (type): (A) air, (B) bucket, (C) cent, (D) jet, (E) multiple, (F) multiple, (G) none, (H) piston, (I) rot, (J) submerg, (K) turb, (L) other T Deep 7 Shallow 40

Power (type): (A) diesel, (B) elec, (C) gas, (D) gasoline, (E) hand, (F) gas, (G) wind; H.P. 40 Trans. or meter no. V

Descrip. MP \_\_\_\_\_ ft above below LSD. Alt. MP \_\_\_\_\_

Alt. LSD: 8.42 Accuracy: (source) 0

Water Level \_\_\_\_\_ ft above below MP; Ft below LSD 40 Accuracy: \_\_\_\_\_

Date meas: 459 Yield: 250 gpm 674 Method determined \_\_\_\_\_

Drawdown: \_\_\_\_\_ ft Accuracy: \_\_\_\_\_ Pumping period \_\_\_\_\_ hrs \_\_\_\_\_

QUALITY OF WATER DATA: Iron \_\_\_\_\_ ppm Sulfate \_\_\_\_\_ ppm Chloride 122 ppm Hard. \_\_\_\_\_ ppm

Sp. Conduct 851 K x 10 4 Temp. \_\_\_\_\_ °F Date sampled 562

Taste, color, etc. \_\_\_\_\_

ROLLA COMPUTATION BRANCH

6/23/88  
PH=8.00  
T=24.9°  
C=850

Frank Jordan

Cond = 656  
1-14-92  
PEG

Well No. 302151088334901

P115

1-14-92 PEG  
Infor From Frank Jordan

Sampled this date  
Cond = 656

SYAR KIST

Lorveta Robinson ← 1A240 Capped 12-91  
TO 1485  
07921 and 072920  
MS @ W 01869 and 01870  
Still in use

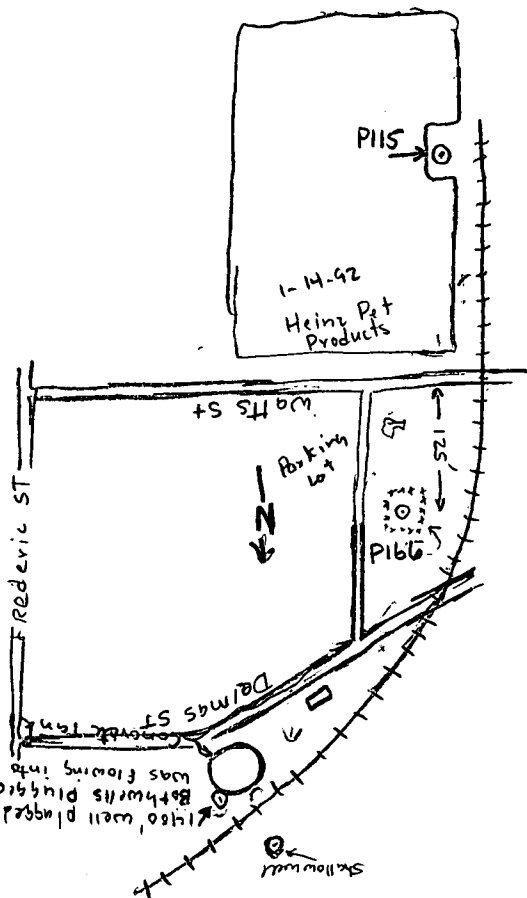

Mr Frank Jordan reports that the 1400' flowing well was plugged in 12-91

Turbine Pump w/air line probably can be measured

PEGvantham 1-52

Well No. P115

Latitude-longitude \_\_\_\_\_  
N S  
d m s d m s

**HYDROGEOLOGIC CARD**

Physiographic Province: 03 Section: \_\_\_\_\_

Drainage Basin: D Subbasin: 13Q

Topo of well site: (D) depression, (C) stream channel, (E) dunes, (F) flat, (H) hilltop, (K) sink, (L) offshore, (P) pediment, (S) hillside, (T) terrace, (U) undulating, (V) valley flat

MAJOR AQUIFER: system \_\_\_\_\_ series T.P aquifer, formation, group G.P

Lithology: U.S Origin: 3 Aquifer Thickness: \_\_\_\_\_ ft

Length of well open to: \_\_\_\_\_ ft Depth to top of: 50 ft

MINOR AQUIFER: system \_\_\_\_\_ series \_\_\_\_\_ aquifer, formation, group \_\_\_\_\_

Lithology: \_\_\_\_\_ Origin: \_\_\_\_\_ Aquifer Thickness: \_\_\_\_\_ ft

Length of well open to: \_\_\_\_\_ ft Depth to top of: \_\_\_\_\_ ft

Intervals Screened: \_\_\_\_\_

Depth to consolidated rock: \_\_\_\_\_ ft Source of data: \_\_\_\_\_

Depth to basement: \_\_\_\_\_ ft Source of data: \_\_\_\_\_

Surficial material: \_\_\_\_\_ Infiltration characteristics: \_\_\_\_\_

Coefficient Trans: \_\_\_\_\_ gpd/ft Coefficient Storage: \_\_\_\_\_

Coefficient Perm: \_\_\_\_\_ gpd/ft<sup>2</sup>; Spec cap: \_\_\_\_\_ gpm/ft; Number of geologic cards: \_\_\_\_\_

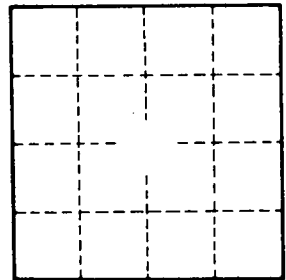
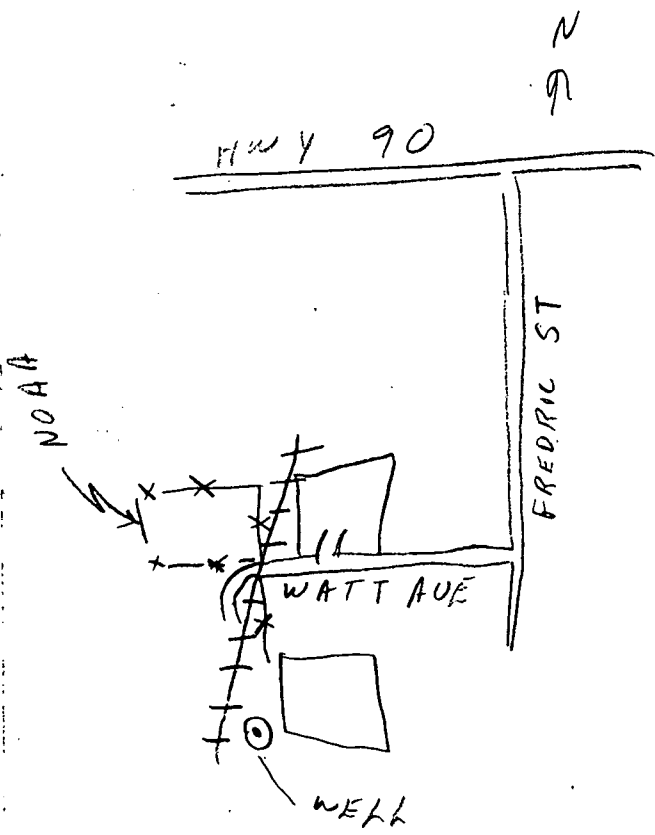

SAMPLED  
 10/27/82  
 PH = 7.6  
 TEMP = 23  
 COND = 650

---

MEASURED  
 10/29/82  
 HOLD = 80.00  
 CWT = 20.11  
 59.89  
 M.P. 1.18  
 GPO 857-700  
 W.C. 58.71

Well No. P115