

W.L. in well stable after adding water
 9-185
 (October 1950)
 open to 100
 W.L. - 3.6'
 MP = Tocat 1.0'
 9/15/77 CEW

UNITED STATES
 DEPARTMENT OF THE INTERIOR
 GEOLOGICAL SURVEY
 WATER RESOURCES DIVISION

P41
 P150

WELL SCHEDULE

Date 7-24-1959 Field No. P41
 Record by T. W. SHAW Office No. P150
 Source of data Mrs. HULTZ (RAY) PI

1. Location: State Miss County JACKSON
 Map PASCAGOULA ROAD
NW 1/4 NW 1/4 sec. 24 T 7 N R 6 E W
 2. Owner: HULTZ SEAFOOD CO Address MOSS POINT
 Tenant _____ Address BY BRIDGE ON S
 Driller C. T. SWITZER Address GULFPORT

3. Topography _____
 4. Elevation _____ ft. above _____ below
 5. Type: Dug, (drilled), driven, bored, jetted _____ 19 49
 6. Depth: Rept. 206 ft. Meas. _____ ft.
 7. Casing: Diam. 3 in., to _____ in., Type _____
 Depth _____ ft., Finish 90 Distances
 8. Chief Aquifer _____ From _____ ft. to _____ ft.
 Others _____

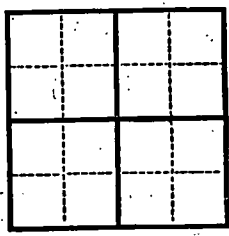

9. Water level 3014 ft. (rept. meas.) _____ 19 _____ above below
 _____ which is _____ ft. above below surface
 10. Pump: Type JET Capacity _____ G. M.
 Power: Kind ELECT Horsepower 1
 11. Yield: Flow _____ G. M., Pump _____ G. M., Meas., Rept. Est.
 Drawdown _____ ft. after _____ hours pumping _____ G. M.

12. Use: (Dom.) Stock, PS., RR., (Ind.) Irr., Obs. DRIVE-IN, SHOWBOAT RESTAURANT SEAFOOD HOUSE ALL USE WATER
 Adequacy, permanence _____
 13. Quality Good Temp _____ °F.
 Taste, odor, color _____ Sample Yes 5-18-60
No HTER
 Unfit for _____

14. Remarks: (Log, Analyses, etc.) _____

DEPARTMENT OF THE ARMY
ENGINEERING CENTER
FORT BELLEVILLE, ILLINOIS

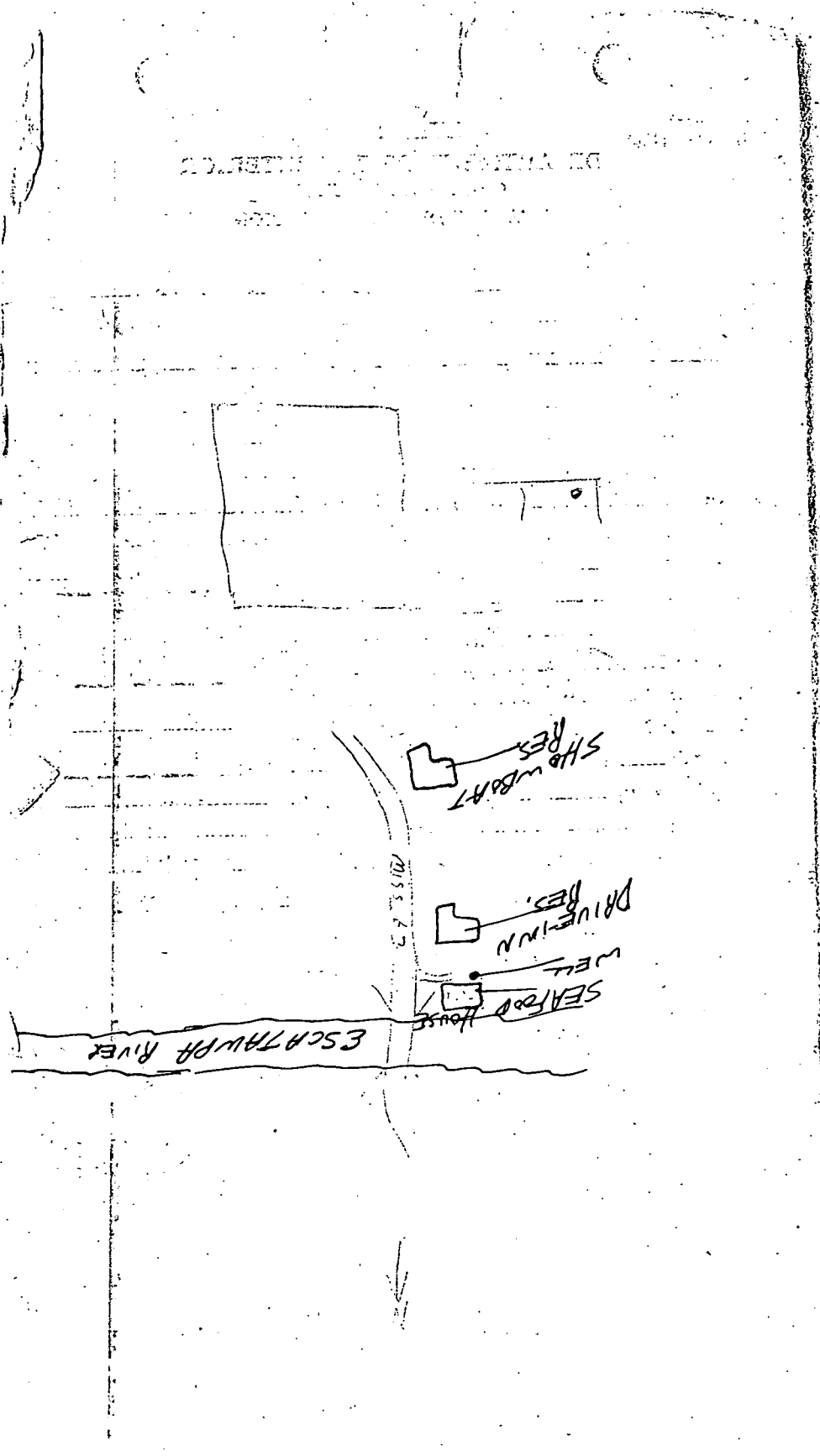

SHEWBART
RES.

DRIVEWAY
WELL

SEARCHED
HOUSE

ESCHTAUWPH RIVER