

PUNCHED and VERIFIED
ROLLA COMPUTATION BRANCH

WRD Exp. (GW)
April 1966

Well No. P29

WELL SCHEDULE

U. S. DEPT. OF THE INTERIOR GEOLOGICAL SURVEY WATER RESOURCES DIVISION

MASTER CARD

Record by BROWN Source of data SCHOOL PRINCIPAL Date ? Map _____

State 28 County JKSN (or town) _____

Latitude: 30 deg 26 min 16 sec N Longitude: 088 degrees 32 min 30 sec W Sequential number: 1

Lat-long accuracy: 2 T. 7 S. 60 E. Sec 9, SE NE

Local well number: P029DA0907S06W Other number: #28A Bull 60

Local use: 088 Owner or name: _____

Owner or name: ESCATAWPA SCHOOL Address: _____

Ownership: County, Fed Gov't, City, Corp or Co, Private, State Agency, Water Dist C

Use of water: (A) Air cond, Bottling, Comm, Dewater, Power, Fire, Dom, Irr, Med, Ind, P S, Rec, (S) Stock, Instit, Unused, Repressure, Recharge, Desal-P S, Desal-other, Other T

Use of well: (A) Anode, Drain, Seismic, Heat Res, Obs, Oil-gas, Recharge, Test, Unused, Withdraw, Waste, Destroyed W

DATA AVAILABLE: Well data Freq. W/L meas.: Field aquifer char.

Hyd. lab. data: _____

Qual. water data; type: _____

Freq. sampling: _____ Pumpage inventory: yes, no, period: _____

Aperture cards: _____

Log data: _____

Well
Unused
Capped
Off
10/29/86

WELL-DESCRIPTION CARD

SAME AS ON MASTER CARD Depth well: 1092 ft Meas. 6

Depth cased; (first perf.) _____ ft Casing type: _____; Diam. _____ in

Finish: porous concrete, gravel w. (perf.), gravel w. (screen), horiz. gallery, open end, perf., screen, sd. pt., shored, open hole, other S

Method: (A) air bored, (B) cable, (C) dug, (D) hyd jetted, (E) air reverse, (F) trenching, (G) driven, (H) drive wash, (I) rot., (J) percussion, (K) rotary, other I

Date Drilled: 930 Pump intake setting: _____ ft

Driller: SWITZER, address _____

Lift (type): (A) air, (B) bucket, (C) cent, (D) jet, (E) multiple, (F) multiple, (G) none, (H) piston, (I) rot, (J) submerg, (K) turb, (L) other N Deep Shallow

Power (type): (A) diesel, (B) elec, (C) gas, (D) gasoline, (E) hand, (F) gas, (G) wind, (H) H.P., (I) Trans. or meter no.

Descrip. MP _____ ft above LSD. Alt. MP _____

Alt. LSD: _____ Accuracy: (source) 3

Water Level: _____ ft above MP; _____ ft below LSD +30 Accuracy: _____

Date meas: 30 Yield: _____ gpm Method determined 50

Drawdown: _____ ft Accuracy: _____ Pumping period _____ hr

QUALITY OF WATER DATA: Iron _____ ppm Sulfate _____ ppm Chloride _____ ppm Hard. _____ ppm

Sp. Conduct _____ K x 10 6 Temp. _____ °F Date sampled _____

Taste, color, etc. _____

Well No.

P29

P 29

Well No. _____

Latitude-longitude _____
N
S
d m s d m s

HYDROGEOLOGIC CARD

SAME AS ON MASTER CARD Physiographic Province: 03 Section: _____
19 20 21

D Drainage Basin: 13Q Subbasin: _____
22 23 25 26

(D) (C) (E) (F) (H) (K) (L)
Topo of well site: depression, stream channel, dunes, flat, hilltop, sink, swamp,
(O) (P) (S) (T) (U) (V) _____ 27
offshore, pediment, hillside, terrace, undulating, valley flat

MAJOR AQUIFER: _____ system, _____ series T M _____ aquifer, formation, group P A
28 29 30 31

Lithology: _____ U S Origin: _____ 3 Aquifer Thickness: _____ ft
32 33 34

Length of well open to: _____ ft _____ Depth to top of: _____ ft _____
35 37 38 40 41 43

MINOR AQUIFER: _____ system, _____ series _____ aquifer, formation, group _____
44 45 46 47

Lithology: _____ _____ Origin: _____ _____ Aquifer Thickness: _____ ft
48 49 50

Length of well open to: _____ ft _____ Depth to top of: _____ ft _____
51 53 54 56 57 59

Intervals Screened: _____

Depth to consolidated rock: _____ ft _____ Source of data: _____ 64
60 63

Depth to basement: _____ ft _____ Source of data: _____ 69
65 68

Surficial material: _____ Infiltration characteristics: _____ 72
70 71

Coefficient Trans: _____ gpd/ft _____ Coefficient Storage: _____ 76 78
73 75

Coefficient Perm: _____ gpd/ft²; Spec cap: _____ gpm/ft; Number of geologic cards: _____ 79

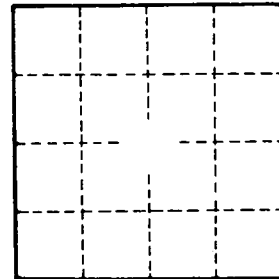
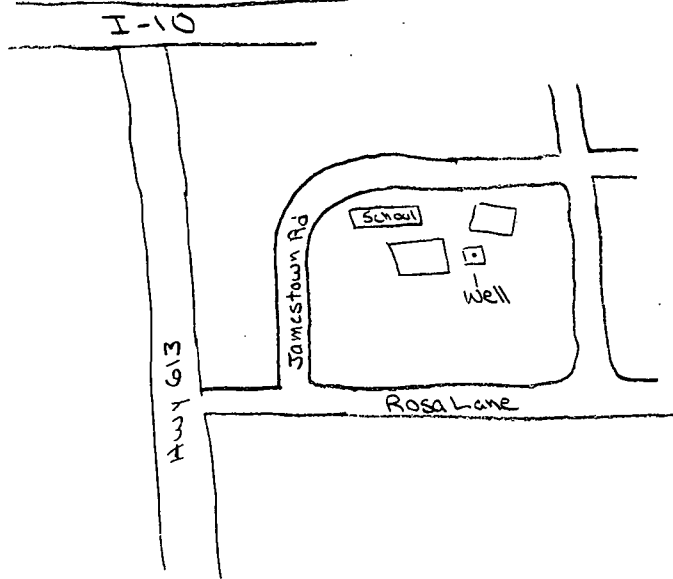

Well No. _____
P 29