

302452088384901 - ID

OK ✓

FORM 9-1642 (1-68)

Well No. Φ 208

WELL SCHEDULE  
GEOLOGICAL SURVEY

Log # 203  
G. A. TIER N

U. S. DEPT. OF THE INTERIOR

WATER RESOURCES DIV

PUNCHED  
DEC 6 1973

MASTER CARD

Record by WTO Source of data MGS Date 8/72 Map \_\_\_\_\_

State Miss 28 County (or town) JACKSON 30

Latitude: 30 24 57 N Longitude: 0 88 38 W Sequential number: 1

Lat-long accuracy: 2 7 7 Sec 24 SW t, SW t, SW t

Local well number: Φ 208 CC 2407507W Other number: \_\_\_\_\_ B & M

Local use: 203 Owner or name: WEST GATE EST Address: Lauter

Ownership: County, Fed Gov't, City, Corp or Co, Private, State Agency, Water Dist N

Use of Air cond, Bottling, Comm, Dewater, Power, Fire, Dom, Irr, Med, Ind, P S, Rec, P

water: (S) (T) (W) (V) (W) (X) (Y) (Z) P

Use of well: (A) (D) (G) (H) (I) (J) (K) (L) (M) (N) (O) (P) (Q) (R) (S) (T) (U) (V) (W) (X) (Y) (Z) W

well: Anode, Drain, Seismic, Heat Res, Obs, Oil-gas, Recharge, Test, Unused, Withdraw, Waste, Destroyed.

DATA AVAILABLE: Well data  Freq. W/L meas.:  Field aquifer char.

Hyd. lab. data: \_\_\_\_\_

Qual. water data; type: \_\_\_\_\_

Freq. sampling: \_\_\_\_\_ Pumpage inventory: yes  no, period: \_\_\_\_\_

Aperture cards: \_\_\_\_\_ yes

Log data: Flag 18-808' DE

6/22/88  
P = 8.43  
T = 27.0  
Cond = 1120

3/29/93

T = 26  
C = 1103  
PH = 8.55

WELL-DESCRIPTION CARD

SAME AS ON MASTER CARD Depth well: 760 Meas. rept 3

Depth cased: (first perf.) 710 Casing type: Steel Diam. 8x6 in 8

Finish: (C) porous concrete, (F) gravel w. (G) gravel w. (H) horiz. (I) open (J) perf., (K) screen, (L) sd. pt., (M) shored, (N) open hole, (O) other S

Method: (A) air rot, (B) bored, (C) cable, (D) dug, (E) hyd jetted, (F) air percussion, (G) rotary, (H) reverse, (I) trenching, (J) driven, (K) wash, (L) other H

Date Drilled: 7-14-72 9-7-72 Pump intake setting: \_\_\_\_\_ ft \_\_\_\_\_

Driller: Holland Well Co.

Lift (type): (A) air, (B) bucket, (C) cent. jet, (D) multiple, (E) multiple, (F) none, (G) piston, (H) rot, (I) submerg, (J) turb, (K) other  Deep  Shallow

Power (type): diesel, elec, gas, gasoline, hand, gas, wind, H.P. 20  Trans. or meter no. \_\_\_\_\_

Descrip. MP 8 ft above below LSD, Alt. MP \_\_\_\_\_

Alt. LSD: 10 Accuracy: (source) topo 4

Water Level: \_\_\_\_\_ ft above below MP; \_\_\_\_\_ ft above below LSD Accuracy: \_\_\_\_\_

Date meas: N: 7:2 Yield: \_\_\_\_\_ gpm 275 Method determined \_\_\_\_\_

Drawdown: \_\_\_\_\_ ft Accuracy: \_\_\_\_\_ Pumping period: \_\_\_\_\_ hrs \_\_\_\_\_

QUALITY OF WATER DATA: Iron \_\_\_\_\_ ppm Sulfate \_\_\_\_\_ ppm Chloride \_\_\_\_\_ ppm Hard. \_\_\_\_\_ ppm

Sp. Conduct \_\_\_\_\_ K x 10<sup>6</sup> Temp. \_\_\_\_\_ °F Date sampled \_\_\_\_\_

Taste, color, etc. \_\_\_\_\_

Well No. Φ 208

**HYDROGEOLOGIC CARD**

0311100  
 DEC 8 1990

MASTER CARD  
 Physiographic Province: 03 Section: \_\_\_\_\_  
 Drainage Basin: 130 Subbasin: \_\_\_\_\_

Topo of well site: (D) depression, stream channel, dunes, flat, hilltop, sink, swamp, (C) offshore, pediment, hillside, terrace, undulating, valley flat  
 (E) (F) (H) (K) (L) (P) (S) (T) (U) (V) \_\_\_\_\_ 27

MAJOR AQUIFER: \_\_\_\_\_ system \_\_\_\_\_ series \_\_\_\_\_ aquifer, formation, group \_\_\_\_\_  
 28 29 30 31

Lithology: \_\_\_\_\_ Origin: \_\_\_\_\_ Aquifer Thickness: 65 ft  
 32 33 34

Length of well open to: \_\_\_\_\_ ft 50 Depth to top of: \_\_\_\_\_ ft 70.5  
 35 37 38 40 41 43

MINOR AQUIFER: \_\_\_\_\_ system \_\_\_\_\_ series \_\_\_\_\_ aquifer, formation, group \_\_\_\_\_  
 44 45 46 47

Lithology: \_\_\_\_\_ Origin: \_\_\_\_\_ Aquifer Thickness: \_\_\_\_\_ ft  
 48 49 50

Length of well open to: \_\_\_\_\_ ft \_\_\_\_\_ Depth to top of: \_\_\_\_\_ ft \_\_\_\_\_  
 51 53 54 56 57 59

Intervals Screened: 6" S.S.

Depth to consolidated rock: \_\_\_\_\_ ft \_\_\_\_\_ Source of data: \_\_\_\_\_  
 60 63 64

Depth to basement: \_\_\_\_\_ ft \_\_\_\_\_ Source of data: \_\_\_\_\_  
 65 68 69

Surficial material: \_\_\_\_\_ Infiltration characteristics: \_\_\_\_\_  
 70 71 72

Coefficient Trans: \_\_\_\_\_ gpd/ft \_\_\_\_\_ Coefficient Storage: \_\_\_\_\_  
 73 75 76 78

Coefficient Perm: \_\_\_\_\_ gpd/ft<sup>2</sup>; Spec cap: \_\_\_\_\_ gpm/ft; Number of geologic cards: \_\_\_\_\_  
 79

2-10-92  
 Health # 30004-04  
 Gautier Utility  
 Cond = 1102  
 T = 25.6  
 PEG-Sampled

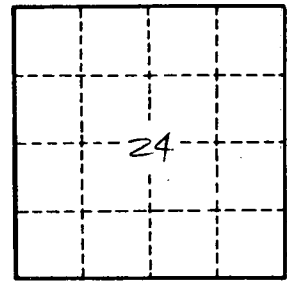
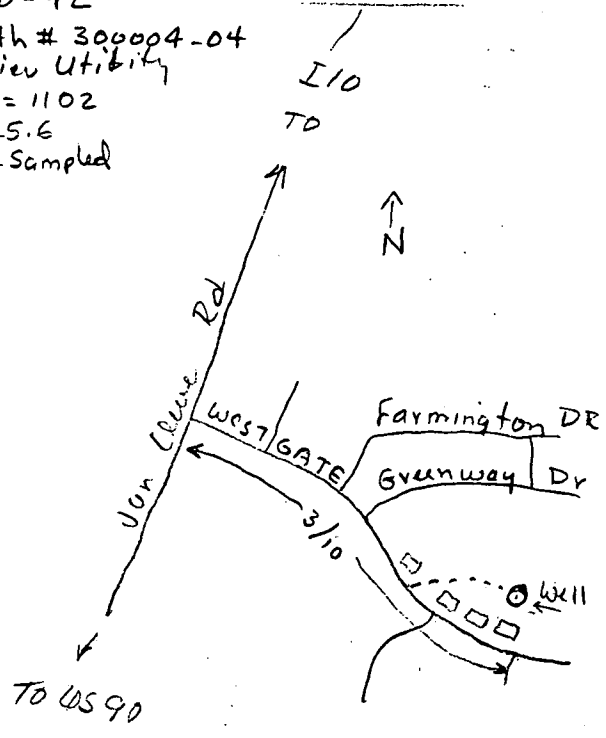

Well No. 208