

FORM 9-1642 (1-68)

Well No. 0197

WELL SCHEDULE

Elog# 196

U. S. DEPT. OF THE INTERIOR

GEOLOGICAL SURVEY

WATER RESOURCES DIVISION

PUNCHED

DEC 6 1973

MASTER CARD

Record by 6 Source of data MSG5 Date 9/71 Map _____

State _____ County (or town) Jackson _____

Latitude: 30° 25' 39" N Longitude: 088° 43' 00" W Sequential number: 1

Lat-long accuracy: 5 T 7 N 7 E Sec 17 SW NW NW IR/IR

Local well number: 0197 1908507W Other number: 11

Local use: 064196 Owner or name: St. Andrews

Owner or name: ST. ANDREWS Address: _____

Ownership: County, Fed Gov't, City, Corp or Co, Private, State Agency, Water Dist _____ N

Use of Air cond, Bottling, Comm, Dewater, Power, Fire, Dom, Irr, Med, Ind, P S, Rec, water: _____ P

Use of well: Anode, Drain, Seismic, Heat Res, Obs, Oil-gas, Recharge, Test, Unused, Withdraw, Waste, Destroyed. _____ W

DATA AVAILABLE: Well data Freq. W/L meas.: Field aquifer char.

Hyd. lab. data: _____

Qual. water data; type: USGS

Freq. sampling: _____ Pumpage inventory: _____

Aperture cards: _____

Log data: 100' - 1007'

6/22/88
 T=25.0
 PH=8.5
 SpCond=530

WELL-DESCRIPTION CARD

SAME AS ON MASTER CARD Depth well: 634 ft Meas. 3

Depth cased: 573 ft Casing type: _____; Diam. 16x8 in

Finish: porous concrete, gravel v. concrete, gravel v. (perf.), (screen), horla. open gallery, end, other _____ G

Method Drilled: air bored, cable, dug, hyd jacked, air reverse trenching, driven, drive rot., percussion, rotary, other _____ H

Date Drilled: 5/69 969 Pump intake setting: _____ ft

Driller: Singer Lignite Control, Jackson Miss

Lift (type): air, bucket, cent, jet, multiple, multiple, none, piston, rot, submerg, turb, other _____ T Deep _____ Shallow _____

Power (type): diesel, elec, gas, gasoline, hand, gas, wind; H.P. 40HP Trans. or meter no.

Descrip. MP 15 ft above below LSD, Alt. MP _____

Alt. LSD: _____ Accuracy: (source) _____ 4

Water Level: _____ ft above below MP; _____ ft above below LSD Accuracy: _____ D

Date meas: 6/24 669 Yield: 377 gpm _____ 377 Method determined _____

Drawdown: _____ ft Accuracy: _____ Pumping period: _____ hrs _____

QUALITY OF WATER DATA: Iron _____ Sulfate _____ Chloride _____ Hard. _____

Sp. Conduct 560 K x 10⁴ 4 Temp. _____ °F _____ Date sampled 4/25/77 473

Taste, color, etc. pH 8.1

TRANSMITTED FOR ADR

Well No.

Latitude-longitude _____ N
d m s S d m s

IRRETRIEVABLE FOR VSA

HYDROGEOLOGIC CARD

Physiographic Province: 0:3 Section: _____

Drainage Basin: 1:3:5 Subbasin: _____

Top of well site: (D) depression, stream channel, dunes, flat, hilltop, sink, swamp
(O) offshore, pediment, hillside, terrace, undulating, valley flat

MAJOR AQUIFER: system _____ series T.M aquifer, formation, group M:Z

Lithology: _____ Origin: 3 Aquifer Thickness: _____ ft

Length of well open to: _____ ft Depth to top of: _____ ft

MINOR AQUIFER: system _____ series _____ aquifer, formation, group _____

Lithology: _____ Origin: _____ Aquifer Thickness: _____ ft

Length of well open to: _____ ft Depth to top of: _____ ft

Intervals Screened: _____

Depth to consolidated rock: _____ ft Source of data: _____

Depth to basement: _____ ft Source of data: _____

Surficial material: _____ Infiltration characteristics: _____

Coefficient Trans: _____ gpd/ft Coefficient Storage: _____

Coefficient Perm: _____ gpd/ft²; Spec cap: _____ gpm/ft; Number of geologic cards: _____

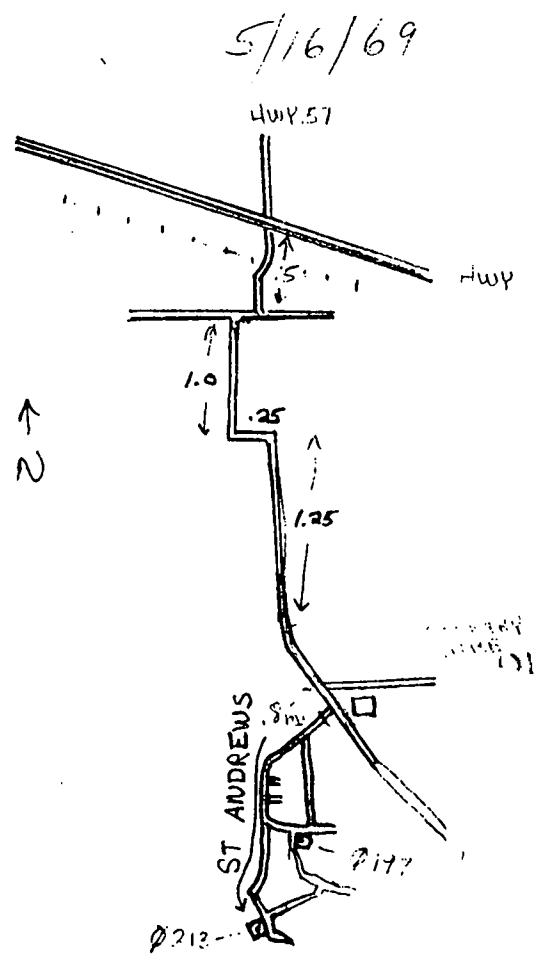

565" 16"

57' 8"

55' 8" slot.

6' BPV

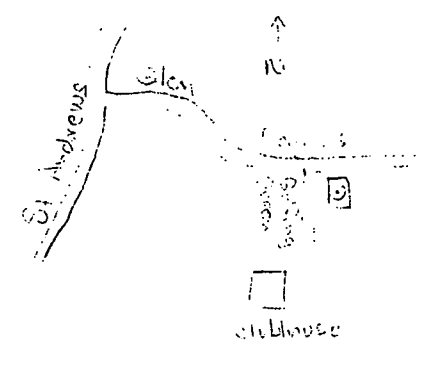
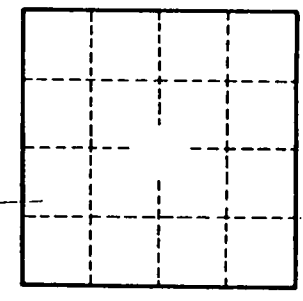

Well No. _____