

WRD Exp. (GW)
April 1966

Well No. 046

WELL SCHEDULE

U. S. DEPT. OF THE INTERIOR

GEOLOGICAL SURVEY

WATER RESOURCES DIVISION

PUNCHED and VERIFIED
BY DATA COMPUTATION BRANCH

MASTER CARD

Record by T.N. SHAW Source of data DRLG Date _____ Map _____

State IA County (or town) 28 Sequential number: 30

Latitude: 30 deg 22 min 11 sec N Longitude: 088 degrees 38 min 43 sec W

Lat-long accuracy: 3 T. 8 S. 7 E. Sec 13, SE 1/4, _____ 1/4, _____ 1/4

Local well number: 0046-01308507W Other number: _____ B & M

Local use: 090 Owner or name: _____

Owner or name: L L TATE Address: _____

Ownership: (C) County, Fed Gov't, City, Corp or Co, Private, State Agency, Water Dist _____ (P) _____

Use of water: (A) Air cond, (B) Bottling, (C) Comm, (D) Dewater, (E) Power, (F) Fire, (G) Dom, (H) Irr, (I) Med, (J) P S, (K) Rec, (L) Stock, (M) Instit, (N) Unused, (O) Repressure, (P) Recharge, (Q) Desal-P S, (R) Desal-other, (S) Other _____

Use of well: (A) Anode, (B) Drain, (C) Seismic, (D) Heat Res, (E) Obs, (F) Oil-gas, (G) Recharge, (H) Test, (I) Unused, (J) Withdraw, (K) Waste, (L) Destroyed _____

DATA AVAILABLE: Well data Freq. W/L meas.: Field aquifer char.

Hyd. lab. data: _____

Qual. water data; type: _____

Freq. sampling: _____ Pumpage inventory: yes, no, period: _____

Aperture cards: _____

Log data: _____

WELL-DESCRIPTION CARD

SAME AS ON MASTER CARD Depth well: _____ ft Meas. rept accuracy _____

Depth cased: (first perf.) _____ ft Casing type: _____; Diam. _____ in

Finish: (C) porous concrete, (F) gravel w. (perf.), (G) gravel w. (screen), (H) horiz. gallery, (I) open end, (J) open perf., (K) screen, (L) sd. pt., (M) stored, (N) open hole, (O) other _____

Method Drilled: (A) air rot, (B) bored, (C) cable, (D) dug, (E) hyd rot., (F) jetted, (G) air percussion, (H) reverse, (I) rotary, (J) trenching, (K) driven, (L) wash, (M) other _____

Date Drilled: 9-5-9 Pump intake setting: _____ ft

Driller: L.L. GARLAND

Lift (type): (A) air, (B) bucket, (C) cent, (D) jet, (E) multiple, (F) multiple, (G) none, (H) piston, (I) rot, (J) submerg, (K) turb, (L) other _____ Deep _____

Power (type): (A) diesel, (B) elec, (C) gas, (D) gasoline, (E) hand, (F) gas, (G) wind, (H) H.P. _____ Trans. or meter no. _____

Descrip. MP _____ ft above _____ ft below LSD. Alt. MP _____

Alt. LSD: _____ Accuracy: (source) _____

Water Level: 1.5 ft above MP; Ft below LSD 2 Accuracy: _____

Date meas: 5-5-4 Yield: _____ gpm Method determined _____

Drawdown: _____ ft Accuracy: _____ Pumping period _____ hrs

QUALITY OF WATER DATA: Iron _____ ppm Sulfate _____ ppm Chloride _____ ppm Hard. _____ ppm

Sp. Conduct _____ K x 10 Temp. _____ °F Date sampled _____

Taste, color, etc. _____

Well No. 046

Well No. Ø 46

Latitude-longitude N
S
d m s d m s

HYDROGEOLOGIC CARD

SAME AS ON MASTER CARD Physiographic Province: 03 Section: _____

D Drainage Basin: 135 Subbasin: _____

Topo of well site: (D) depression, stream channel, dunes, flat, hilltop, sink, swamp, (Ø) offshore, pediment, hillside, terrace, undulating, valley flat
(C) (E) (F) (H) (K) (L) (P) (S) (T) (U) (V) T

MAJOR AQUIFER: TM aquifer, formation, group PA

Lithology: S Origin: 3 Aquifer Thickness: _____ ft

Length of well open to: _____ ft 20 Depth to top of: _____ ft

MINOR AQUIFER: _____ aquifer, formation, group

Lithology: _____ Origin: _____ Aquifer Thickness: _____ ft

Length of well open to: _____ ft _____ Depth to top of: _____ ft

Intervals Screened: _____

Depth to consolidated rock: _____ ft _____ Source of data: _____

Depth to basement: _____ ft _____ Source of data: _____

Surficial material: _____ Infiltration characteristics: _____

Coefficient Trans: _____ gpd/ft _____ Coefficient Storage: _____

Coefficient Perm: _____ gpd/ft²; Spec cap: _____ gpm/ft; Number of geologic cards: _____

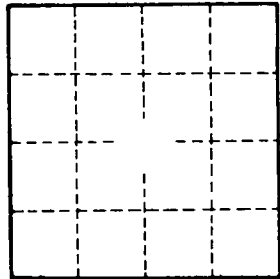
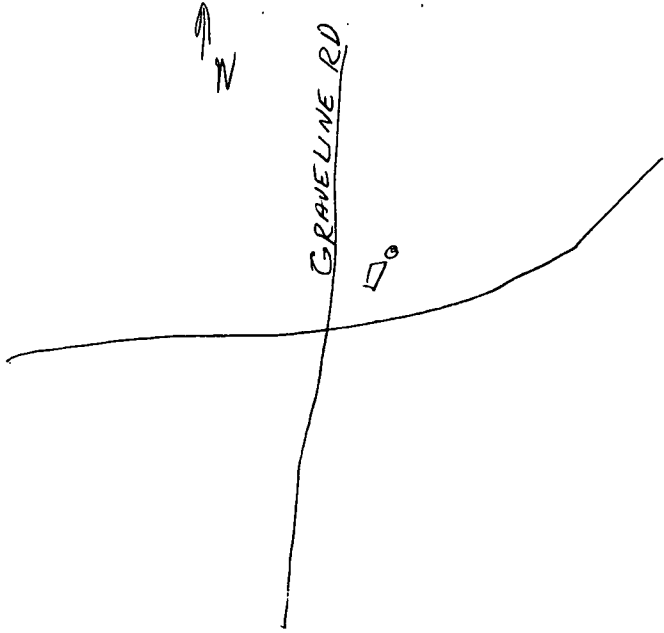

Well No. Ø 46