

PUNCHED and VERIFIED
ROLLA COMPUTATION BRANCH

WRD Exp. (GW)
April 1966

Well No. N 34

WELL SCHEDULE

U. S. DEPT. OF THE INTERIOR

GEOLOGICAL SURVEY

WATER RESOURCES DIVISION

MASTER CARD

Record by T.M.S. Source of data MRS. W. Bilbo Date 6/5/59 Map _____

State 28 County (or town) JACKSON 30

Latitude: 30 25 26 N Longitude: 088 45 25 Sequential number: 1

Lat-long accuracy: 2 T. 7 R. 8 Sec 23, SW NE

Local well number: N034CA2307508W Owner or name: _____

Local use: 090 Owner or name: _____

Owner or name: WALTER BILBO Address: _____

Ownership: (C) County, (F) Fed Gov't, (M) City, Corp or Co, (N) Private, (P) State Agency, (S) Water Dist _____ P

Use of water: (A) Air cond, (B) Bottling, (C) Comm, (D) Dewater, (E) Power, (F) Fire, (H) Dom, (I) Irr, (M) Med, (N) Ind, (P) S, (R) Rec, (S) Stock, (T) Instit, (U) Unused, (V) Recharge, (W) Desal-P S, (X) Desal-other, (Y) Other _____ H

Use of well: (A) Anode, (D) Drain, (G) Seismic, (H) Heat Res, (I) Obs, (P) Oil-gas, (R) Recharge, (T) Test, (U) Unused, (W) Withdraw, (X) Waste, (Z) Destroyed _____ W

DATA AVAILABLE: Well data Freq. W/L meas.: Field aquifer char. _____

Hyd. lab. data: _____

Qual. water data; type: _____

Freq. sampling: _____ Pumpage inventory: yes, no, period: _____

Aperture cards: _____

Log data: _____

WELL-DESCRIPTION CARD

SAME AS ON MASTER CARD Depth well: _____ ft 135 Meas. rept accuracy _____ 6

Depth cased; (first perf.) _____ ft 129 Casing type: _____; Diam. _____ in _____ 2

Finish: (C) porous concrete, (F) gravel w. (perf.), (G) gravel w. (screen), (H) horiz. gallery, (I) open end, (P) perf., (S) sd. pt., (T) shored, (W) open hole, (X) other _____ S

Method Drilled: (A) air rot, (B) bored, (C) cable, (D) dug, (H) hyd jetted, (J) air rot., (P) percussion, (R) rotary, (T) reverse, (V) driven, (W) drive wash, (X) other _____ H

Date Drilled: 958 Pump intake setting: _____ ft _____ 38

Driller: L.L. Garland name _____ address _____

Lift (type): (A) air, (B) bucket, (C) cent., (J) multiple, (L) multiple, (M) multiple, (N) none, (P) piston, (R) rot, (S) submerg, (T) turb, (X) other _____ P Deep _____ S Shallow _____ 40

Power (type): (nat) diesel, elec, gas, gasoline, hand, gas, wind; (LP) H.P. _____ 1 Trans. or meter no. _____

Descrip. MP _____ ft above _____ ft below LSD. Alt. MP _____

Alt. LSD: _____ 23 Accuracy: (source) _____ 4

Water Level +2.8 ft above MP; Ft below LSD +3 Accuracy: _____ 6

Date meas: 659 Yield: _____ gpm _____ Method determined _____ 61

Drawdown: _____ ft _____ Accuracy: _____ Pumping period _____ hrs _____ 68

QUALITY OF WATER DATA: Iron _____ ppm _____ Sulfate _____ ppm _____ Chloride _____ ppm _____ Hard. _____ 72

Sp. Conduct _____ K x 10 _____ Temp. _____ °F _____ Date sampled _____ 79

Taste, color, etc. _____

Well No. N 34

Well No. N34

Latitude-longitude N
S

HYDROGEOLOGIC CARD

SAME AS ON MASTER CARD Physiographic Province: 03 Section: _____

D Drainage Basin: 135 Subbasin: _____

(D) (C) (E) (F) (H) (K) (L)
Topo of well site: depression, stream channel, dunes, flat, hilltop, sink, swamp,
(0) (P) (S) (T) (U) (V)
offshore, pediment, hillside, terrace, undulating, valley flat

MAJOR TP GF
AQUIFER: _____ system _____ series _____ aquifer, formation, group

Lithology: _____ Origin: _____ Aquifer Thickness: _____ ft

Length of well open to: _____ ft Depth to top of: _____ ft

MINOR TP GF
AQUIFER: _____ system _____ series _____ aquifer, formation, group

Lithology: _____ Origin: _____ Aquifer Thickness: _____ ft

Length of well open to: _____ ft Depth to top of: _____ ft

Intervals Screened: _____

Depth to consolidated rock: _____ ft Source of data: _____

Depth to basement: _____ ft Source of data: _____

Surficial material: _____ Infiltration characteristics: _____

Coefficient Trans: _____ gpd/ft _____ Coefficient Storage: _____

Coefficient Perm: _____ gpd/ft²; Spec cap: _____ gpm/ft; Number of geologic cards: _____

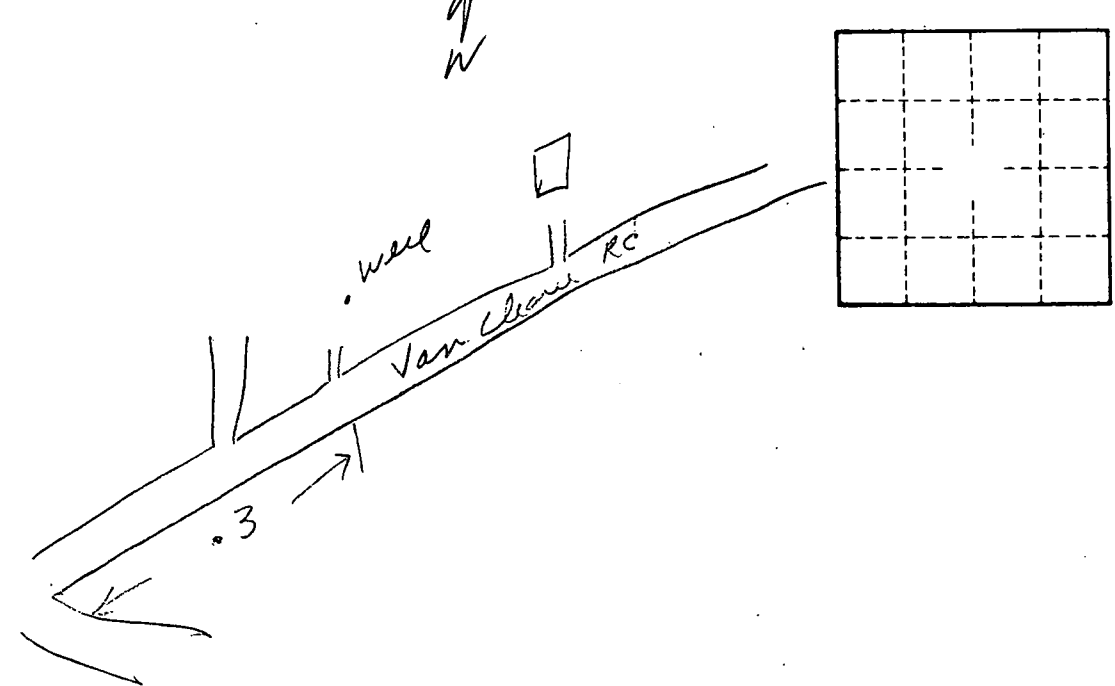

WELL NO. N34