

PUNCHED and VERIFIED
ROLLA COMPUTATION BRANCH

WRD Exp. (GW)
April 1966

Well No. N26

WELL SCHEDULE

U. S. DEPT. OF THE INTERIOR

GEOLOGICAL SURVEY

WATER RESOURCES DIVISION

MASTER CARD

Record by E.W. Reed Source of data Driller Date 4/27/39 Map

State 28 County JACKSON 30
(or town)

Latitude: 302628 N Longitude: 0885033 Sequential number: 1
deg min sec 12 degrees 15 min sec 18

Lat-long accuracy: 20 T. 70 R. 90 Sec 13, SW 1/4, NW 1/4, B & M

Local well number: N0260B1307509W Other number:

Local use: 024 Owner or name:

Owner or name: GULF HILLS CO Address:

Ownership: County, Fed Gov't, City, Corp or Co, Private, State Agency, Water Dist P

Use of water: (A) Air cond, Bottling, Comm, Dewater, Power, Fire, Dom, Irr, Med, Ind, P S, Rec, (S) Stock, Instit, Unused, Repressure, Recharge, Desal-P S, Desal-other, Other H

Use of well: (A) Anode, Drain, Seismic, Heat Res, Obs, Oil-gas, Recharge, Test, Unused, Withdraw, Waste, Destroyed W

DATA AVAILABLE: Well data Freq. W/L meas.: Field aquifer char.

Hyd. lab. data:

Qual. water data; type:

Freq. sampling: Pumpage inventory: period:

Aperture cards:

Log data:

WELL-DESCRIPTION CARD

SAME AS ON MASTER CARD Depth well: 846 Meas. 6
ft 20 23 rept accuracy

Depth cased: 806 Casing type: Steel; Diam. 30
ft 25 28 in 29 30

Finish: (C) porous concrete, (F) gravel w. (G) gravel w. (H) horiz. open, (P) perf., (S) screen, (T) sd. pt., (W) shored, (X) open hole, (Z) other 5

Method Drilled: (A) air rot, (B) bored, (C) cable, (D) dug, (H) hyd rot., (J) jetted, (P) air percussion, (R) reverse, (T) trenching, (V) driven, (W) drive wash, (Z) other H

Date Drilled: 926 Pump intake setting: 36 ft 36 38

Driller: John Sutter name address

Lift (type): (A) air, (B) bucket, (C) cent, (J) jet, (L) multiple, (M) multiple, (N) none, (P) piston, (R) rot, (S) submerg, (T) turb, other T Deep Shallow

Power (type): nat, LP, Trans. or meter no. 5

Descrip. MP 2.8 ft above LSD. Alt. MP 11.88

Alt. LSD: 9.18 Accuracy: 4

Water Level: 33 ft above MP; +36 ft below LSD Accuracy: 4

Date meas: 439 Yield: 300 gpm Method determined

Drawdown: 33 ft Accuracy: 300 gpm Pumping period: 300 hrs

QUALITY OF WATER DATA: Iron 0 ppm Sulfate 0 ppm Chloride 0 ppm Hard. 0 ppm

Sp. Conduct 80 K x 10⁶ Temp. 80 °F Date sampled 439

Taste, color, etc.

Well No. N26

Well No. N126

Latitude-longitude N
S
 d m s d m s

HYDROGEOLOGIC CARD

SAME AS ON MASTER CARD Physiographic Province: 03 Section: _____
 19 20 21

Drainage Basin: D 135 Subbasin: _____
 22 23 25 26

Topo of well site: (D) depression, stream channel, dunes, flat, hilltop, sink, swamp, (E) (F) (H) (K) (L) (O) (P) (S) (T) (U) (V) offshore, pediment, hillside, terrace, undulating, valley flat _____
 27

MAJOR AQUIFER: _____ system _____ series TM _____ aquifer, formation, group PA
 28 29 30 31

Lithology: _____ Origin: _____ Aquifer Thickness: _____ ft
 32 33 34

Length of well open to: _____ ft 40 Depth to top of: _____ ft _____
 35 37 38 40 41 43

MINOR AQUIFER: _____ system _____ series _____ aquifer, formation, group _____
 44 45 46 47

Lithology: _____ Origin: _____ Aquifer Thickness: _____ ft
 48 49 50

Length of well open to: _____ ft _____ Depth to top of: _____ ft _____
 51 53 54 56 57 59

Intervals Screened:

Depth to consolidated rock: _____ ft _____ Source of data: _____
 40 63 64

Depth to basement: _____ ft _____ Source of data: _____
 65 68 69

Surficial material: _____ Infiltration characteristics: _____
 70 71 72

Coefficient Trans: 62,000 gpd/ft 623 Coefficient Storage: _____
 73 75 76 78

Coefficient Perm: _____ gpd/ft²; Spec cap: _____ gpm/ft; Number of geologic cards: _____
 79

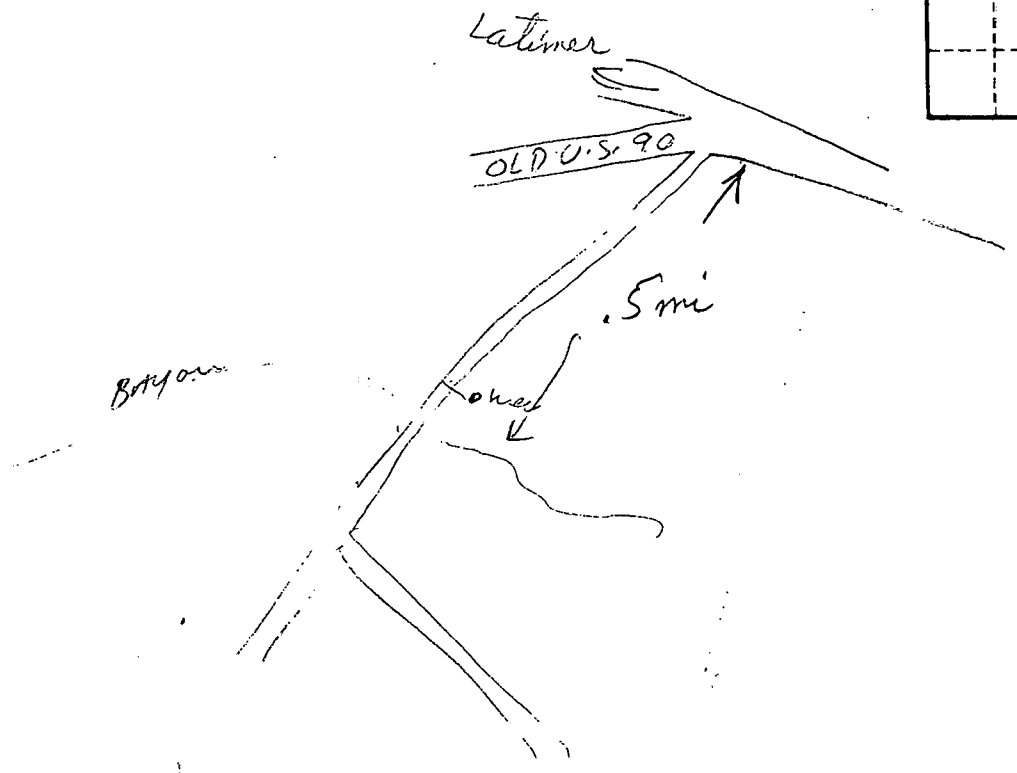
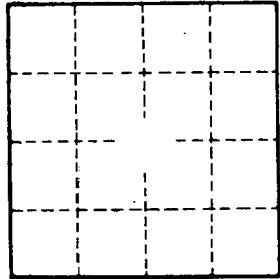

Well No. N126