

SITE ID- 30 3150 088 30260!

FORM 9-1642 (1-68)

Well No. M186 3750

WELL SCHEDULE  
GEOLOGICAL SURVEY

WATER RESOURCES DIVISION

PUNCHED  
DEC 6 1973

U. S. DEPT. OF THE INTERIOR

11/19/85  
30  
22,57  
7.43  
1.0  
6.43

MASTER CARD

Record by JCM Source of data BOWC Date 10-72 Map \_\_\_\_\_

State LA County (or town) Jackson 30

Latitude: 30° 31' 50" N Longitude: 088° 30' 06" W Sequential number: 1

Lat-long accuracy: 2 T 60 N 50 E 8 Sec 8, SE 1/4, SE 1/4, SE 1/4

Local well number: M186DC0806305W Other well number: \_\_\_\_\_ B & M

Local use: 006 Owner or name: \_\_\_\_\_

Owner or name: W. A. GREEN Address: Helena

Ownership: County, Fed Gov't, City, Corp or Co, Private, State Agency, Water Dist P

Use of Air cond, Bottling, Comm, Dewater, Power, Fire, Dom, Irr, Med, Ind, P S, Rec, water: \_\_\_\_\_

Stock, Instit, Unused, Repressure, Recharge, Desal-P S, Desal-other, Other H

Use of well: Anode, Drain, Seismic, Heat Res, Obs, Oil-gas, Recharge, Test, Unused, Withdraw, Waste, Destroyed. W

DATA AVAILABLE: Well data  Freq. W/L meas.:  Field aquifer char.

Hyd. lab. data: \_\_\_\_\_

Qual. water data; type: \_\_\_\_\_

Freq. sampling: \_\_\_\_\_ Pumpage inventory:  yes  no, period: \_\_\_\_\_

Log data: \_\_\_\_\_

WELL-DESCRIPTION CARD

SAME AS ON MASTER CARD Depth well: 670 ft Meas. rept accuracy 5

Depth cased: 655 ft Casing type: Steel; Diam. 4x2 in 4

Finish: porous concrete, gravel w. concrete, gravel w. (screen), gravel w. horiz. gallery, open end, perf., screen, sd. pt., shored, open hole, other 5

Method Drilled: air bored, cable, dug, hyd jetted, rot, air rot., percussion, rotary, reverse trenching, driven, drive wash, other H

Date Drilled: 9-7-72 Pump intake setting: \_\_\_\_\_ ft

Driller: Calville name address

Lift (type): air, bucket, cent, jet, multiple, multiple, none, piston, rot, submerg, turb, other S Deep  Shallow

Power (type): diesel, gas, gasoline, hand, gas, wind; H.P. 3 Trans. or meter no. T

Descrip. MP \_\_\_\_\_ ft above below LSD, Alt. MP \_\_\_\_\_

Alt. LSD: 31 Accuracy: (source) \_\_\_\_\_

Water Level \_\_\_\_\_ ft above below MP; Ft below LSD 30 Accuracy: \_\_\_\_\_

Date meas: 6-7-72 Yield: \_\_\_\_\_ gpm Method determined \_\_\_\_\_

Drawdown: \_\_\_\_\_ ft Accuracy: \_\_\_\_\_ Pumping period \_\_\_\_\_ hrs

QUALITY OF WATER DATA: Iron \_\_\_\_\_ ppm Sulfate \_\_\_\_\_ ppm Chloride \_\_\_\_\_ ppm Hard. \_\_\_\_\_ ppm

Sp. Conduct \_\_\_\_\_ K x 10<sup>6</sup> Temp. \_\_\_\_\_ °F Date sampled \_\_\_\_\_

Taste, color, etc. \_\_\_\_\_

Well No. \_\_\_\_\_

PUNCHED  
DEC 1952

Latitude-longitude \_\_\_\_\_  
N  
S  
d m s d m s

HYDROGEOLOGIC CARD

SAME AS ON MASTER CARD Physiographic Province: 03 Section: \_\_\_\_\_

Drainage Basin: D Subbasin: 113Q

Topo of well site: (D) depression, (C) stream channel, (E) dunes, (F) flat, (H) hilltop, (K) sink, (L) swamp, (P) offshore, (S) pediment, (T) hillside, (U) terrace, (V) undulating, valley flat

MAJOR AQUIFER: system \_\_\_\_\_ series TM aquifer, formation, group MZ

Lithology: \_\_\_\_\_ Origin: 3 Aquifer Thickness: 18 ft

Length of well open to: \_\_\_\_\_ ft 15 Depth to top of: \_\_\_\_\_ ft 65.2

MINOR AQUIFER: system \_\_\_\_\_ series \_\_\_\_\_ aquifer, formation, group \_\_\_\_\_

Lithology: \_\_\_\_\_ Origin: \_\_\_\_\_ Aquifer Thickness: \_\_\_\_\_ ft

Length of well open to: \_\_\_\_\_ ft \_\_\_\_\_ Depth to top of: \_\_\_\_\_ ft \_\_\_\_\_

Intervals Screened: 2" S.S.

Depth to consolidated rock: \_\_\_\_\_ ft \_\_\_\_\_ Source of data: \_\_\_\_\_

Depth to basement: \_\_\_\_\_ ft \_\_\_\_\_ Source of data: \_\_\_\_\_

Surficial material: \_\_\_\_\_ Infiltration characteristics: \_\_\_\_\_

Coefficient Trans: \_\_\_\_\_ gpd/ft \_\_\_\_\_ Coefficient Storage: \_\_\_\_\_

Coefficient Perm: \_\_\_\_\_ gpd/ft<sup>2</sup>; Spec cap: \_\_\_\_\_ gpm/ft; Number of geologic cards: \_\_\_\_\_

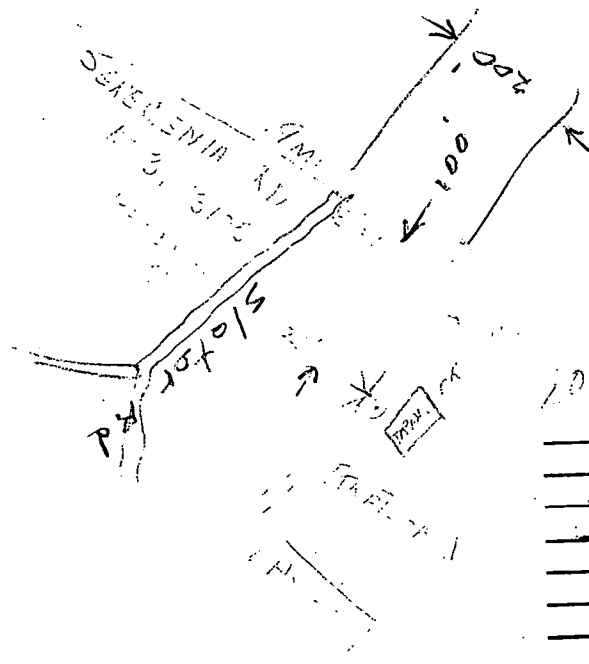
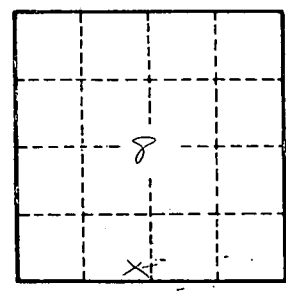

Well No. N 186

|               |     |     |
|---------------|-----|-----|
| Q. lay        | 0   | 30  |
| Sand          | 30  | 110 |
| Sand, P lay   | 110 | 172 |
| Sh. Sand Sand | 198 | 238 |
| P lay         | 233 | 459 |
| Sand          | 452 | 678 |

