

SITE ID- 3031290882710

WRD Exp. (GW)
April 1966

Well No. M46

WELL SCHEDULE
GEOLOGICAL SURVEY

376C

U. S. DEPT. OF THE INTERIOR

WATER RESOURCES DIVISION

PUNCHED and VERIFIED
ROLLA COMPUTATION BRANCH

MASTER CARD

Record by J. HARRELL Source of data BOWC Date 4/9/68 Map _____

State 059 28 County (or town) JACKSON 310

Latitude: 3 deg 03 min 39 sec N Longitude: 08 deg 22 min 17 sec W Sequential number: 1

Lat-long accuracy: 4 T. 6 R. 5 Sec. 14 SW NE

Local well number: M 046 CA 1406 505 W Other number: _____

Local use: 006 Owner or name: LILLY ORCH BAPT CHURCH Address: HELENA

Ownership: County, Fed Gov't, City, Corp or Co, Private, State Agency, Water Dist _____ P

Use of water: Air cond, Bottling, Comm, Dewater, Power, Fire, Dom, Irr, Med, Ind, P S, Rec, Stock, Instit, Unused, Repressure, Recharge, Desal-P S, Desal-other, Other _____ H

Use of well: Anode, Drain, Seismic, Heat Res, Obs, Oil-gas, Recharge, Test, Unused, Withdraw, Waste, Destroyed _____ W

DATA AVAILABLE: Well data Freq. W/L meas.: Field aquifer char.

Hyd. lab. data: _____

Qual. water data; type: _____

Freq. sampling: _____ Pumpage inventory: yes no; period: _____

Aperture cards: _____ yes no

Log data: _____ D

WELL-DESCRIPTION CARD

SAME AS ON MASTER CARD Depth well: 389 ft 389 Meas. rept accuracy 3

Depth cased: 379 ft 379 Casing type: _____; Diam. 2 in

Finish: porous concrete, gravel w. (perf.), gravel w. (screen), horiz. open end, other _____ 5

Method Drilled: (A) air, (B) bored, (C) cable, (D) dug, (H) hyd jetted, (J) air rot., (P) air percussion, (R) reverse, (T) trenching, (V) driven, (W) drive wash, other _____ H

Date Drilled: 4/1/63 963 Pump intake setting: _____ ft

Driller: George Colville

Lift (type): (A) air, (B) bucket, (C) cent, (J) jet, (L) multiple, (M) multiple, (N) none, (P) piston, (R) rot, (S) submerg, (T) turb, other _____ J Deep Shallow

Power (type): nat, elec, gas, gasoline, hand, gas, wind; H.P. _____ 5 Trans. or meter no. _____

Descrip. MP _____ ft above 41 below LSD, Alt. MP _____

Alt. LSD: _____ Accuracy: (source) _____ 4

Water Level 7 ft above MP; Ft below LSD 7 Accuracy: _____ D

Date meas: 4/1/63 463 Yield: _____ gpm Method determined _____

Drawdown: _____ ft Accuracy: _____ Pumping period _____ hrs

WATER DATA: Iron _____ ppm Sulfate _____ ppm Chloride _____ ppm Hard. _____ ppm

Sp. Conduct _____ K x 10⁶ Temp. _____ °F Date sampled _____

Taste, color, etc. _____

Well No. M46

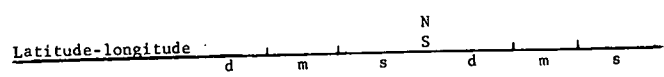

HYDROGEOLOGIC CARD

SAME AS ON MASTER CARD Physiographic Province: 03 Section: _____

D Drainage Basin: 13R Subbasin: _____

Topo of well site: (D) depression, stream channel, dunes, flat, hilltop, sink, swamp, (K) (L) (P) (S) (T) (U) (V) offshore, pediment, hillside, terrace, undulating, valley flat 27

MAJOR AQUIFER: TM aquifer, formation, group PA

Lithology: US Origin: 3 Aquifer Thickness: _____ ft

Length of well open to: _____ ft 10 Depth to top of: _____ ft 372

MINOR AQUIFER: _____ aquifer, formation, group _____

Lithology: _____ Origin: _____ Aquifer Thickness: _____ ft

Length of well open to: _____ ft _____ Depth to top of: _____ ft _____

Intervals Screened: 2"

Depth to consolidated rock: _____ ft _____ Source of data: _____

Depth to basement: _____ ft _____ Source of data: _____

Surficial material: _____ Infiltration characteristics: _____

Coefficient Trans: _____ gpd/ft _____ Coefficient Storage: _____

Coefficient Perm: _____ gpd/ft²; Spec cap: _____ gpm/ft; Number of geologic cards: _____

12 miles NE of Moss Point

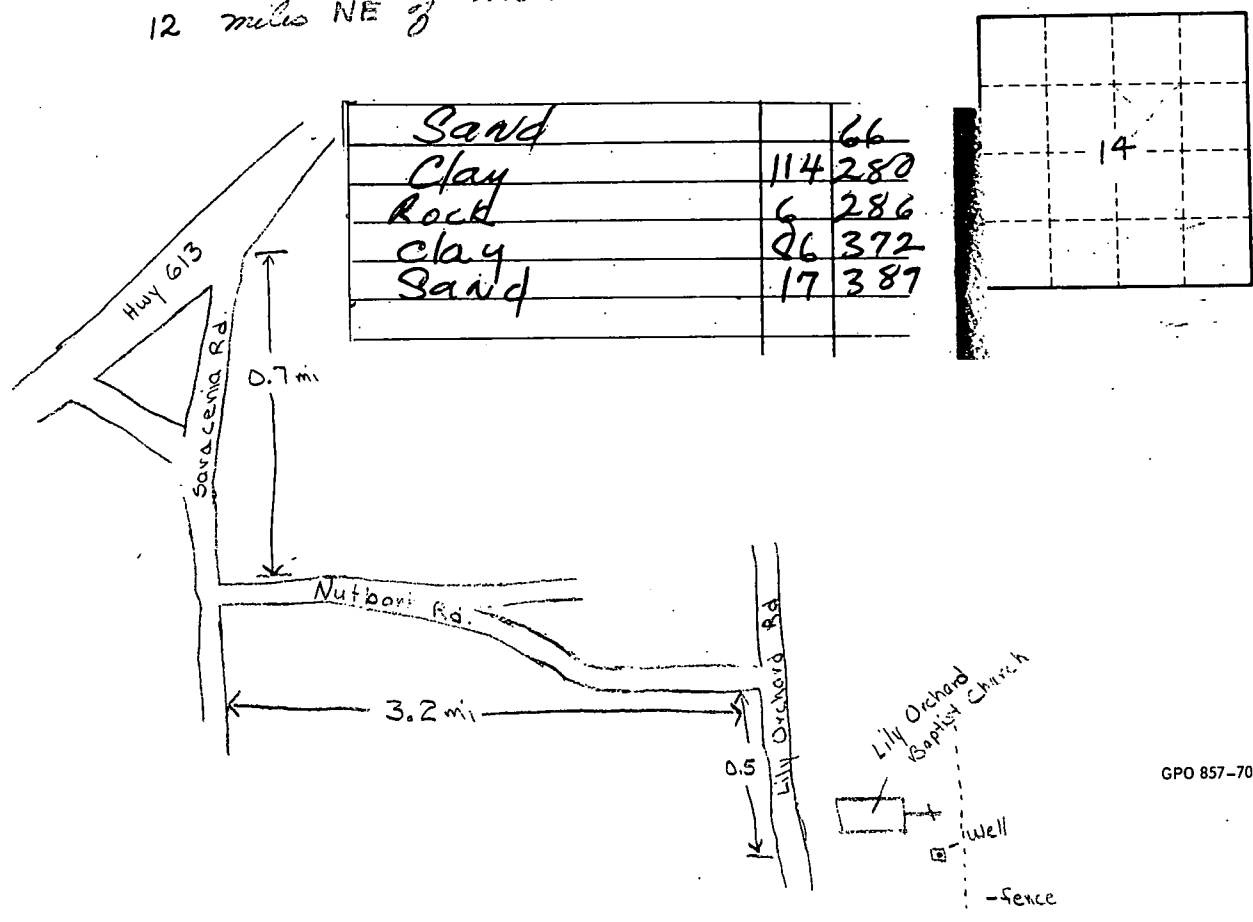

Well No. M46

