

PUNCHED and VERIFIED
ROLLA COMPUTATION BRANCH

WRD Exp. (GW)
April 1966

Well No. L20

WELL SCHEDULE

E log # 41

U. S. DEPT. OF THE INTERIOR

GEOLOGICAL SURVEY

WATER RESOURCES DIVISION

MASTER CARD

Record by T.N.S. Source of data Driller Date 11/25/58 Map _____

State 28 County (or town) JACKSON 30

Latitude: 30 deg 30 min 02 N Longitude: 088 degrees 33 min 08 sec Sequential number: 1

Lat-long accuracy: 2 T. 60 S. R. 60 Sec 43 NE 1 NW _____

Local well number: 4020AB43065D6W Other number: _____ B & H

Local use: 103 Owner or name: _____

Owner or name: FAIRLEY & BECKMAN Address: _____

Ownership: County, Fed Gov't, City, Corp or Co, Private, State Agency, Water Dist P

Use of water: (A) Air cond, Bottling, Comm, Dewater, Power, Fire, Dom, Irr, Med, Ind, P S, Rec, (S) Stock, Instit, Unused, Reppure, Recharge, Desal-P S, Desal-other, Other H

Use of well: (A) Anode, Drain, Seismic, Heat Res, Obs, Oil-gas, Recharge, Test, Unused, Withdraw, Waste, Destroyed W

DATA AVAILABLE: Well data Freq. W/L meas.: None Field aquifer char.

Hyd. lab. data: _____

Qual. water data; type: P

Freq. sampling: φ Eumpage inventory: yes no period: _____

Aperture cards: _____ yes

Log data: E

WELL-DESCRIPTION CARD

SAME AS ON MASTER CARD Depth well: 210 ft. Meas. 6

Depth cased (first perf.): 200 ft. Casing type: steel Diam. 1 in.

Finish: (C) concrete, (F) gravel w. concrete, (G) gravel w. (perf.), (H) horiz. oper. gallery, (φ) end, (P) perf., (S) screen, (T) sd. pt., (W) shored, (X) open hole, (Z) other S

Method: (A) air, (B) bored, (C) cable, (D) dug, (H) hyd jettted, (J) air rot., (P) percussion, (R) rotary, (T) reverse, (U) trenching, (V) driven, (W) drive wash, (Z) other H

Date Drilled: 958 Pump intake setting: _____ ft.

Driller: JACK GREEN

Lift (type): (A) air, (B) bucket, (C) cent, (J) jet, (L) multiple, (M) multiple, (N) none, (P) piston, (R) rot, (S) submerg, (T) turb, other J Deep Shallow

Power (type): nat diesel, elec, gas, gasoline, hand, gas, wind; H.P. S Trans. or meter no. _____

Descrip. MP _____ ft above LSD, Alt. MP _____

Alt. LSD: 18 Accuracy: (source) 4

Water Level: _____ ft. above MP; _____ ft. below LSD Accuracy: _____

Date meas: _____ Yield: _____ gpm Method determined: _____

Drawdown: _____ ft Accuracy: _____ Pumping period: _____ hrs

QUALITY OF WATER DATA: Iron _____ ppm Sulfate _____ ppm Chloride _____ ppm Hard. _____ ppm

Sp. Conduct _____ K x 10 6 Temp. 68 °F Date sampled: _____

Taste, color, etc. _____

Well No.

Well No. L20

Latitude-longitude N
S
d m s d m s

HYDROGEOLOGIC CARD

SAME AS ON MASTER CARD Physiographic Province: 03 Section:

D Drainage Basin: 130 Subbasin:

Topo of well site: (D) depression, stream channel, dunes, flat, hilltop, sink, swamp, (P) offshore, pediment, hillside, terrace, undulating, valley flat

MAJOR AQUIFER: TM series PA aquifer, formation, group

Lithology: 5 Origin: 3 Aquifer Thickness: ft
Length of well open to: ft 10 Depth to top of: ft

MINOR AQUIFER: series aquifer, formation, group

Lithology: Origin: Aquifer Thickness: ft
Length of well open to: ft Depth to top of: ft

Intervals Screened:

Depth to consolidated rock: ft Source of data: ft

Depth to basement: ft Source of data: ft

Surficial material: Infiltration characteristics: ft

Coefficient Trans: gpd/ft Coefficient Storage: ft

Coefficient Perm: gpd/ft²; Spec cap: gpm/ft; Number of geologic cards: ft

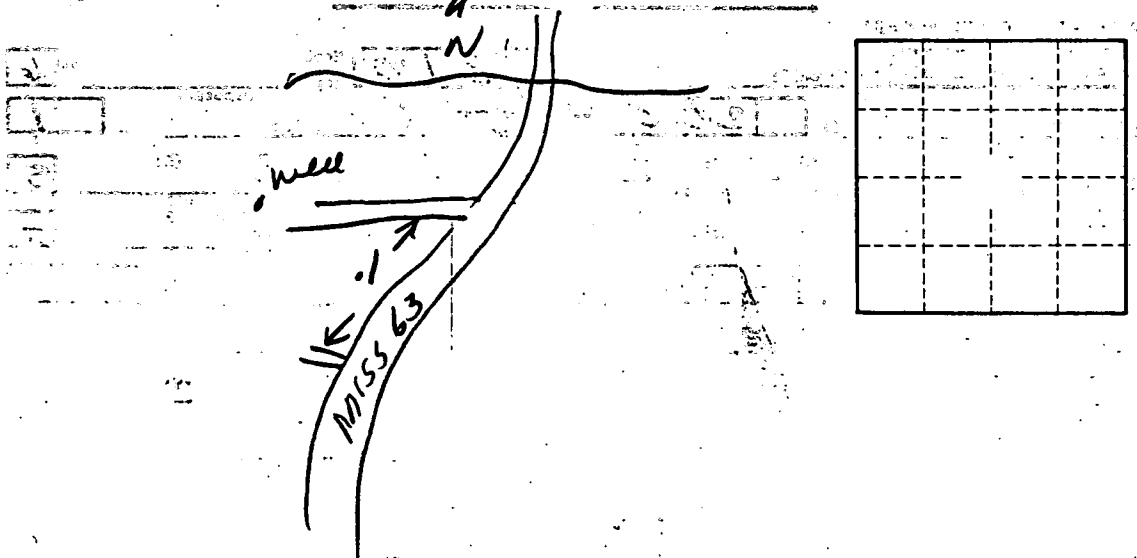

Well No.

L20