

PUNCHED and VERIFIED  
ROLLA COMPUTATION BRANCH

WRD Exp. (GW)  
April 1966

Well No. L4

WELL SCHEDULE  
GEOLOGICAL SURVEY

E Log #21  
WATER RESOURCES DIVISION

MASTER CARD

Record by T.N.S. Source of data Driller Date 8/19/58 Map \_\_\_\_\_

State 28 County (or town) JACKSON 30

Latitude: 303206N Longitude: 0883244 Sequential number: 7

Lat-long accuracy: 20 T. 6 S. R. 60 Sec 12 NW SE

Local well number: 40048D1206506W Other number: \_\_\_\_\_ B & M

Local use: 103 Owner or name: Escatawpa

Owner or name: H W HUDSON Address: \_\_\_\_\_

Ownership: (C) County, Fed Gov't, City, Corp or Co, Private, State Agency, Water Dist P

Use of water: (A) Air cond, Bottling, Comm, Dewater, Power, Fire, Dom, Irr, Med, Ind, P S, Rec, Stock, Instit, Unused, Recharge, Desal-P S, Desal-other, Other H

Use of well: (A) Anode, Drain, Seismic, Heat Res, Obs, Oil-gas, Recharge, Test, Unused, Withdraw, Waste, Destroyed W

DATA AVAILABLE: Well data  Freq. W/L meas.:  Field aquifer char.

Hyd. lab. data: \_\_\_\_\_

Qual. water data; type: \_\_\_\_\_

Freq. sampling: \_\_\_\_\_ Pumpage inventory: yes  no  period: \_\_\_\_\_

Aperture cards: \_\_\_\_\_ yes

Log data: \_\_\_\_\_ 0' - 252' EE

WELL-DESCRIPTION CARD

SAME AS ON MASTER CARD Depth well: 336 Meas. rept accuracy 6

Depth cased: 321 Casing type: Steel Diam. in 1

Finish: (C) porous concrete, (F) gravel w. (perf.), (G) gravel w. (screen), (H) horiz. gallery, (I) open perf., (J) screen, sd. pt., (K) shored, open hole, (L) other S

Method: (A) air bored, (B) cable, (C) dug, (D) hyd jetted, (E) air rot., (F) percussion, (G) rotary, (H) reverse trenching, (I) driven, (J) wash, (K) other H

Date Drilled: 958 Pump intake setting: \_\_\_\_\_ ft. \_\_\_\_\_

Driller: Green Water Well Co. address \_\_\_\_\_

Lift (type): (A) bucket, (B) cent, (C) jet, (D) multiple, (E) multiple, (F) none, (G) piston, (H) rot, (I) submerg, (J) turb, (K) other N Deep  Shallow

Power (type): (A) diesel, (B) elec, (C) gas, (D) gasoline, (E) hand, (F) gas, (G) wind; H.P.  Trans. or meter no. \_\_\_\_\_

Descrip. MP \_\_\_\_\_ above ft below LSD, Alt. MP \_\_\_\_\_

Alt. LSD: 76 Accuracy: (source) 4

Water Level +12 ft above MP; Ft below LSD +12 Accuracy: D

Date meas: 858 Yield: \_\_\_\_\_ gpm Method determined

Drawdown: \_\_\_\_\_ ft Accuracy: \_\_\_\_\_ Pumping period \_\_\_\_\_ hrs \_\_\_\_\_

QUALITY OF WATER DATA: Iron \_\_\_\_\_ ppm Sulfate \_\_\_\_\_ ppm Chloride \_\_\_\_\_ ppm Hard. \_\_\_\_\_ ppm

Sp. Conduct \_\_\_\_\_ K x 10<sup>6</sup> Temp. \_\_\_\_\_ °F Date sampled \_\_\_\_\_

Taste, color, etc. \_\_\_\_\_

Well No.

L4

Well No. 24

Latitude-longitude \_\_\_\_\_  
d m s N S d m s

HYDROGEOLOGIC CARD

SAME AS ON MASTER CARD 03 Physiographic Province: \_\_\_\_\_ Section: \_\_\_\_\_

D Drainage Basin: 13Q Subbasin: \_\_\_\_\_

Topo of well site: (D) depression, stream channel, dunes, flat, hilltop, sink, swamp, (E) offshore, pediment, hillside, terrace, undulating, valley flat (F) (R) (K) (L) (P) (S) (T) (U) (V) \_\_\_\_\_

MAJOR AQUIFER: TM system series \_\_\_\_\_ aquifer, formation, group PA

Lithology: US Origin: 3 Aquifer Thickness: \_\_\_\_\_ ft

Length of well open to: \_\_\_\_\_ ft Depth to top of: \_\_\_\_\_ ft

MINOR AQUIFER: \_\_\_\_\_ system series \_\_\_\_\_ aquifer, formation, group \_\_\_\_\_

Lithology: \_\_\_\_\_ Origin: \_\_\_\_\_ Aquifer Thickness: \_\_\_\_\_ ft

Length of well open to: \_\_\_\_\_ ft Depth to top of: \_\_\_\_\_ ft

Intervals Screened: \_\_\_\_\_

Depth to consolidated rock: \_\_\_\_\_ ft Source of data: \_\_\_\_\_

Depth to basement: \_\_\_\_\_ ft Source of data: \_\_\_\_\_

Surficial material: \_\_\_\_\_ Infiltration characteristics: \_\_\_\_\_

Coefficient Trans: \_\_\_\_\_ gpd/ft \_\_\_\_\_ Coefficient Storage: \_\_\_\_\_

Coefficient Permi: \_\_\_\_\_ gpd/ft<sup>2</sup>; Spec cap: \_\_\_\_\_ gpm/ft; Number of geologic cards: \_\_\_\_\_

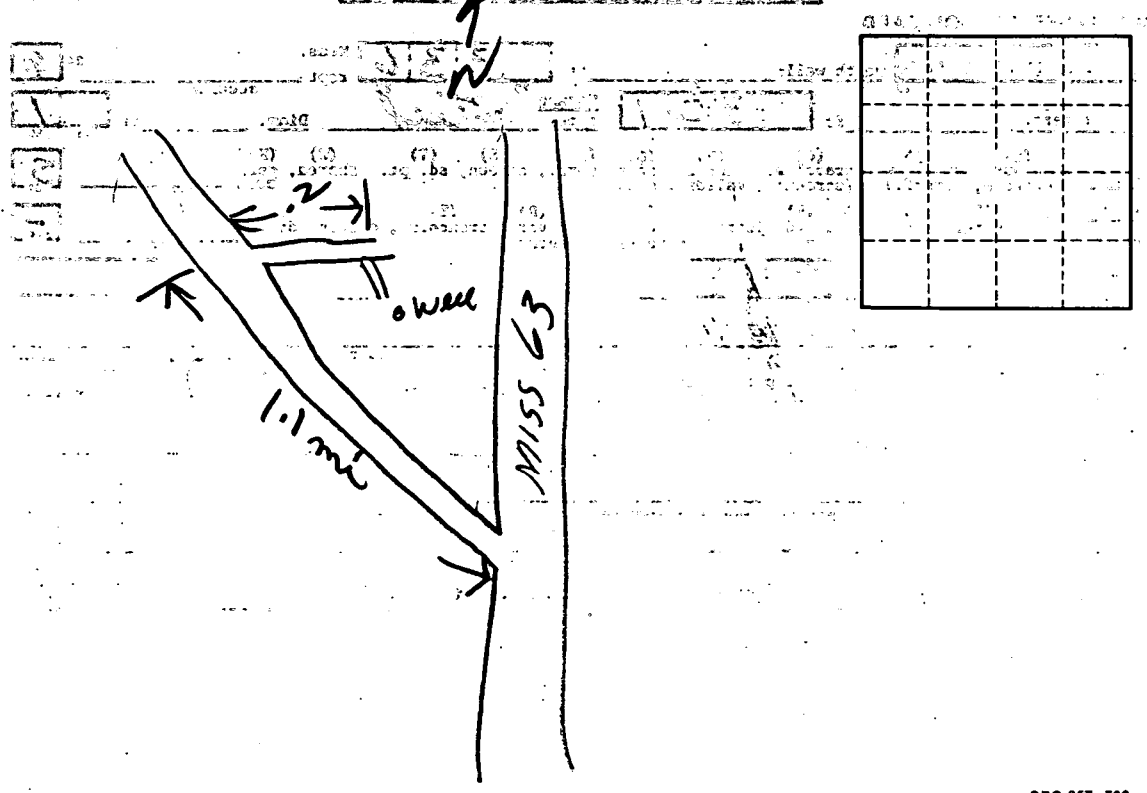

Well No.

24

WATER QUALITY DATA REPORT