

52
9-185
(October 1950)

sec. 36

0.434 49
578 800
1300 138.00
1388
UNITED STATES
DEPARTMENT OF THE INTERIOR
GEOLOGICAL SURVEY
WATER RESOURCES DIVISION

WELL SCHEDULE

Date 7-27-1960 Field No. K37
Record by F.N. SHOWS Office No. K69
Source of data O.T. SWITZER

1. Location: State MISS County JACKSON
Map PASCAGOULA Quad
SW 1/4 SE 1/4 sec. 36 T 6 NR 7 E W
2. Owner: LESTER MALLETTE Address SINGSING RIVER GRADENS
Tenant _____ Address _____
Driller O.T. SWITZER (DAY) Address GULFPORT, MISS

3. Topography _____
4. Elevation +10 ft. above MSL MSL
5. Type: Dug (drilled), driven, bored, jetted 7-22-60
6. Depth: Rept. 1352 ft. Meas. _____ ft.
7. Casing: Diam. 2 in., to _____ in., Type _____
Depth _____ ft., Finish 010-S.S.



8. Chief Aquifer _____ From _____ ft. to _____ ft.
Others _____

9. Water level 7.7 ft. rept 2-22-1960 above MSL
_____ which is _____ ft. below surface

10. Pump: Type _____ Capacity _____ G. M.
Power: Kind _____ Horsepower _____

11. Yield: Flow 50 G. M., Pump _____ G. M., Meas. Rept Est.
Drawdown _____ ft. after _____ hours pumping _____ G. M.

12. Use: (Dom., Stock) PS., RR., Ind. (Irr.) Obs. _____
Adequacy, permanence _____

13. Quality _____ Temp 87 °F.
Taste, odor, color _____ Sample Yes 1 liter
Unfit for _____ No 10-11-60

14. Remarks: (Log, Analyses, etc.) _____

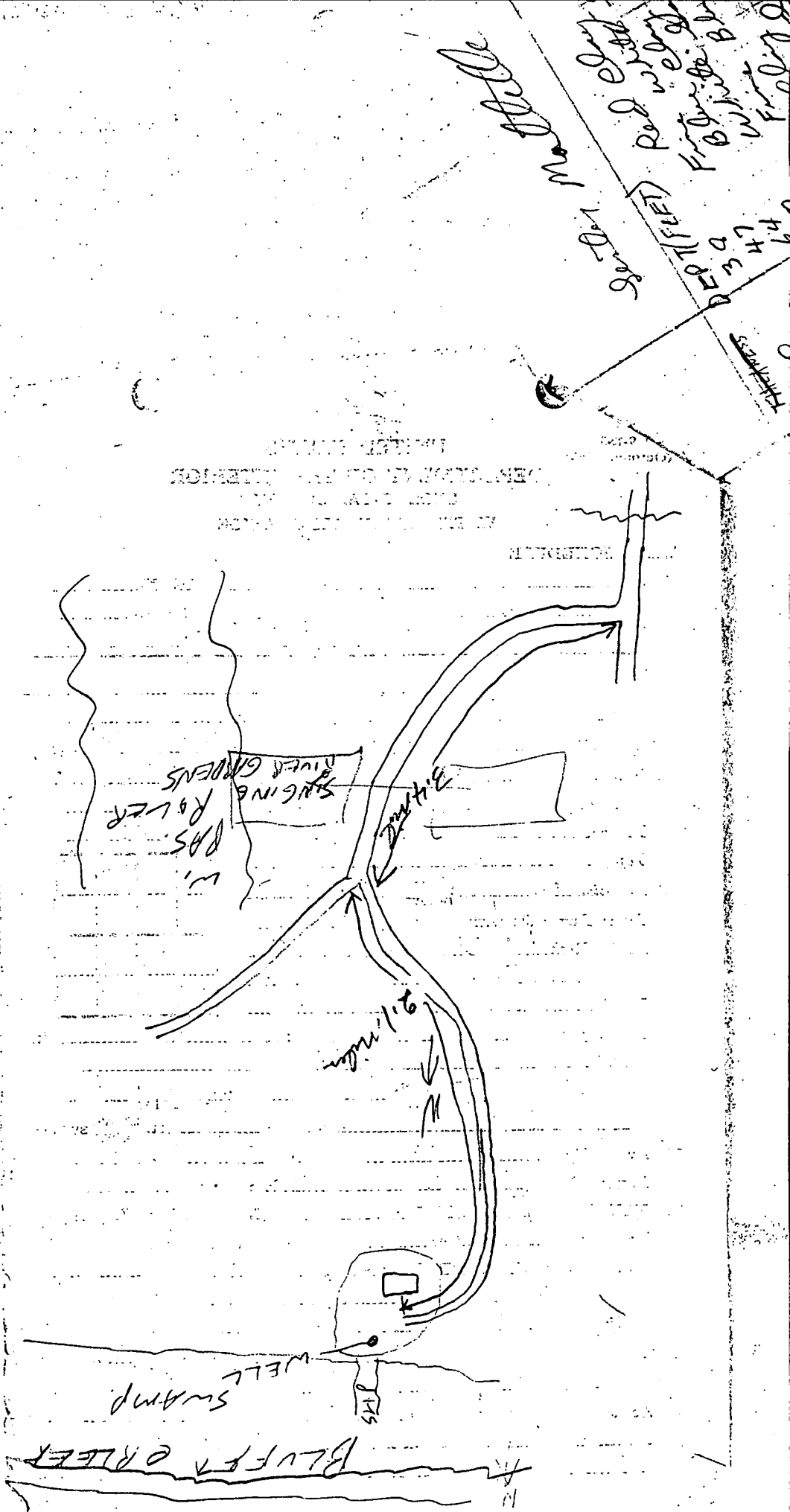

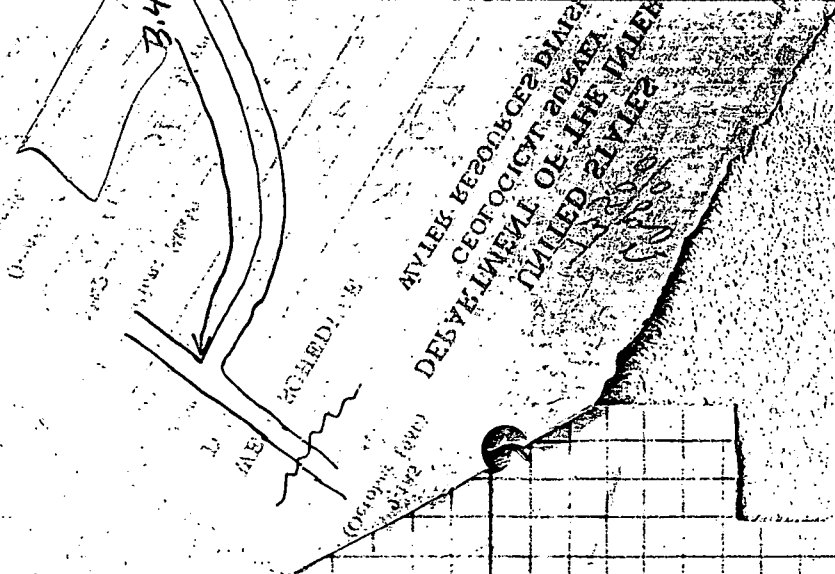

Senter Matille

THICKNESS	DEPT (FEET)	DESCRIPTION	THICKNESS
0	39	Red Clay	
38	47	Fine white sand	
47	64	Blue clay	
64	78	White sand	
78	89	Fine Blue sand	
89	98	Clay	
98	134	sand,	
134	266	Clay	
266	277	sand	11'
277	286	Clay	
286	294	Stratified	19.0'
294	467	Clay	
467	472	sand	5'
472	566	clay	94'
566	583	sand, fair	17'
583	805	Clay	222'
805	819	sand, good	14'
819	864	Clay	
864	868	sand	4'
868	869	Rock	240'
869	1108	Clay	
1108	1125	sand, fair	17'
1125	1304	Clay	179
1304	1350	sand, med good	46'