

9-185-July 1935
Revised

UNITED STATES
DEPARTMENT OF THE INTERIOR
GEOLOGICAL SURVEY
WATER RESOURCES BRANCH

15.1
6.9 below
M.P. 7/13

WELL SCHEDULE

Date Mar 4, 1939 Field No. 47
Record by E. W. Reed Office No. 715
Source of data Mr. Crutcher J32

1. Location: State Miss County Jackson
Map Northfield
NE 1/4 SE 1/4 sec. 27 T 6 N 9 S 9 W W
2. Owner: Geo. Crutcher Address Ocean Sp. Bldg
Tenant _____ Address _____
Driller Atlas Well Drill Address _____

3. Topography slope
4. Elevation 52.00 ft. above datum.
5. Type: Dug (drilled, driven, bored, jetted) 19.27
6. Depth: Rept. 92.5 ft. Meas. _____ ft.
7. Casing: Diam. 2 in., to _____ in., Type B. 1
Depth 90.5 ft., Finish 20' strainer

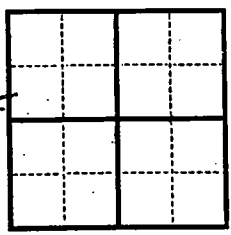

8. Chief Aquifer _____ From _____ ft. to _____ ft.
Others _____
9. Water level 28.2 ft. meas May 4 1939 above top
of tree which is 1 ft. above surface

10. Pump: Type _____ Capacity _____ G. M.
Power: Kind _____ Horsepower _____
11. Yield: Flow _____ G. M., Pump _____ G. M., Meas., Rept. Est. _____
Drawdown _____ ft. after _____ hours pumping _____ G. M.

12. Use: Dom., Stock PS., RR., Ind., Irr., Obs. Dairy
Adequacy, permanence Noted slight decrease
13. Quality Good Temp _____ °F.
Taste, odor, color Sulfur Sample Yes
Unfit for _____

14. Remarks: (Log, Analyses, etc.) 40' head when drilled
50' above Flowing through pipe over
10 ft above ground 2-27-59 E.H.

MP. not marked

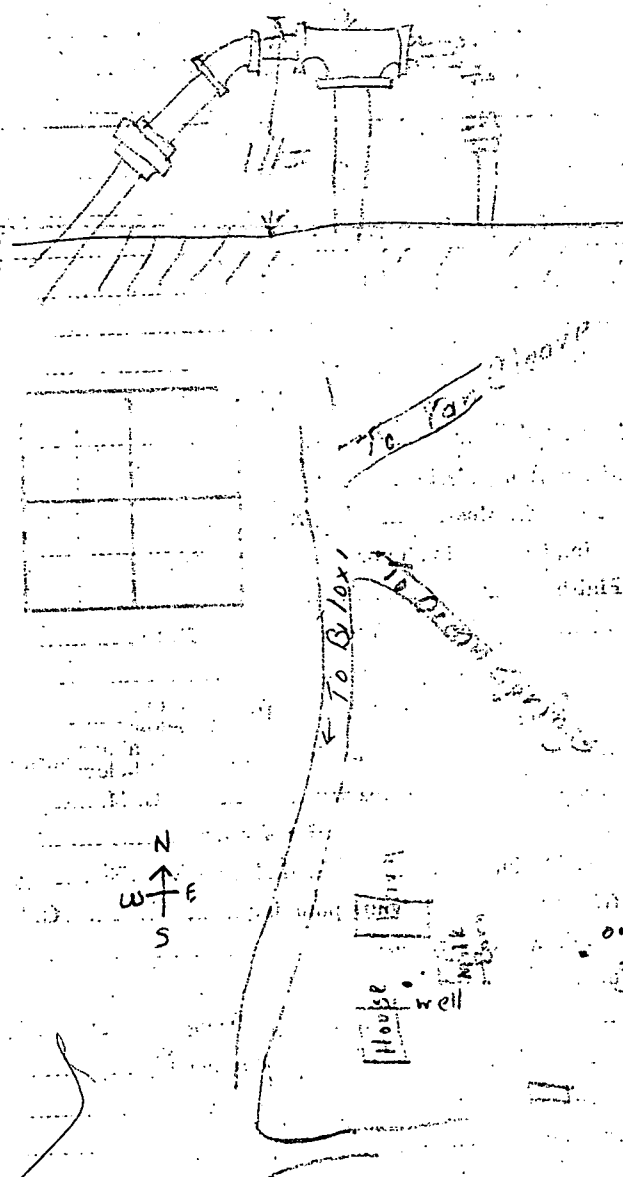

N
 ↑
 W — E
 ↓
 S

over flow
 gauge here