

PUNCHED and VERIFIED  
ROLLA COMPUTATION SERVICE

WRD Exp. (GW)  
April 1966

Well No. H19

303523088290701  
WELL SCHEDULE

U. S. DEPT. OF THE INTERIOR

GEOLOGICAL SURVEY

WATER RESOURCES DIVISION

03170008-4102 WJW  
MASTER CARD

Record by J. HARRELL Source of data BOWC Date 4/9/68 Map 2

State 28 County JACKSON (or town) 30

Latitude: 3035 5 N Longitude: 0882907 Sequential number: 1

Lat-long accuracy: 4 T. 5 S. R. 5 W. Sec 21, SW, SE

Local well number: H019CD2105505W Other number: B & M

Local use: 006 Owner or name: GUY D GOFF

Owner or name: GUY D GOFF Address: BIG POINT, MISS.

Ownership: County, Fed Gov't, City, Corp or Co, Private, State Agency, Water Dist P

Use of Air cond, Bottling, Comm, Dewater, Power, Fire, Dom, Irr, Med, Ind, P S, Rec, water: H

Use of (S) (T) (U) (V) (W) (X) (Y) (Z) Stock, Instit, Unused, Repressure, Recharge, Desal-P S, Desal-other, Other H

Use of (A) (D) (G) (H) (I) (J) (K) (L) (M) (N) (O) (P) (R) (T) (U) (W) (X) (Z) well: Anode, Drain, Seismic, Heat Res, Obs, Oil-gas, Recharge, Test, Unused, Withdraw, Waste, Destroyed W

DATA AVAILABLE: Well data  Freq. W/L meas.:  Field aquifer char.

Hyd. lab. data:

Qual. water data; type: USGS 4/70

Freq. sampling:  Pumpage inventory:  no, period:

Aperture cards:  yes

Log data:  D

WELL-DESCRIPTION CARD

SAME AS ON MASTER CARD Depth well: 263 ft 263 Meas. accuracy 3

Depth cased; (first perf.): 253 ft 253 Casing type: 1/4 in 1

Finish: (C) porous concrete, (F) gravel w. (perf.), (G) gravel w. (screen), (H) horiz. gallery, (I) open end, (J) perf., (K) screen, (L) sd. pt., (M) shored, (N) open hole, (O) other 5

Method Drilled: (A) air rot, (B) bored, (C) cable, (D) dug, (E) hyd rot., (F) jetted, (G) air percussion, (H) reverse, (I) trenching, (J) driven, (K) drive wash, (L) other 4

Date Drilled: 8/3/62 962 Pump intake setting: 36 ft 38

Driller: Film Colville

Lift (type): (A) air, (B) bucket, (C) cent, (D) jet, (E) multiple, (F) multiple, (G) none, (H) piston, (I) rot, (J) submerg, (K) turb, (L) other J Deep 39 Shallow 40

Power (type): (A) diesel, (B) elec, (C) gas, (D) gasoline, (E) hand, (F) gas, (G) wind, (H) H.P. S Trans. or meter no. 41

Descrip. MP 71 ft above LSD: Alt. MP 71

Alt. LSD: 65 Accuracy: 47 4

Water Level: 20 ft above below MP; 20 Accuracy: 52 D

Date meas: 8/3/62 862 Yield: 60 gpm 61 Method determined 61

Drawdown: 62 ft 64 Accuracy: 65 Pumping period 66 hrs 68

QUALITY OF WATER DATA: Iron 69 Sulfate 70 Chloride 71 Hard. 72

Sp. Conduct 73 K x 10 74 Temp. 75 Date sampled 76 77 79

Taste, color, etc. 78

Well No. H19

Latitude-longitude d m s d m s

HYDROGEOLOGIC CARD

SAME AS ON MASTER CARD Physiographic Province: 03 Section: \_\_\_\_\_

D Drainage Basin: 130 Subbasin: \_\_\_\_\_

Topo of well site: (D) depression, stream channel, dunes, flat, hilltop, sink, swamp, (E) (F) (H) (K) (L) (M) (P) (S) (T) (U) (V) offshore, pediment, hillside, terrace, undulating, valley flat \_\_\_\_\_

MAJOR AQUIFER: TM system \_\_\_\_\_ series \_\_\_\_\_ aquifer, formation, group MZ

Lithology: US Origin: 3 Aquifer Thickness: \_\_\_\_\_ ft

Length of well open to: \_\_\_\_\_ ft Depth to top of: \_\_\_\_\_ ft

MINOR AQUIFER: \_\_\_\_\_ system \_\_\_\_\_ series \_\_\_\_\_ aquifer, formation, group \_\_\_\_\_

Lithology: \_\_\_\_\_ Origin: \_\_\_\_\_ Aquifer Thickness: \_\_\_\_\_ ft

Length of well open to: \_\_\_\_\_ ft Depth to top of: \_\_\_\_\_ ft

Intervals Screened: 1/4

Depth to consolidated rock: \_\_\_\_\_ ft Source of data: \_\_\_\_\_

Depth to basement: \_\_\_\_\_ ft Source of data: \_\_\_\_\_

Surficial material: \_\_\_\_\_ Infiltration characteristics: \_\_\_\_\_

Coefficient Trans: \_\_\_\_\_ gpd/ft Coefficient Storage: \_\_\_\_\_

Coefficient Perm: \_\_\_\_\_ gpd/ft<sup>2</sup>; Spec cap: \_\_\_\_\_ gpm/ft; Number of geologic cards: \_\_\_\_\_

93/714 =  
122 PPG

1/2 M. N. BIG POINT

1/13/90  
PH

0-21 clay
21-30 clay
30-42 sand
42-53 sandy clay
53-84 sandy clay
84-105 sandy clay
105-126 clay
126-133 clay
133-147 shales
147-168 Hard clay
168-189 clay
189-210 sandy clay
210-221 sand
221-241 sand
241-252 sand
252-263 sand
TD

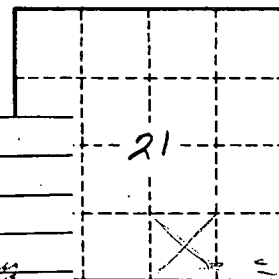

Well No.

H14

