

WELL SCHEDULE

U. S. DEPT. OF THE INTERIOR

GEOLOGICAL SURVEY

WATER RESOURCES DIVISION

PUNCHED AND VERIFIED
WELL INFORMATION BRANCH

MASTER CARD

Record by _____ Source of data _____ Date _____ Map _____

State 29 County (or town) Tackson 30

Latitude: 304105 N 0882 W Longitude: 0882 W Sequential number: 1

Lat-long accuracy: 2 T. 4 S. R. 5 E. Sec 22, SE $\frac{1}{4}$, NW $\frac{1}{4}$

Local well number: D019DBZ204505W Other number: _____ B & M

Local use: LINK Owner or name: _____

Owner or name: HOMER GOFF Address: _____

Ownership: County, Fed Gov't, City, Corp or Co, Private, State Agency, Water Dist P

Use of water: (A) Air cond, (B) Bottling, (C) Comm, (D) Dewater, (E) Power, (F) Fire, (G) Dom, (H) Irr, (I) Med, (J) P S, (K) Rec, (L) Stock, (M) Instit, (N) Unused, (O) Repressure, (P) Recharge, (Q) Desal-P S, (R) Desal-other, (S) Other H

Use of well: (A) Anode, (B) Drain, (C) Seismic, (D) Heat Res, (E) Obs, (F) Oil-gas, (G) Recharge, (H) Test, (I) Unused, (J) Withdraw, (K) Waste, (L) Destroyed W

DATA AVAILABLE: Well data Freq. W/L meas.: Field aquifer char.

Hyd. lab. data: _____

Qual. water data; type: _____

Freq. sampling: _____ Pumpage inventory: yes, no, period: _____

Aperture cards: _____ yes

Log data: _____ 78 79

WELL-DESCRIPTION CARD

SAME AS ON MASTER CARD Depth well: 23 ft Meas. rept accuracy 0

Depth cased: _____ ft Casing type: _____; Diam. _____ in

Finish: (C) porous concrete, (F) gravel w. (perf.), (G) gravel w. (screen), (H) horiz. gallery, (I) open end, (J) perf., (K) screen, (L) sd. pt., (M) shored, (N) open hole, (O) other S

Method: (A) air rot, (B) bored, (C) cable, (D) dug, (E) hyd rot., (F) jetted, (G) air percuss, (H) rotary, (I) reverse, (J) trenching, (K) driven, (L) drive wash, (M) other V

Date Drilled: _____ Pump intake setting: _____ ft

Driller: _____ name _____ address _____

Lift (type): (A) air, (B) bucket, (C) cent, (D) jet, (E) multiple (cent.), (F) multiple (turb.), (G) none, (H) piston, (I) rot, (J) submerg, (K) turb, (L) other Deep Shallow

Power (type): (A) diesel, (B) elec, (C) gas, (D) gasoline, (E) hand, (F) gas, (G) wind; H.P. Trans. or meter no. _____

Descrip. MP _____ ft above LSD, Alt. MP _____

Alt. LSD: 90 Accuracy: (source) 4

Water Level 17.70 ft above MP; Ft below LSD 18 Accuracy: _____

Date meas: 860 Yield: _____ gpm Method determined _____

Drawdown: _____ ft Accuracy: _____ Pumping period _____ hrs

QUALITY OF WATER DATA: Iron _____ ppm Sulfate _____ ppm Chloride _____ ppm Hard. _____ ppm

Sp. Conduct _____ K x 10 6 Temp. _____ °F Date sampled _____

Taste, color, etc. _____

Well No.

D19

Latitude-longitude N
S
d m s d m s

HYDROGEOLOGIC CARD

SAME AS ON MASTER CARD Physiographic Province: 03 Section: _____

D Drainage Basin: 13R Subbasin: _____

Topo of well site: (D) depression, stream channel, dunes, flat, hilltop, sink, swamp, (C) (E) (F) (H) (K) (L) (P) (S) (T) (U) (V) _____

offshore, pediment, hillside, terrace, undulating, valley flat _____

MAJOR AQUIFER: _____ system _____ series TIP _____ aquifer, formation, group CI

Lithology: _____ Origin: _____ Aquifer Thickness: _____ ft

Length of well open to: _____ ft _____ Depth to top of: _____ ft _____

MINOR AQUIFER: _____ system _____ series _____ aquifer, formation, group _____

Lithology: _____ Origin: _____ Aquifer Thickness: _____ ft

Length of well open to: _____ ft _____ Depth to top of: _____ ft _____

Intervals Screened:

Depth to consolidated rock: _____ ft _____ Source of data: _____

Depth to basement: _____ ft _____ Source of data: _____

Surficial material: _____ Infiltration characteristics: _____

Coefficient Trans: _____ gpd/ft _____ Coefficient Storage: _____

Coefficient Perm: _____ gpd/ft²; Spec cap: _____ gpm/ft; Number of geologic cards: _____

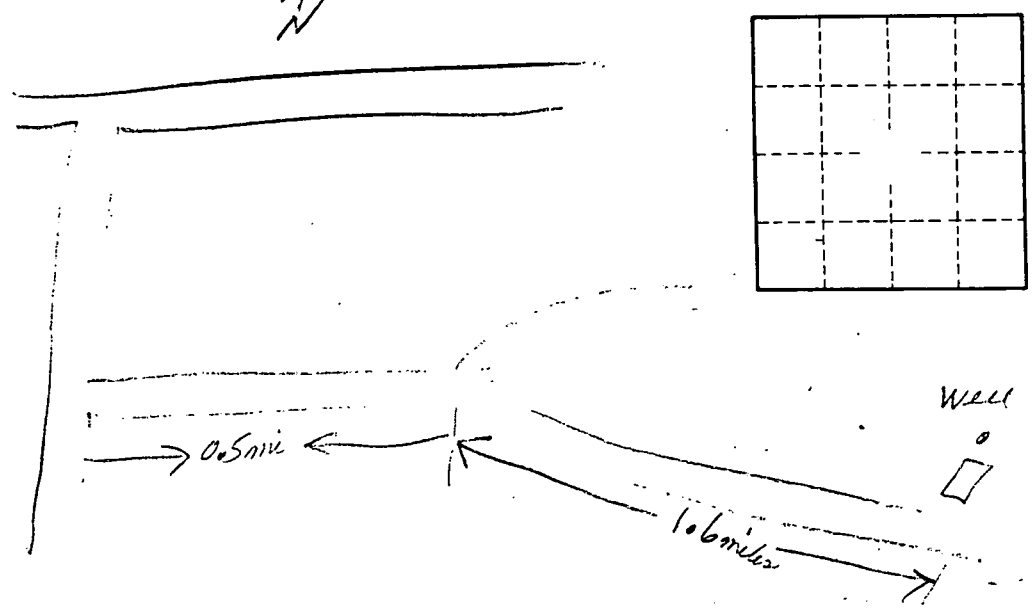

Well No.

D19