

HYDROLOGICAL SURVEY
WATER RESOURCES DIVISION
MISSISSIPPI DISTRICT
WELL RECORD

TRANSMISSION

Log No. 173
County LIAWANBA

DOI# 290010-02

GPSd 6/9/99 AH/MO

GW12193

GEN. SITE DATA

Site ID 3.4.1.4.2.4.0.8.8.1.5.2.8.0.1 R=0* T=A* 2=W*

Data reliab. C Report agency 4-USGS* Dist. 6-28* 7-28* Co. 057

Lat. Long. / 9-34.1.42.4 * 10-088.15.2.8 * Well No. 12-MO.0.7

Location NW 1/4 Sec 10, T.4N, R.10W Alt. 16-420 *

Hyd. Unit (O/B/C) 20- * Date 21-12-28-1979

Well use 23-W * 24-P * Hole depth 27-15.5 * Well depth 28-150 *

WL 30-76 * Date 31-12-28-1979 * Source 33-D *

Status 273 * Project No. 5- *

OWNER

R=158* T=A* Date 159# 12-28-1979 * Owner No. WU#2

Owner 161-TRENTON, GA

FIELD QW

R=192* T=A* Date 193# * Temp. 196#00010* 197-

R=192* T=A* Date 193# * Cond. 196#00095* 197-

R=192* T=A* Date 193# * pH 196#00400* 197-

CONSTR.

R=58* T=A* Date 60-12-29-1979 * Remarks

Drlg. 63-360 * Name Hendon Method 65-H * Finish 66-S *

CASING

R=76* T=A* 3914 * Steel

Top csgn. 77-11.0 * Bot. csgn. 78-11.8 * Diam. 79#-1.0 *

R=76* T=A* 3914 *

Top csgn. 77- * Bot. csgn. 78- * Diam. 79- *

OPENINGS

R=82* T=A* 5914 * Top 83-11.8 * Bottom 84-14.0 *

Type 85-3 * Diam. 87-1.6 * Size 88- *

R=82* T=A* 5914 * Top 83- * Bottom 84- *

Type 85- * Diam. 87- * Size 88- *

YIELD

R= 146 * 147# * 150-15.1 * 272-

134 flows 346 pumped

R-42* T-A-A* Lift type 43* Intake 44- * Power type

Date 38- 12/10/8/1979 H.P. 46- 7.5*

R-198* T-A-A* Log 199* Top 200- 2. * Bot 201- 5.1

R-198* T-A-A* Log 199* Top 200- 10. * Bot 201- 5.2

R-189* T-A-A* E. Log No. 190* 073* 191- V T S S D I S

R-114* T-A-A* Year 115* Type 120-

R-90* T-A-A* 256* Top 91- 100. * Bot 92- 155-

Unit ID 93- Z (BORD) Name of Unit

R-90* T-A-A* 256* Top 91- * Bot 92-

Unit ID 93- Name of Unit

R-98* T-A-A* 99* Unit tested 100- 105-

R-105* T-A-A* 99* Test No. 106*

107- Transmissivity (gal/d)/ft

108- Hydraul cond. (gal/d)/ft

110- Storage coeff. Boundaries

R-121* T-A-A* Begin 122* Network 258- *

Water Level Data Collection (1)

9.39 gal/ft reported

description of formations encountered	from	to
Clay	0	5
Clay Gravel	5	15
Coarse red & gravel sand	15	37
Brown clay & sand rock	37	42
White chalk & Blue Sand	42	55
Coarse yellow sand	55	63
Coarse red sand & white Chalk	63	100
Gravel	100	137
Sand	137	155
Rock	155	

ITAWAMBA
M-7
12-28-79

MISSISSIPPI
BOARD OF WATER COMMISSIONERS
416 North State Street
Jackson, Mississippi 39201

CODED

WATER WELL DRILLERS LOG

Herndon Well & Supply Co. Itawamba

date well completed 19 _____ firm name _____ county well located _____

LANDOWNER: Tremont, Town of	description of formations encountered	from	to
Well #2			
Tremont, MS 38876 (mailing address)	Clay	0	5
WELL LOCATION:	Clay Gravel	5	15
sec. 4 T 10 N R 10 E Inside town of Tremont (distance) miles (direction) of (nearest town)	Coarse red & gravel sand	15	37
WELL PURPOSE: Municipal (home, irrigation, municipal, industrial)	Brown clay & sand rock	37	42
WELL COMPLETION DATA:	White chalk & Blue Sand	42	55
(1) diameter (inches) 10"	Coarse yellow sand	55	63
(2) total depth (feet) 150'	Coarse red sand & white Chalk	63	100
(3) static water level (feet) 76 below top of ground.	Gravel	100	137
(4) casing Steel 123 (material) (depth) 10" (size) If telescope see back.	Sand	137	155
(5) screen 32' 118' (length) (depth to top) 6" Stainless Ribbed (size) (material)	Rock	155	
(6) pump 7 1/2 1760 151 (HP) (yield gpm) Elec. @ #15 (type power)			
(7) electric log yes (yes or no) MSGS (organization running log)			
(8) how well bottom plugged BWV			
DRILLERS REMARKS: 9.3 gpm/ft.			

CODED

DEPT. OF REVENUE & RESOURCES
BUREAU OF WATER RESOURCES

MAY 19 1980

RECEIVED

(7)

NE1/4, NW1/4, SW1/4

If well telescopes please sketch and show depths.

GROUND LEVEL

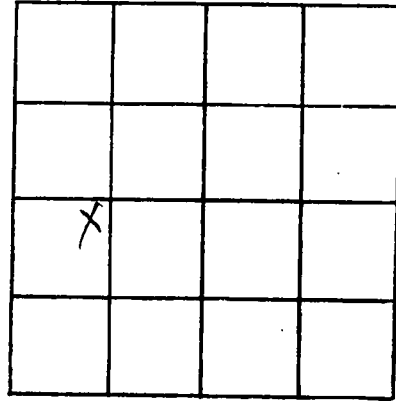

SECTION 4

Please indicate well location X.

ADDITIONAL INFORMATION

If more than one screen, show locations of each on sketch.

ESD

Issued: <u>8-22-89</u>	Expires: <u>8-22-99</u>	Fee Paid	<input checked="" type="checkbox"/>	Permit No. <u>6W-12193</u>
Lat. <u>34-14-24</u>	Long. <u>88-15-29</u>	Elev. <u>400</u>		USGS No.
Quad. <u>Tremont</u>	Dist.			Basin No. <u>03160101</u>
STAC				Dam inv. No.
				Dam appl. No.

Dept. of Natural Resources, Bureau of Land and Water Resources, P.O. Box 10631, Jackson, MS 39289-0631

**APPLICATION FOR PERMIT TO DIVERT OR WITHDRAW FOR BENEFICIAL USE
THE PUBLIC WATERS OF THE STATE OF MISSISSIPPI**

RECEIVED

This application is for (circle one): GROUNDWATER SURFACE WATER

JUL 10 1989

Beneficial Use (circle one or more): Irrigation Fish Culture Municipal Rural Water Association Industrial Recreation Institutional (Examples: Church, School) Commercial (Examples: Hotel, Restaurant) Livestock Water Standby Fire Protection Flood Protection Other: _____

LANDOWNER:

Tremont, Mississippi (Tremont Water Association) 029-02485-8
(Name) (S/S or Tax ID No.)

P. O. Box 8
(Address)

Tremont, MS MS 38876 (601) 652 - 3366
(City) (State and Zip) (Telephone Number)

APPLICANT, AGENT, OR LESSEE (If different from Landowner):

Tremont Water Association 029-02485-8
(Name) (S/S or Tax ID No.)

P. O. Box 8
(Address)

Tremont MS 38876 (601) 652 - 3366
(City) (State and Zip) (Telephone Number)

Location of diversion/withdrawal point (A suitable location map must accompany this application):

Located in Sections 4 & 5
NE 1/4 of the SW 1/4 of Section 4, Township 10 S, Range 10 E, County Itawamba

Volume of water diverted/withdrawn (Choose "a", "b", "c", or "d" ["d" is for units other than those shown in "a", "b", or "c"]):

(a) _____ acre-feet per year at a maximum rate of _____ gallons per minute

(b) 0.04 ~~46,120 thousand~~ million gallons per day at a maximum rate of 151 gallons per minute

(c) _____ acre feet of storage at normal pool

(d) _____ per _____ at a maximum rate of _____

Construction of proposed work will begin on (date) _____, 19____ and will be completed by (date) _____, 19____.

Water will be used from (month) January to (month) December each year.

Does the land to which this application pertains have any source(s) of water other than that for which you are now applying (circle one)?
YES NO If yes, describe the nature and amount of any additional supply and, if applicable, list permit numbers.

SECTION A (to be completed if application is for surface water source)

Not applicable

1. Source of water is from _____ which drains into _____ which drains into _____ which drains into _____

2. Description of pump/diversion works:

(a) Pump (size and type): _____ Power Unit (size and type): _____

Lift: _____ feet Maximum capacity: _____ gallons per minute.

(b) Name of storage reservoir: _____ Dam height: _____ feet.

Surface area at normal pool: _____ acres. Storage capacity at normal pool: _____ acre-feet.

(Continued on back)

SECTION B (to be completed if application is for groundwater source)

1. Source of water is ground water Gordo aquifer.
2. Description of proposed water well:
- (a) DEPTH OF WELL: 150 feet. DRILLER (name): Herndon Well Supply
- (b) SURFACE CASING: Length: 150 feet. Diameter: 10 inches. Type: Steel
- (c) SCREEN: Length: 32 feet. Diameter: 6 inches. Type: Stainless Steel
- (d) PUMP: Type: Oil Lube AU. Size: 6". Capacity: 151 gallons per minute.
Number of stages: 11 Setting depth: 10 feet.
- (e) POWER UNIT: Type: Electric. Size: 7 1/2 horsepower.
- (f) TYPE OF COMPLETION: gravel wall

WATER USE DATA:

If for IRRIGATION, FISH CULTURE or any other areal use, show the number of acres to which water will be applied in the appropriate 40-acre block(s). Acreage must be shown on accompanying location map.

Not applicable

TOWN-SHIP	RANGE	SEC-TION	NE1/4				NW1/4				SW1/4				SE1/4				TOTALS
			NE1/4	NW1/4	SW1/4	SE1/4	NE1/4	NW1/4	SW1/4	SE1/4	NE1/4	NW1/4	SW1/4	SE1/4	NE1/4	NW1/4	SW1/4	SE1/4	
			0	0	0	0	0	0	0	0	0	0	0	0	0	0	0	0	0

Not applicable

1. IRRIGATION: List the number of acres of each crop to be irrigated: Rice 0; Cotton 0; Soybeans 0; Corn 0; Pasture 0; Truck 0; Wheat 0; Oats 0; Grain sorghum 0; Other (specify) _____ Acres _____

2. FISH CULTURE: Explain how water will be used: Not applicable

How often will reservoir(s) be emptied and refilled? Not applicable

3. MUNICIPAL or WATER ASSOCIATION

Choose "a" or "b". (a) The number of people served is _____. (b) The number of connections/customers is 264.

What is the estimated average daily consumption during periods of maximum use at the end of each five-year period during the next twenty years? 46,120 1994; 46,120 1999; 46,120 2004; 46,120 2009
(Volume) (Year) (Volume) (Year) (Volume) (Year) (Volume) (Year)

4. INDUSTRIAL: If water is to be released into a watercourse, indicate the amount released each year 0;

Rate of release _____; Location of release point in reference to diversion/withdrawal point _____

_____ ; Explain any change in quality of water to be released: _____

NPDES Permit No. _____

Explain how water will be used: _____

How much groundwater will be used for once-through non-contact cooling? _____

5. RECREATION: Explain how water will be used: Not applicable

6. OTHER use: Explain in detail: _____

REMARKS: _____

List below the person to be contacted for additional information if required:

Jerry Grady
(Name)
P. O. Box 104
(Address)
Tremont, MS 38876
(City, State, Zip)
652-3366
(Telephone)

The accompanying map is hereby declared a part of this application. The TEN DOLLAR (\$10.00) permit fee is enclosed herewith.

Jerry Grady
(Signature)

Subscribed and sworn to before me this 5th day of June 1989, at Fulton

County of Itawamba. My commission expires Commission Expires March 6, 1993

Sandy Parker, Notary Public

DEPARTMENT OF ENVIRONMENTAL QUALITY - OLWR
PUBLIC SUPPLY WELLS PROJECT

GPS LOG

USER NAME(S): AH/mo DATE: 6-9-99
UNIT DEQ #: _____ FILE #: A060914B
HEALTH DEPT. #: 290010-02 ELEV.: 398
USGS #: M7 OLWR #: GW12193
OWNER: Town of Tremont QUAD: Tremont
LOCATION: ^{NE}/NE/ND/SW S 4 T 105 R 10E COUNTY: Itawamba
LOCATION DESCRIPTION: well in fence.

CASING DIAM: _____ PUMP TYPE AND SIZE: 7.5 HP Turbine
GPS FIELD LOCATION: LAT: 34 14.477 N LONG: 88 15.519 W
GPS CORRECTED: LAT: 34.240894 LONG: 88.257972
REMARKS: next to white + green house # 794
also .2 miles N Peom High School on
School Loop Rd.
p. 279



TREMONT

744 00
(1338)

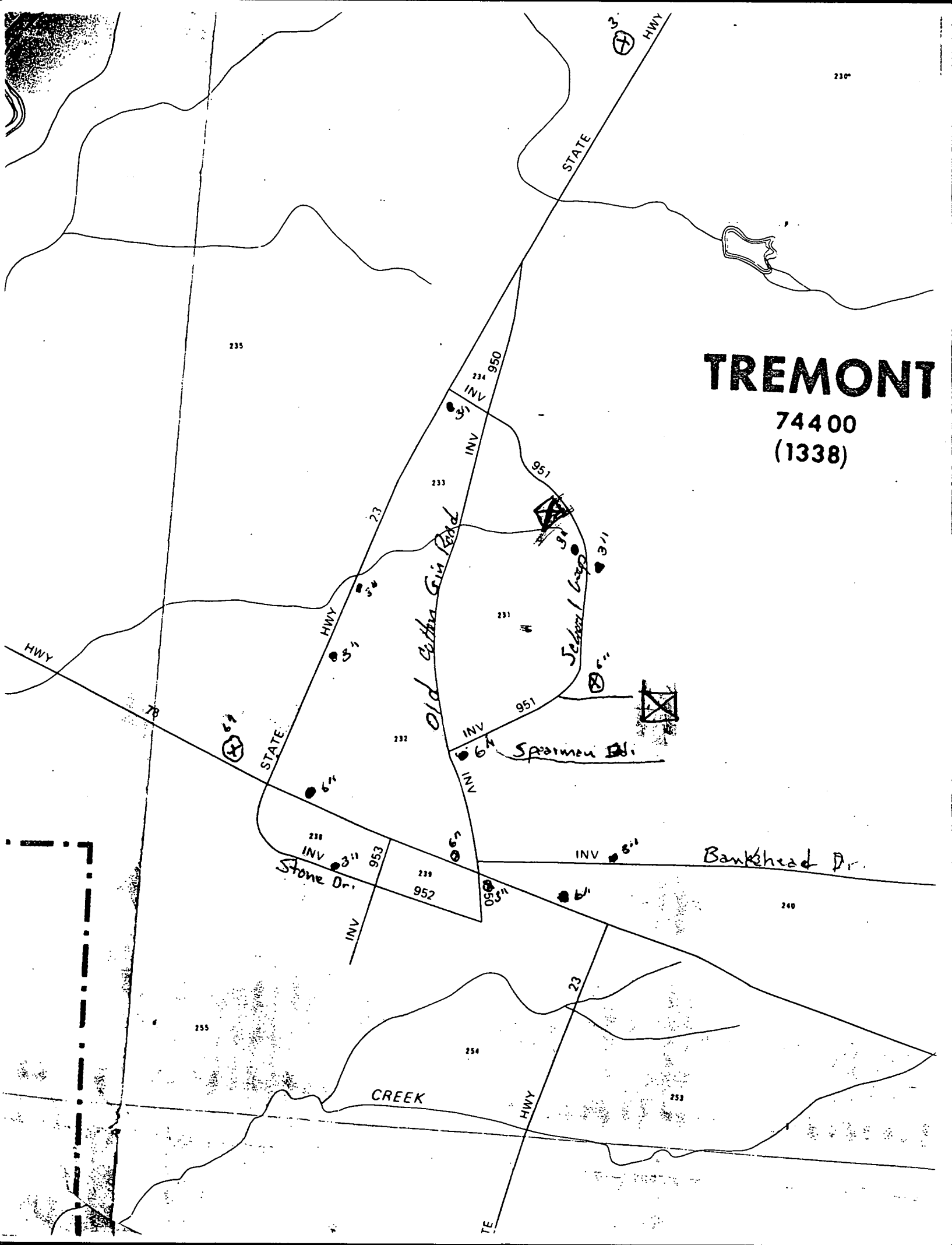

TREMONT QUADRANGLE
MISSISSIPPI-ITAWAMBA CO.
7.5 MINUTE SERIES (TOPOGRAPHIC)

(SHOTTSVILLE)
3552 1 SW

17°30" R. 10 E.

382

670 000 FEET | 383

RED BAY, ALA. 18 MI.
OAKLAND 3.2 MI.

88° 15'

34° 15'

T. 10 S.

3790

13 MI. O ALA. 19
HAMILTON, ALA. 17 MI.

290010-0
290010-01

1 660 000
FEET .

3787

3786

12'30"

3785

