

No longer measured
6/78 WTO

TRANSMITTED FOR ADP

Cane Bayou

Recorded by JM
Date 9/3/80

U.S. GEOLOGICAL SURVEY
WATER RESOURCES DIVISION
MISSISSIPPI DISTRICT
WELL RECORD *onward*

Well No. F-18
E-Log No. _____
County ISSAQUENA

Site ID 3.2.3.6.3.4.0.9.0.5.3.1.7.0.1 R=0* T=A* 2=W*
Data reliab. 3=C*^CU Report. agency 4=USGS* Dist. 6=28* 7=28* Co. 8=0.55*
Lat. _____
Long. 9=3.2.3.6.3.4* 10=0.9.0.5.3.1.7* Well No. 12=F.0.1.8*
Location 13=W.S.W. S 24 T 0.9 N R 0.7 W* Alt. 16=8.6*
Hyd. Unit (OWDC) 20= _____* Date 21=0.7.25.1.19.80*
Well use 23=W* Water Use 24=I* Hole depth 27=1.14* Well depth 28=1.14*
WL 30=1.0* Date 31=0.9.23.1.19.80* Source 33=S*
Status 273= _____* Project No. 5= _____*

GEN. SITE DATA

R=158* T=A* Date 159# 0.7.25.1.19.80* Owner No. _____
Owner 16# F.W.H. I.T. TEN FARMS*

OWNER

R=192* T=A* Date 193# _____* Temp. 196#00010* 197= _____*
R=192* T=A* Date 193# _____* Cond. 196#00095* 197= _____*
R=192* T=A* Date 193# _____* pH 196#00400* 197= _____*

FIELD OW

R=58* T=A* 59# 1* Date 60# 0.7.25.1.19.80* Remarks _____
Drig. 63# 4.0.7* Name DREILING Method 65# P* Finish 66# S*

CONSTR.

R=76* T=A* 59# 1* Steel
Top csng. 77# 0* Bot. csng. 78# 9.4* Diam. 79# 1.6*
R=76* T=A* 59# 1*
Top csng 77# _____* Bot. csng. 78= _____* Diam. 79# _____*

CASING

R=82* T=A* 59# 1* Top 83# 9.7* Bottom 84# 1.04*
Type 85# A* Diam. 87# 1.6* Size 88# _____*
R=82* T=A* 59# 1* Top 83# _____* Bottom 84# _____*
Type 85# _____* Diam. 87# _____* Size 88# _____*

OPENINGS

R= 146* T=A* 147# 1* Q 150# 1.6.0.0* Q/S 272= _____*
134 flows 146 pumped

YIELD

LIFT

R=42* T= A * Lift type 43# 7* Intake 44= * Power type 45= D*

Date 38= 07/24/1980* H.P. 46= 125.*

LOGS

R=198* T= A * Log 199# D* Top 200= 110.* Bot 201= 108.*

R=198* T= A * Log 199# * Top 200= * Bot 201= *

R=189* T= A * E Log No. 190# * 191= M I S S D I S T *

ANAL.

R=114* T= A * Year 115# * Type 120= *

AQUIFERS

R=90* T= A * 256# 1 * Top 91= 60.* Bot 92= 108.*

Unit ID 93= 112 M.R.V.A. * Name of Unit Alluv.

R=90* T= A * 256# 1 * Top 91= * Bot 92= *

Unit ID 93= * Name of Unit

HYDRAULICS

R=98* T= A * 99# 1 * Unit tested 100= * 103= *

R=105* T= A * 106# 1 * Test No. 106# *

107= * Transmissivity (gal/d)/ft

108= * Hydraul. cond. (gal/d)/ft²

110= * Storage coeff. Boundaries

R=121* T= * Yr Begin 122# * Network 258= *

Water Level Data Collection (1)

20
7.8
12.2
2.1 MP
10.1

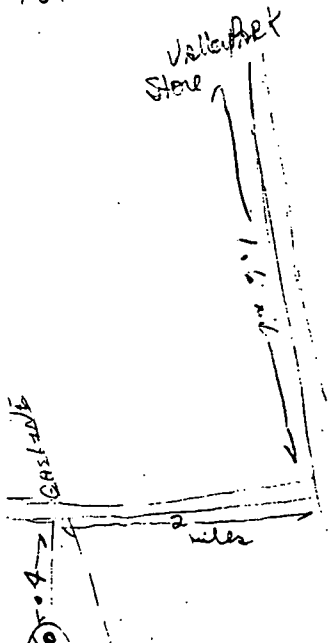

description of formations encountered	from	to
Clay	0	5
Clay	5	10
Clay	10	15
Clay	15	20
Clay	20	25
Clay	25	30
Clay	30	35
Clay	35	40
Clay	40	45
Clay	45	50
Sand	50	55
Gravel Sand	55	60
Sand Gravel	60	65
Sand Gravel	65	70
Sand Gravel	70	75
Sand Gravel	75	80
Gravel Sand	80	85
Sand Gravel	85	90
Gravel Sand	90	95
Sand Gravel	95	100
Sand Gravel	100	105
Sand	105	110
Sand Gravel Rock	110	114
Bottom of Hole		114

ISSAQUENA

F-18

7/25/80

MISSISSIPPI BOARD OF WATER COMMISSIONERS
416 North State Street
Jackson, Mississippi 39201

CODED

WATER WELL DRILLERS LOG

July 25, 1980
date well completed

Dreiling & Associates
firm name

Issaquena
county well located

LANDOWNER: Whitten Farms #2

Mrs. Mildred S. Whitten
P. O. Box 253
Valley Park, Ms. 39177
(mailing address)

WELL LOCATION:

sec. 23 T-9 N R-7 E
S W
2 miles S of Valley Park
(distance) (direction) (nearest town)

WELL PURPOSE: Irrigation
(home, irrigation, municipal, industrial)

WELL COMPLETION DATA:

- (1) diameter (inches) 16"
- (2) total depth (feet) 114'
- (3) static water level (feet) 10' below top of ground.
- (4) casing Steel, 94' (material) (depth)
30' (size) if telescope see back.
- (5) screen 20', 94' (length) (depth to top)
16" Steel (size) (material)
- (6) pump 125 (HP) 1600 (yield gpm)
diesel (type power)
- (7) electric log no. (yes or no)
None (organization running log)
- (8) how well bottom plugged Steel Plug.

description of formations encountered	from to	
	from	to
Clay	0	5
Clay	5	10
Clay	10	15
Clay	15	20
Clay	20	25
Clay	25	30
Clay	30	35
Clay	35	40
Clay	40	45
Clay	45	50
Sand	50	55
Gravel Sand	55	60
Sand Gravel	60	65
Sand Gravel	65	70
Sand Gravel	70	75
Sand Gravel	75	80
Gravel Sand	80	85
Sand Gravel	85	90
Gravel Sand	90	95
Sand Gravel	95	100
Sand Gravel	100	105
Sand	105	110
Sand Gravel Rock	110	114
		114
Bottom of Hole		

DEPT. OF NATURAL RESOURCES
BUREAU OF LAND & WATER RESOURCES

AUG 15 1980
RECEIVED

DRILLERS REMARKS:

770 000 FEET
(MISS.)

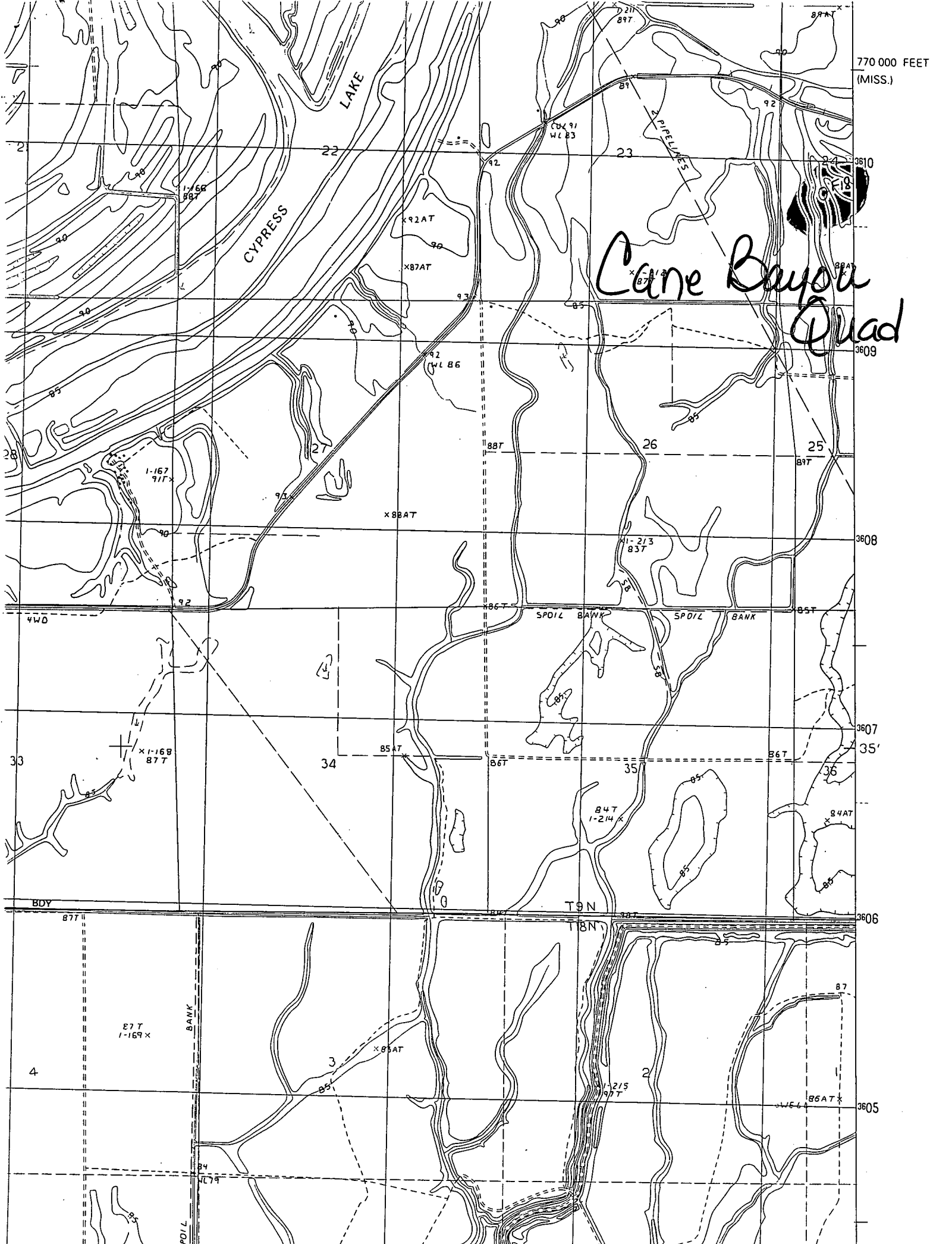

Cane Bayou
Quad