

WELL SCHEDULE

U. S. DEPT. OF THE INTERIOR

GEOLOGICAL SURVEY

WATER RESOURCES DIVISION

MASTER CARD

Record by WTO Source of data Obs. driller Date 6/11/71 Map ONWARD MISS-LA

State LA 28 County (or town) ISSAQUENA 28

Latitude: 323933N Longitude: 0910759 Sequential number: 1

Lat-long accuracy: 20 T 9 S, R 7 Sec 1 NE, SW, NE

Local well number: F005CA0109N07W Other number: \_\_\_\_\_ B & M

Local use: 022069 Owner or name: \_\_\_\_\_

Owner or name: JACK FLEEMAN Address: VALLEY PARK

Ownership: County, Fed Gov't, City, Corp or Co, Private, State Agency, Water Dist P

Use of water: (A) Air cond, Bottling, Comm, Dewater, Power, Fire, Dom, Irr, Med, Ind, P S, Rec, (S) (T) (U) (V) (W) (X) (Y) (Z) H

Use of well: (A) Anode, Drain, Seismic, Heat Res, Obs, Oil-gas, Recharge, Test, Unused, Withdraw, Waste, Destroyed. (D) (G) (H) (I) (M) (N) (P) (R) (T) (U) (W) (X) (Z) W

DATA AVAILABLE: Well data  Freq. W/L meas.:  Field aquifer char.

Hyd. lab. data: \_\_\_\_\_

Qual. water data; type: \_\_\_\_\_

Freq. sampling: \_\_\_\_\_ Pumpage inventory: yes  no  period: \_\_\_\_\_

Aperture cards: \_\_\_\_\_ yes

Log data: 10' - 1710' DE

WELL-DESCRIPTION CARD

SAME AS ON MASTER CARD Depth well: 1640 Meas. rept accuracy 3

Depth cased; (first perf.) 1600 Casing type: API Diam. 4x2 in 4

Finish: porous concrete, gravel w. (perf.), gravel w. (screen), horiz. gallery, open end, perf., screen, sd. pt., shored, open hole, other S

Method Drilled: (A) air rot, (B) bored, (C) cable, (D) dug, (H) hyd jetted, (J) rot., (P) air percussion, (R) rotary, (T) reverse, (V) trenching, (W) driven, (X) wash, (Z) other H

Date Drilled: 971 Pump intake setting: \_\_\_\_\_ ft 36 38

Driller: DAVID BERRY BENTON MISS

Lift (type): (A) air, (B) bucket, (C) cent, (J) jet, (L) multiple, (M) multiple, (N) none, (P) piston, (R) rot, (S) submerg, (T) turb, (Z) other S Deep  Shallow

Power (type): diesel  elec, nat gas, LP gas, hand, gas, wind, H.P. 2 Trans. or meter no. 7

Descrip. MP \_\_\_\_\_ ft above \_\_\_\_\_ ft below LSD, Alt. MP \_\_\_\_\_

Alt. LSD: 100 Accuracy: (source) topo 5

Water Level \_\_\_\_\_ ft above \_\_\_\_\_ ft below MP; \_\_\_\_\_ ft above \_\_\_\_\_ ft below LSD F Accuracy: \_\_\_\_\_ D

Date meas: 671 Yield: 55 gpm 55 Method determined 61

Drawdown: \_\_\_\_\_ ft \_\_\_\_\_ Accuracy: \_\_\_\_\_ Pumping period \_\_\_\_\_ hrs \_\_\_\_\_

QUALITY OF WATER DATA: Iron \_\_\_\_\_ ppm \_\_\_\_\_ Sulfate \_\_\_\_\_ ppm \_\_\_\_\_ Chloride \_\_\_\_\_ ppm \_\_\_\_\_ Hard. \_\_\_\_\_ ppm \_\_\_\_\_

Sp. Conduct \_\_\_\_\_ K x 10 6 Temp. \_\_\_\_\_ °F \_\_\_\_\_ Date sampled \_\_\_\_\_

Taste, color, etc. \_\_\_\_\_

Well No.

1-5

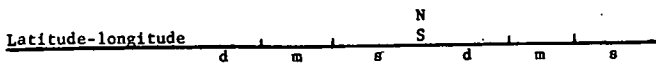

HYDROGEOLOGIC CARD

SAME AS ON MASTER CARD 03 Section: \_\_\_\_\_  
 Drainage Basin: E Subbasin: 15J  
 Top of well site: (D) depression, stream channel, dunes, flat, hilltop, sink, swamp, (E) offshore, pediment, hillside, terrace, undulating, valley flat F  
 MAJOR AQUIFER: system \_\_\_\_\_ series TE aquifer, formation, group SS  
 Lithology: \_\_\_\_\_ Origin: 2 Aquifer Thickness: 70 ft  
 Length of well open to: \_\_\_\_\_ ft 40 Depth to top of: 1570 ft 157  
 MINOR AQUIFER: system \_\_\_\_\_ series \_\_\_\_\_ aquifer, formation, group \_\_\_\_\_  
 Lithology: \_\_\_\_\_ Origin: \_\_\_\_\_ Aquifer Thickness: \_\_\_\_\_ ft  
 Length of well open to: \_\_\_\_\_ ft \_\_\_\_\_ Depth to top of: \_\_\_\_\_ ft \_\_\_\_\_  
 Intervals Screened: 40' 2" SS. 008  
 Depth to consolidated rock: \_\_\_\_\_ ft \_\_\_\_\_ Source of data: \_\_\_\_\_  
 Depth to basement: \_\_\_\_\_ ft \_\_\_\_\_ Source of data: \_\_\_\_\_  
 Surficial material: \_\_\_\_\_ Infiltration characteristics: \_\_\_\_\_  
 Coefficient Trans: \_\_\_\_\_ gpd/ft<sup>2</sup> \_\_\_\_\_ Coefficient Storage: \_\_\_\_\_  
 Coefficient Perm: \_\_\_\_\_ gpd/ft<sup>2</sup>; Spec cap: \_\_\_\_\_ gpm/ft; Number of geologic cards: \_\_\_\_\_

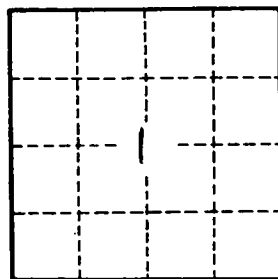
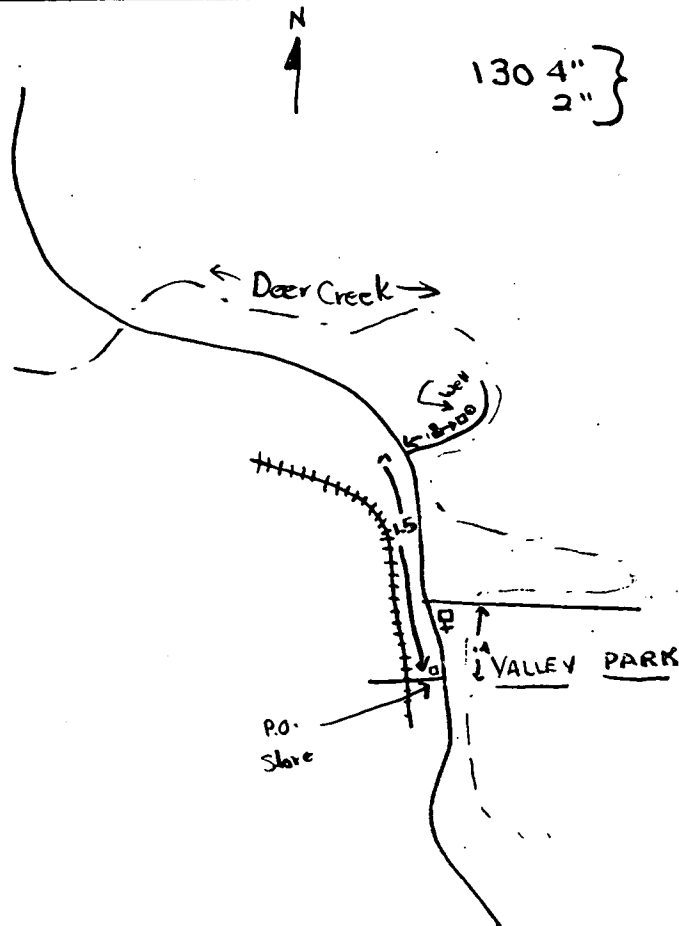

Well No. F-5