

6/78 WTO

TRANSMITTED FOR ADP

Onward

Recorded by J. Crout
Date 9/23/80

U.S. GEOLOGICAL SURVEY
WATER RESOURCES DIVISION
MISSISSIPPI DISTRICT
WELL RECORD

Well No. E-16
E-Log No. _____
County ISSAQUENA

E#1

GEN. SITE DATA

Site ID 323911090582701 R=0* T=A* 2=W*

Data reliab. 3=*^C Report. agency 4=USGS* Dist. 6=28* 7=28* Co. 8=055*

Lat. _____ Long. 9=323911* 10=0905827* Well No. 12='E.O.16'*

Location 13=~~SE~~ S.O.1 T.09 N. R.0.8 W.* Alt. 16=91.*

Hyd. Unit (OWDC) 20=* Date 21=0911311980*

Well use 23=W* Water Use 24=I* Hole depth 27=130.* Well depth 28=130.*

WL 30=14.* Date 31=0912311980* Source 33=S*

Status 273=* Project No. 5=*

10
4.72
15.28
1.9
14.3

OWNER

R=158* T=A* Date 159#0911311980* Owner No. Redkey Woodruff

Owner 161#G.D.D.S.E. LAKE FARMS*

FIELD QW

R=192* T=A* Date 193# Temp. 196#00010* 197=*

R=192* T=A* Date 193# Cond. 196#00095* 197=*

R=192* T=A* Date 193# pH 196#00400* 197=*

CONSTR.

R=58* T=A* 59#1* Date 60=0911311980* Remarks _____

Drlg. 63=40.7* Name DRELLING Method 65=R* Finish 66=S*

CASING

R=76* T=A* 59#1* steel

Top csgn. 77#D.* Bot. csgn. 78=114.* Diam. 79#16.*

R=76* T=A* 59#1*

Top csgn. 77# Bot. csgn. 78= Diam. 79#

OPENINGS

R=82* T=A* 59#1* Top 83#114.* Bottom 84=134.*

Type 85=L* Diam. 87=16.* Size 88=*

R=82* T=A* 59#1* Top 83# Bottom 84=*

Type 85= Diam. 87= Size 88=*

YIELD

R=146* T=A* 147#1* Q 150=1200.* Q/S 272=*

134 flows 146 pumped

LIFT
 R=42* T= A * Lift type 43# T * Intake 44= * Power type 45= D *
 Date 38= 09/13/1980 * H.P. 46= 8.0 * *

LOGS
 R=198* T= A * Log 199# D * Top 200= D * Bot 201= 13.0 * *
 R=198* T= A * Log 199# * Top 200= * Bot 201= * *
 R=189* T= A * E Log No. 190# * 191= M I S S D I S T * *

ANAL.
 R=114* T= A * Year 115# * Type 120= * *

AQUIFERS
 R=90* T= A * 256# 1 * Top 91= 9.0 * * Bot 92= 13.0 * *
 Unit ID 93= 1.12.M.P.V.A. * Name of Unit ALUN.
 R=90* T= A * 256# 1 * Top 91= * * Bot 92= * *
 Unit ID 93= * Name of Unit _____

HYDRAULICS
 R=98* T= A * 99# 1 * Unit tested 100= * 103= * *
 R=105* T= A * 99# 1 * Test No. 106# * *
 107= * Transmissivity (gal/d)/ft _____
 108= * Hydraulic cond. (gal/d)/ft² _____
 110= * Storage coeff. Boundaries _____

R=121* T= * Yr Begin 122# * Network 258= * *

Water Level Data Collection (1)

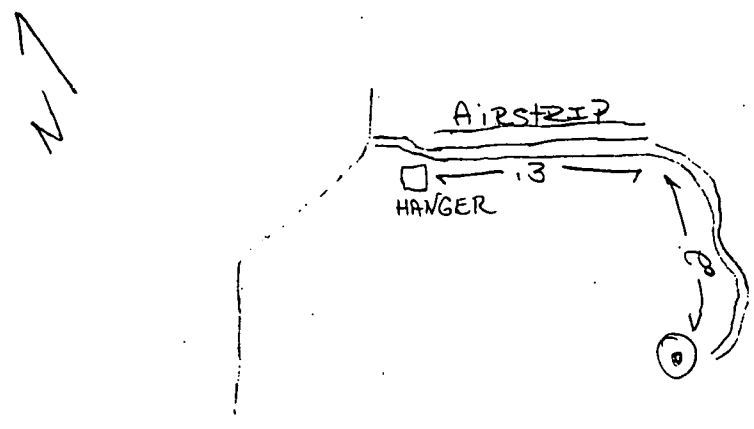

ISSAQUENA
 E 16
 Sept 13, 1980
 Sept. 9, 1980
 date well completed

MISSISSIPPI
 BOARD OF WATER COMMISSIONERS
 416 North State Street
 Jackson, Mississippi 39201
 WATER WELL DRILLERS LOG

Well # 4
 CODED

Dreiling & Associates
 firm name
 Issaquena
 county well located

LANDOWNER: Goose Lake Farms
Rodney Woodruff
Rt. 2
Rolling Fork, Ms. 39159
 (mailing address)

WELL LOCATION:
 sec. 1 T. 9 N. R. 8 E.
7 miles West of Valley Park
 (distance) (direction) (nearest town)

WELL PURPOSE: Irrigation
 (home, irrigation, municipal, industrial)

WELL COMPLETION DATA:
 (1) diameter (inches) 22"
 (2) total depth (feet) 134'
 (3) static water level (feet) 16' below above top of ground.
 (4) casing Steel 134'
 (material) (depth)
 (size) if telescope see back.
 (5) screen 20' 114'
 (length) (depth to top)
16' Steel
 (size) (material)
 (6) pump 80 1200
 (HP) (yield gpm)
Diesel
 (type power)
 (7) electric log no
 (yes or no)
 (organization running log)
 (8) how well bottom plugged Steel Plug

description of formations encountered	from	to
Top Soil	0	5
Gray Clay-Fine Sand	5	10
Gray Clay-Fine Sand	10	15
Gray Clay-Fine Sand	15	20
Gray Clay-Fine Sand	20	25
Gray Clay-Fine Sand	25	30
Gray Clay-Fine Sand	30	35
Gray Clay-Wood-Fine Sand	35	40
Fine Sand-Gray Clay	40	45
Fine Sand-Gray Clay	45	50
Fine Sand-Some gray clay	50	55
Fine Sand	55	60
Lignite Clay-Wood-Fine Sand		
Fine Sand-Wood-Lignite	<u>60</u>	<u>65</u>
Coal	65	70
Fine Sand-Gray Clay	70	75
Lignite Coal Fine Sand	75	80
Fine Sand-Gravel	80	85
Gray Clay/Fine Sand-Gravel	85	90
Gray Clay-Gravel-Fine-Sand	90	95
Gray Clay-Gravel-Fine Sand	95	100
Gravel-Rock-Coarse Sand	100	105
Gravel-Rock-Coarse Sand	105	110
Gravel-Coarse Sand	110	115
Coarse sand-Gravel-Coal	115	120
Coarse Sand-Gravel-Rock	120	125
Coarse Sand/Gravel	125	130
Bottom of hole 134'		

DRILLERS REMARKS:
 SEP 30 1980
 RECEIVED
 DEPT. OF NATURAL RESOURCES
 BUREAU OF LAND & WATER RESOURCES

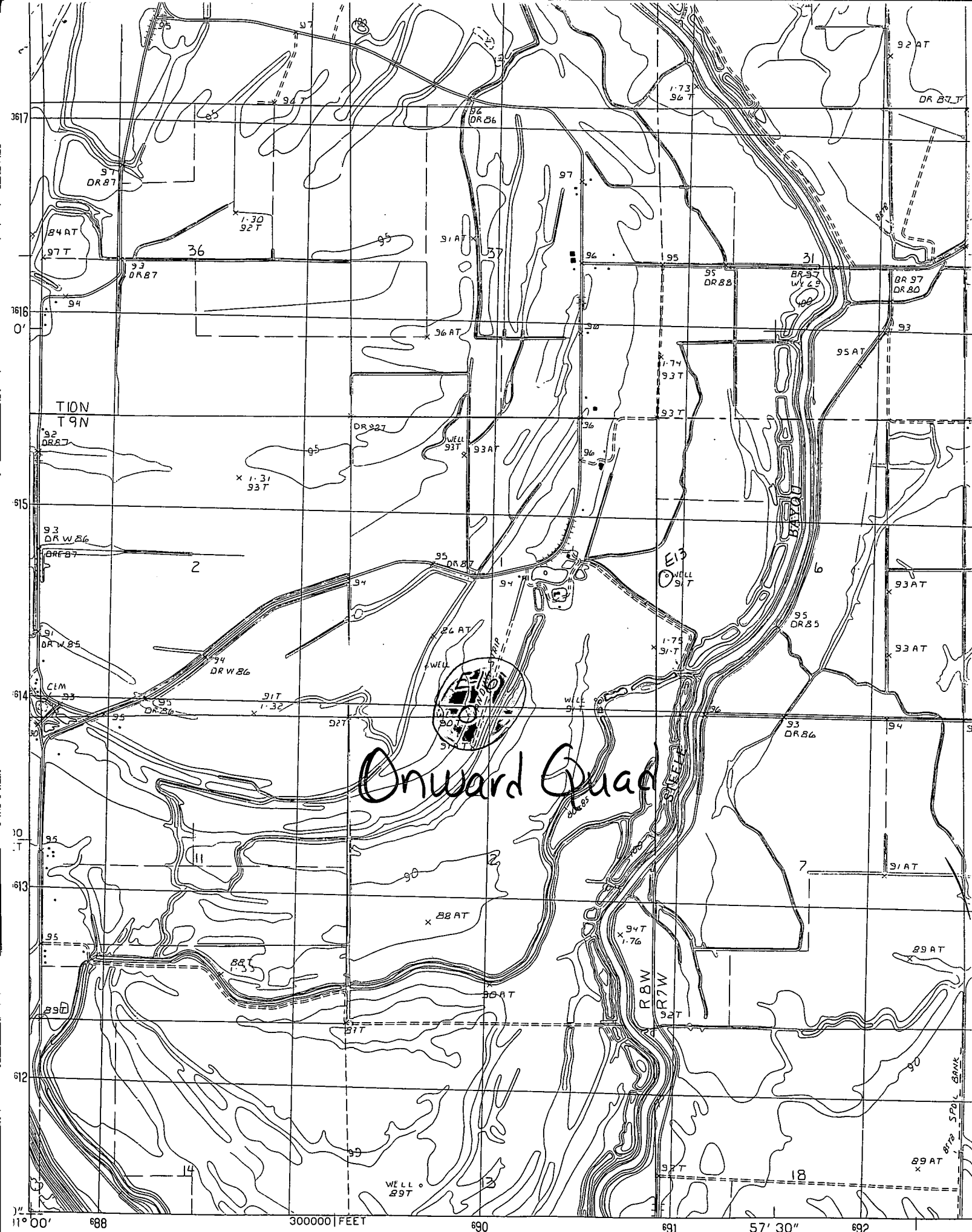

Onward Quad

11° 00' 688 300000 FEET 690 691 57' 30" 692

