

No longer measured

6/78 WTO

Recorded by

WTO

Date

TRANSMITTED FOR ADP

U.S. GEOLOGICAL SURVEY

WATER RESOURCES DIVISION

MISSISSIPPI DISTRICT

WELL RECORD

Well No.

E13

E-Log No.

County

Issaquena

Site ID

323924090580101

R=0*

T=A*

2=W*

#13

Data reliab.

3=C*^CU

Report. agency

4=USGS*

Dist.

6=28*

7=28*

Co.

8=055*

Lat.

Long./

9=323924*

10=0905801*

Well No.

12=E013*

Location

13=SENE S 06 T 09 N R 07 W*

Alt.

16=9.2*

Hyd. Unit (OWDC)

20=

Date

21=09/11/1980*

Well use

23=W*

Water Use

24=I*

Hole depth

27=124*

Well depth

28=124*

WL

30=1.2*

Date

31=09/11/1980*

Source

33=S*

Status

273=

Project No.

5=

R=158*

T=A*

Date

159# 09/09/1980*

Owner No.

Rodney Woodruff

Owner

161# GOOSE LAKE FARMS*

R=192*

T=A*

Date

193# / / *

Temp.

196#00010* 197= . . *

R=192*

T=A*

Date

193# / / *

Cond.

196#00095* 197= . . *

R=192*

T=A*

Date

193# / / *

pH

196#00400* 197= . . *

R=58*

T=A*

59# 1*

Date

60=09/11/1980*

Remarks

Drig.

63=4.07*

Name

DRILLING

Method

65=R*

Finish

66=S*

R=76*

T=A*

59# 1*

Top csgn.

77# 0. *

Bot. csgn.

78=110.4*

Diam.

79# 1.6*

R=76*

T=A*

59# 1*

Top csgn.

77# . . *

Bot. csgn.

78= . . *

Diam.

79# . . *

R=82*

T=A*

59# 1*

Top

83# 110.4*

Bottom

84=124.*

Type

85=L*

Diam.

87=1.6*

Size

88= . . *

R=82*

T=A*

59# 1*

Top

83# . . *

Bottom

84= . . *

Type

85= . . *

Diam.

87= . . *

Size

88= . . *

YIELD

R=146*

T=A*

147# 1*

Q

150=1200.*

Q/S

272= . . *

134 flows 146 pumped

R=42* T= A * Lift type 43# J * Intake 44= * Power type 45= D *

LIFT

Date 38= 0.9/0.9/1.9.80. * H.P. 46= 80. * *

LOGS

R=198* T= A * Log 199# D * Top 200= D. * Bot 201= 120. *

R=198* T= A * Log 199# * Top 200= * Bot 201= * *

R=189* T= A * E Log No. 190# * 191= M I S S D I S T *

ANAL.

R=114* T= A * Year 115# * Type 120= * *

AQUIFERS

R=90* T= A * 256# 1 * Top 91= 95. * Bot 92= 124. *

Unit ID 93= 1.12.M.R.V.A. * Name of Unit

R=90* T= A * 256# 1 * Top 91= * Bot 92= * *

Unit ID 93= * Name of Unit

HYDRAULICS

R=98* T= A * 99# 1 * Unit tested 100= * 103= * *

R=105* T= A * 99# 1 * Test No. 106# * *

107= * Transmissivity (gal/d)/ft

108= * Hydraul. cond. (gal/d)/ft²

110= * Storage coeff. Boundaries

R=121* T= * Yr Begin 122# * Network 258= * *

Water Level Data Collection (1)

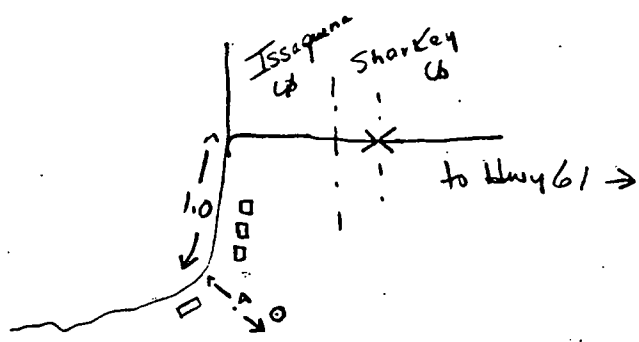

ISSAQUENA

E13

9/9/80

MISSISSIPPI BOARD OF WATER COMMISSIONERS 416 North State Street Jackson, Mississippi 39201

CODED

WATER WELL DRILLERS LOG

Well #5

9-9-80 date well completed 19 Dreiling & Associates firm name Issaquena county well located

LANDOWNER: Goose Lake Farms Rodney Woodruff Rt. 2 Rolling Fork, Ms. 39159 (mailing address)

WELL LOCATION: sec. 1 T. 9 N. S. R. 8 E. W. 5 miles West of Valley Park (distance) (direction) (nearest town)

WELL PURPOSE: Irrigation (home, irrigation, municipal, industrial)

WELL COMPLETION DATA:

- (1) diameter (inches) 22"
(2) total depth (feet) 124'
(3) static water level (feet) 15' below above top of ground.
(4) casing Steel 124' (material) (depth)
(5) screen 20' 104' (length) (depth to top) 16" Steel (size) (material)
(6) pump 80 1200 (HP) (yield gpm) Diesel (type power)
(7) electric log no (yes or no)
(8) how well bottom plugged Steel Plug (organization running log)

Table with 4 columns: description of formations encountered, from, to. Rows include Top Soil, Brown Clay, Gray Clay-Fine Sand, Gray Clay-Gravel-Med Sand, Coarse Sand-Gravel-Gray Clay, Lignite-Coal/Coarse Sand-Gray Clay, Coarse Sand/Gravel/Lignite Coal, Coarse Sand/Gravel, Coarse Sand-Gravel, Fine Sand-Gray Clay, Blue Clay, Pea Gravel/Fine Sand, Gray Clay-Med. Sand, Gray Clay/Coarse Sand, Fine Sand-Lignite/Wood, Gray Clay-Fine Sand, Coarse Sand & Fine Sand, Gray Clay, Fine Sand/Gray Clay, Blue Clay/Coarse Sand-Gravel, Coarse Sand/Gravel, Coarse Sand/Gravel, Lignite Coal/Coarse Sand and Gravel, Coarse sand and Gravel.

Bottom of Hole 124'

DEPT. OF NATURAL RESOURCES BUREAU OF LAND & WATER RESOURCES

SEP 30 1980

RECEIVED

DRILLERS REMARKS:

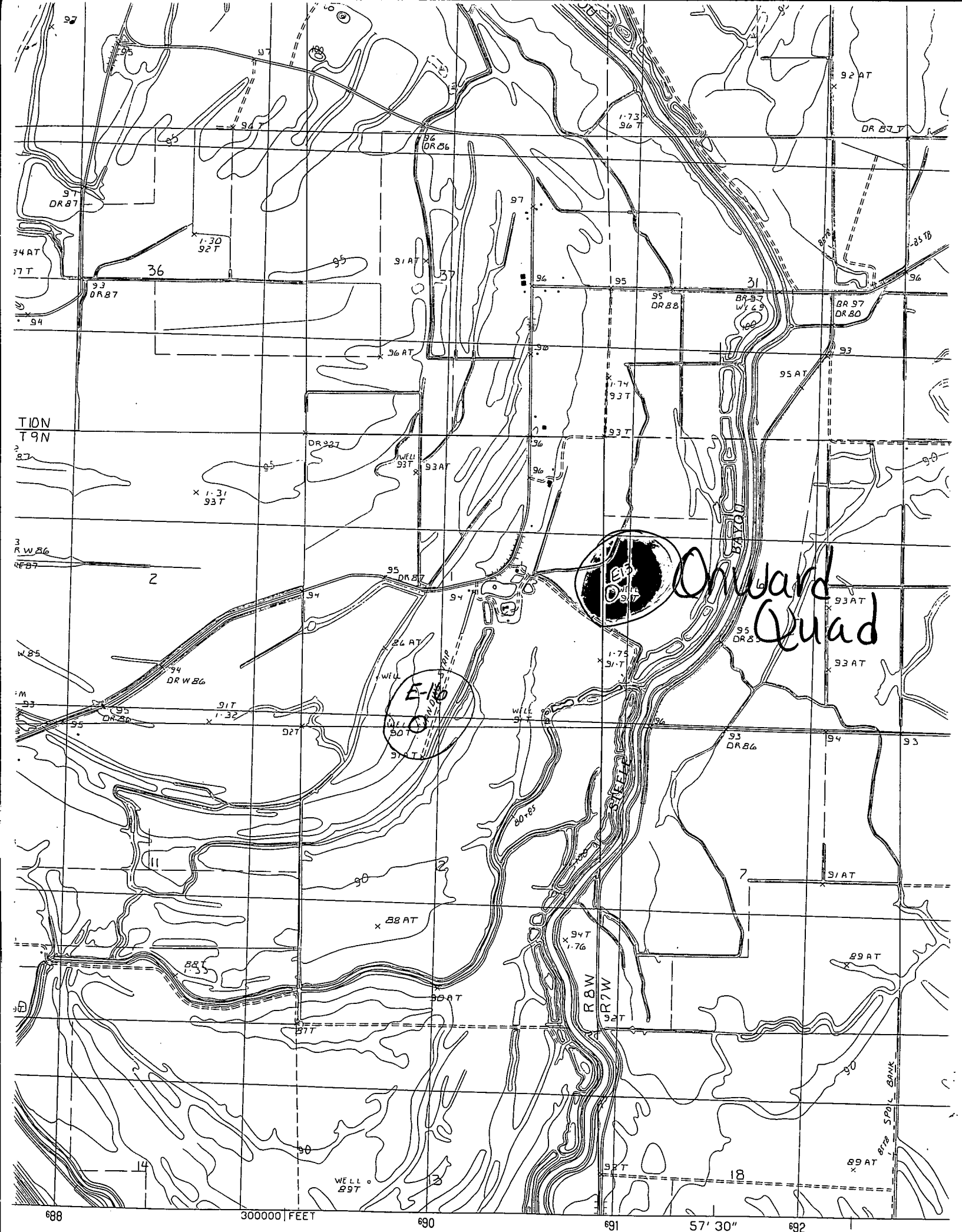

TION
T 9N

Onward
Quad

E-10

E-11