

GW 3996

Rolling Fork West

6/78 WTO

TRANSMITTED FOR ADP

Recorded by WTO

U.S. GEOLOGICAL SURVEY

Well No. B-43

Date 9/10/80

WATER RESOURCES DIVISION

E-Log No.

MISSISSIPPI DISTRICT

County Issaquena

WELL RECORD

Site ID 3 2 5 4 1 3 0 9 0 5 8 2 1 0 1 R=0* T=A* 2=W* #6

Data reliab. 3=C* Report. agency 4=USGS* Dist. 6=28* 7=28* Co. 8=055*

Lat. Long. 9=325413* 10=0905821* Well No. 12=1063*

Location 13=NE SE SE NW SW NE S 15 T 12 N R 08 W* Alt. 16=102.0* 10Z 1E 9C

Hyd. Unit (OWDC) 20= Date 21=09/10/1980*

Well use 23=U* Water Use 24= Hole depth 27= Well depth 28=110.0*

WL 30=12.0* Date 31=09/10/1980* Source 33=S*

Status 273= Project No. 5=

R=158* T=A* Date 159#09/10/1980* Owner No.

Owner 161#MAHALITC INC

R=192* T=A* Date 193# Temp. 196#00010* 197=

R=192* T=A* Date 193# Cond. 196#00095* 197=

R=192* T=A* Date 193# pH 196#00400* 197=

R=58* T=A* 59#1* Date 60=01/01/1980* Remarks

Drlg. 63= Name Method 65=R* Finish 66=

R=76* T=A* 59#1* Top csgm. 77# 0.0* Bot. csgn. 78= Diam. 79# 1.6*

R=76* T=A* 59#1* Top csgm. 77# Bot. csgn. 78= Diam. 79#

R=82* T=A* 59#1* Top 83# Bottom 84=

Type 85= Diam. 87= Size 88=

R=82* T=A* 59#1* Top 83# Bottom 84=

Type 85= Diam. 87= Size 88=

YIELD R= T=A* 147# 1* Q 150= Q/S 272=

134 flows 146 pumped

LIFT

R=42* T= A * Lift type 43# * Intake 44# * Power type 45# *
 Date 38# / / H.P. 46# *

LOGS

R=198* T= A * Log 199# * Top 200# * Bot 201# *
 R=198* T= A * Log 199# * Top 200# * Bot 201# *
 R=189* T= A * E Log No. 190# * 191# M I S S D I S T *

ANAL.

R=114* T= A * Year 115# * Type 120# *

AQUIFERS

R=90* T= A * 256# 1 * Top 91# * Bot 92# *
 Unit ID 93# 112MRYA * Name of Unit _____
 R=90* T= A * 256# 1 * Top 91# * Bot 92# *
 Unit ID 93# * Name of Unit _____

HYDRAULICS

R=98* T= A * 99# 1 * Unit tested 100# * 103# *
 R=105* T= A * 99# 1 * Test No. 106# *
 107# * Transmissivity (gal/d)/ft _____
 108# * Hydraul. cond. (gal/d)/ft² _____
 110# * Storage coeff. Boundaries _____

R=121* T= A * Yr Begin 122# * Network 258# *

Water Level Data Collection (1)

9/15/80
 17.
 3.6)
 13.46
 -1.03
 12.40
 12/13/82
 WL = 8.61

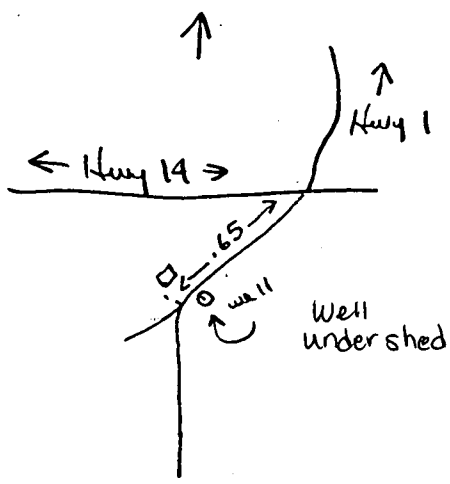

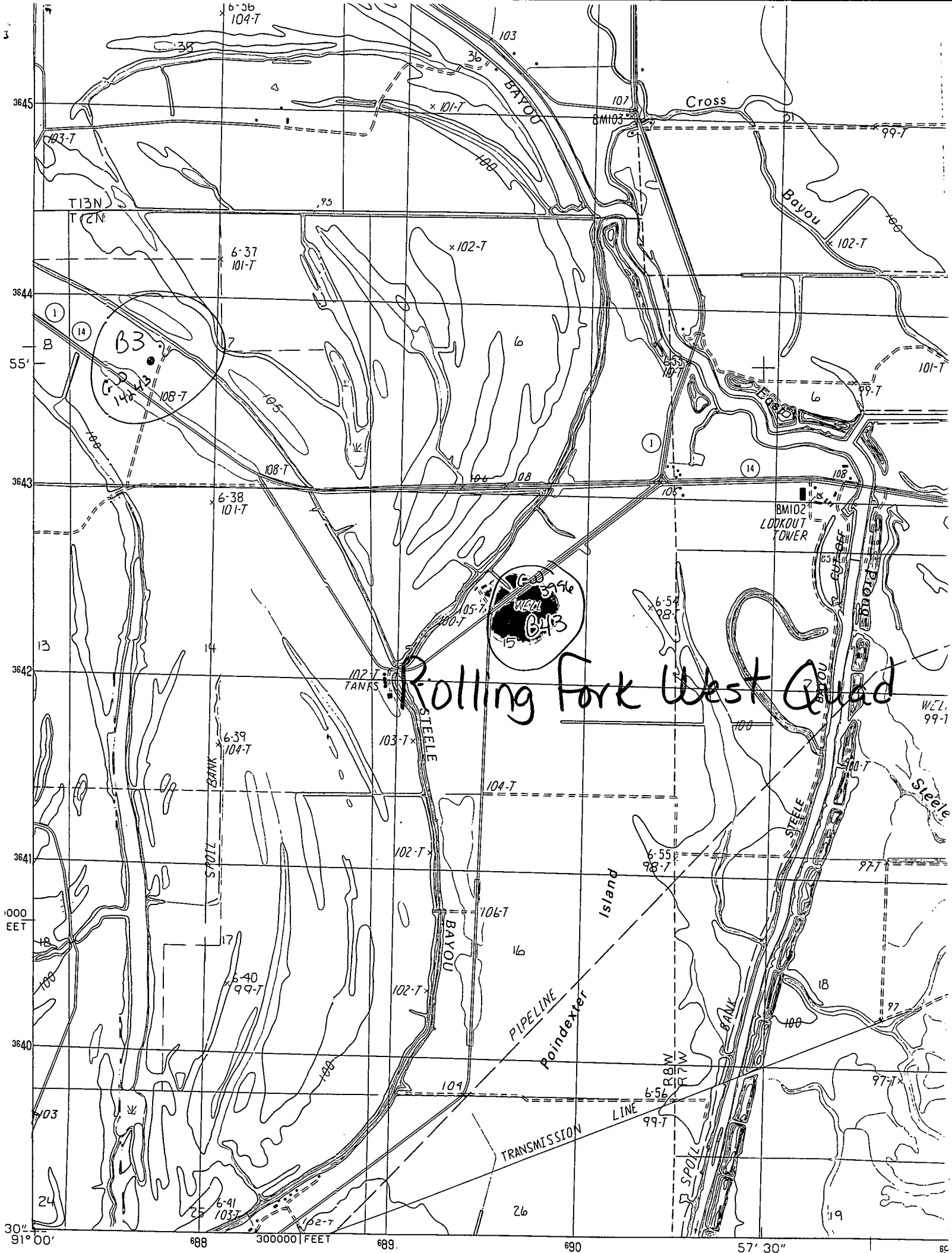

Rolling Fork West Quad

30" 91° 00' 688 300000 FEET 689 690 57' 30" 6C