

GW 4000 - LORENZEN QUAD

A GRID # Rolling Fork West

1/81 WTO

TRANSMITTED FOR ADP 719

Recorded by DARDEN

U.S. GEOLOGICAL SURVEY

Well No. A 65

Date 4/14/81

WATER RESOURCES DIVISION

E-Log No. \_\_\_\_\_

MISSISSIPPI DISTRICT

County ISSAQUENA

WELL RECORD

Site ID 325702090570001 R=0\* T=A\* 2=W\*

Data reliab. 3=C Report. agency 4=USGS Dist. 6=28 7=28 Co. 8=055

Lat. \_\_\_\_\_ Long. 9=325702 10=0905700 Well No. 12=A 65

Location 13=SENE S 19 T 13 N R 07 W Alt. 16=100

Hyd. Unit (OWDC) 20= Date 21=0411411981

Well use 23=W Water Use 24=Q Hole depth 27= Well depth 28=112

WL 30=1.4 Date 31=0411411981 Source 33=

Status 273= Project No. 5=

20.00 HGL  
4.17 WET  
15.23  
2.00 NAP  
13.23

R=158\* T=A\* Date 159#0410711981 Owner No. \_\_\_\_\_

Owner 161# E. G. McHALIC

R=192\* T=A\* Date 193# Temp. 196#00010 197=

R=192\* T=A\* Date 193# Cond. 196#00095 197=

R=192\* T=A\* Date 193# pH 196#00400 197=

R=58\* T=A\* 59#1 Date 60=0410711981 Remarks \_\_\_\_\_

Drig. 63= Name DIXIE AG Method 65=K Finish 66=S

R=76\* T=A\* 59#1

Top csng. 77# Bot. csng. 78=72 Diam. 79#16

R=76\* T=A\* 59#1

Top csng. 77# Bot. csng. 78= Diam. 79#

R=82\* T=A\* 59#1 Top 83# Bottom 84=110

Type 85=L Diam. 87=10 Size 88=

R=82\* T=A\* 59#1 Top 83# Bottom 84=

Type 85= Diam. 87= Size 88=

R= T=A\* 147#1 Q 150= Q/S 272=

134 flows 146 pumped

GEN. SITE DATA

OWNER

FIELD OW

CONSTR.

CASING

OPENINGS

YIELD

R=42\* T= A \* Lift type 43# \* Intake 44# \* Power type 45# \*

LIFT Date 38# / / H.P. 46# \*

R=198\* T= A \* Log 199# \* Top 200# \* Bot 201# \*

R=198\* T= A \* Log 199# \* Top 200# \* Bot 201# \*

R=189\* T= A \* E Log No. 190# \* 191= M I S S D I S T \*

ANAL. R=114\* T= A \* Year 115# \* 117# \* 120# \*

R=90\* T= A \* 256# 1 \* Top 91# \* Bot 92# \*

AQUIFERS Unit ID 93# \* Name of Unit \_\_\_\_\_

R=90\* T= A \* 256# 1 \* Top 91# \* Bot 92# \*

Unit ID 93# \* Name of Unit \_\_\_\_\_

R=98\* T= A \* 99# 1 \* Unit tested 100# \* 103# \*

R=105\* T= A \* 99# 1 \* Test No. 106# \*

HYDRAULICS 107# \* Transmissivity (gal/d)/ft \_\_\_\_\_

108# \* Hydraul. cond. (gal/d)/ft<sup>2</sup> \_\_\_\_\_

110# \* Storage coeff. Boundaries \_\_\_\_\_

R=121\* T= \* Yr Begin 122# \* Network 258# \*

Water Level Data Collection (1)

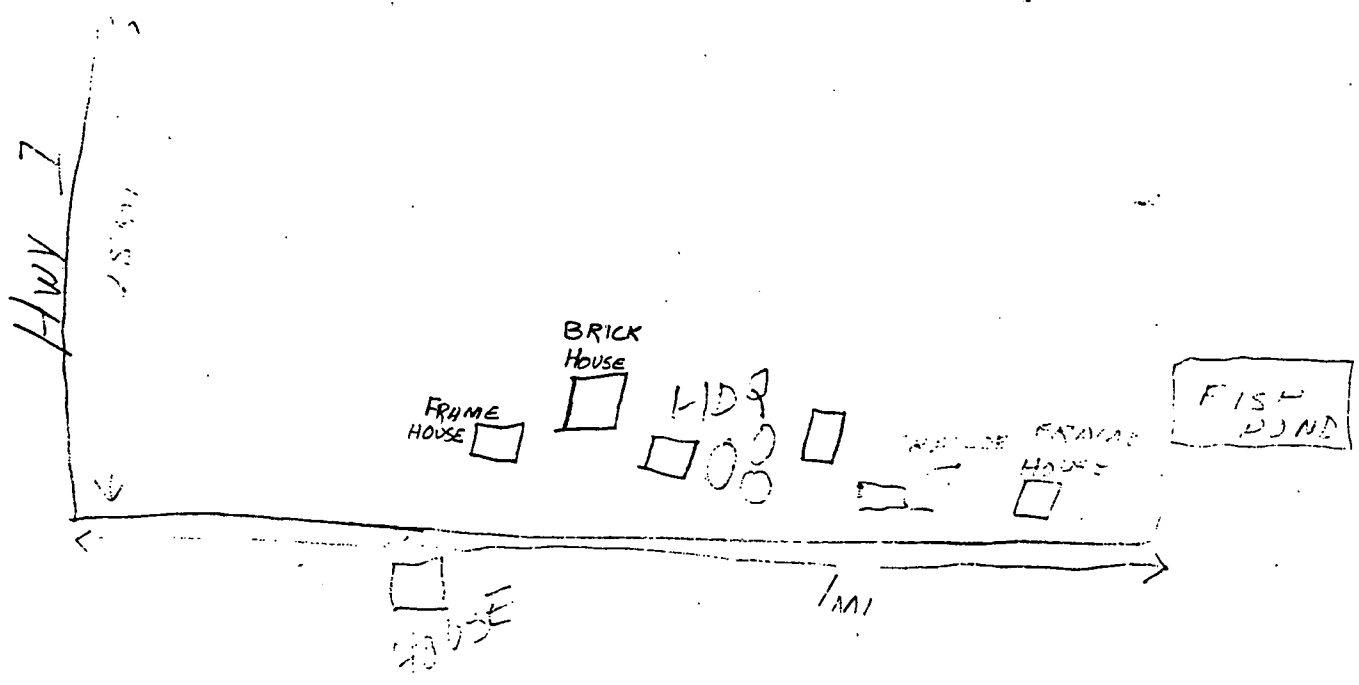

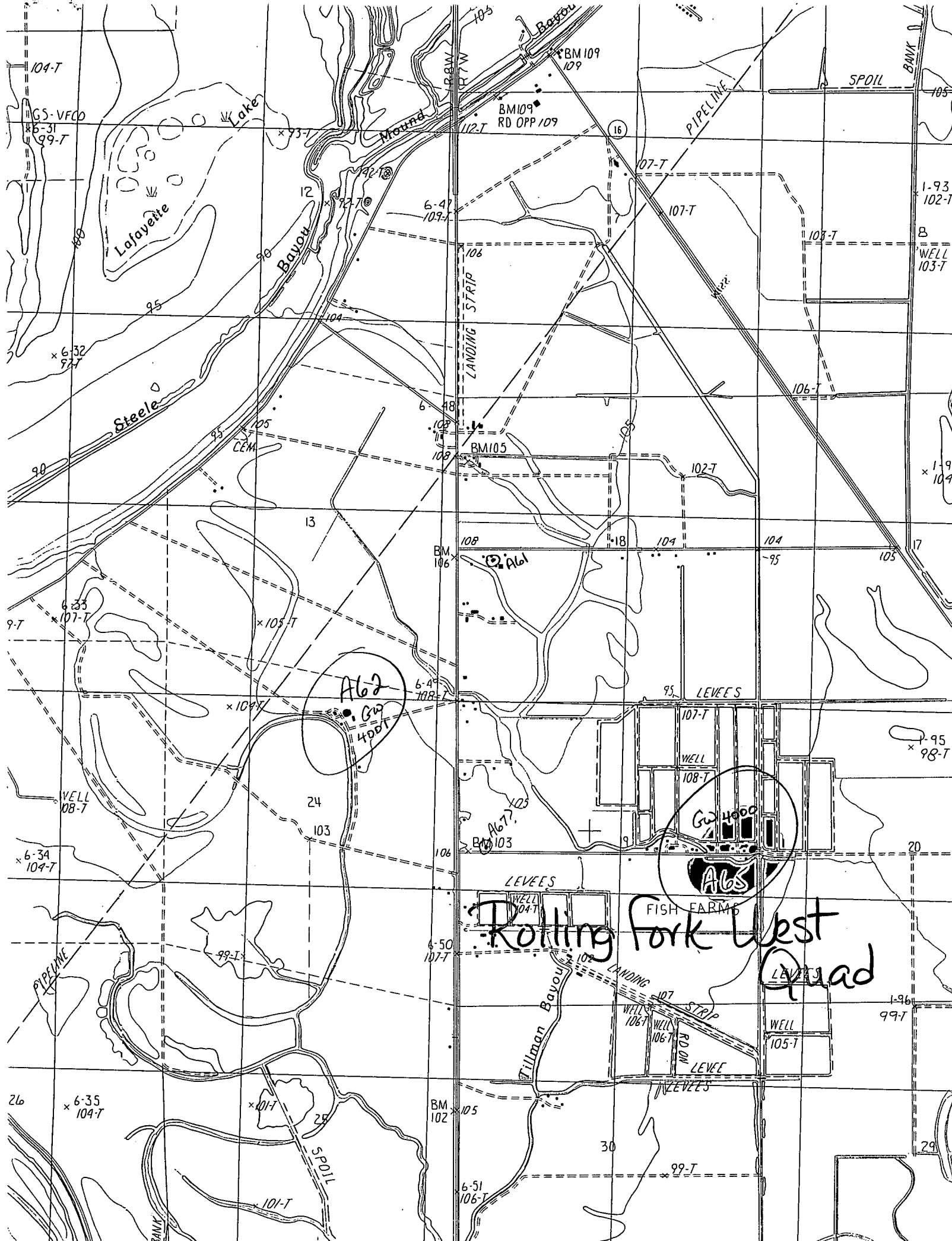

A62

GW 4000  
A63

Rolling Fork West Quad