

6W 4479

Glen Allen MAR 28

FORM 9-1642 (1-68)

Well No. A-37

WELL SCHEDULE

U. S. DEPT. OF THE INTERIOR GEOLOGICAL SURVEY WATER RESOURCES DIVISION

3 mi SW of Glen Allen

MASTER CARD

Record by JM Source of data BOWC Date 8-71 Map _____

State 28 County (or town) ISSAQUENA 28

Latitude: 33° 00' 19" N Longitude: 091° 04' 17" W Sequential number: 1

Lat-long accuracy: 5' T 130 S, R 9 Sec 20 NE NE

Local well number: A 037 Other number: _____

Local use: 068 Owner or name: DR. EUSTICE WINN Address: GREENVILLE

Ownership: (C) County, Fed Gov't, (F) City, Corp or Co, Private, (M) State Agency, Water Dist, (P) _____ P

Use of water: (A) Air cond, (B) Bottling, (C) Comm, (D) Dewater, (E) Power, (F) Fire, (G) Dom, (H) Irr, (I) Med, (J) Ind, (K) P S, Rec, (L) Stock, (M) Instit, (N) Unused, (O) Repressure, (P) Recharge, (Q) Desal-P S, (R) Desal-other, (S) Other I

Use of well: (A) Anode, (B) Drain, (C) Seismic, (D) Heat Res, (E) Obs, (F) Oil-gas, (G) Recharge, (H) Test, (I) Unused, (J) Withdraw, (K) Waste, (L) Destroyed W

DATA AVAILABLE: Well data Freq. W/L meas.: Field aquifer char.

Hyd. lab. data: _____

Qual. water data; type: _____

Freq. sampling: _____ Pumpage inventory: yes no; period: _____

Aperture cards: _____ yes no

Log data: _____ D

WELL-DESCRIPTION CARD

SAME AS ON MASTER CARD Depth well: _____ ft 124 Meas. rept. accuracy _____ 3

Depth cased; (first perf.) _____ ft 76 Casing type: Steel; Diam. _____ in 6

Finish: (C) porous concrete, (F) gravel w. (perf.), (G) gravel w. (screen), (H) horiz. gallery, (I) open end, (J) perf., (K) screen, (L) sd. pt., (M) shored, (N) open hole, (O) other S

Method: (A) air rot, (B) bored, (C) cable, (D) dug, (E) hyd jetted, (F) air rot., (G) percussion, (H) rotary, (I) reverse, (J) trenching, (K) driven, (L) drive wash, (M) other H

Date Drilled: 9-7-71 Pump intake setting: _____ ft _____

Driller: Five County name _____ address _____

Lift (type): (A) air, (B) bucket, (C) cent, (D) jet, (E) multiple, (F) multiple, (G) none, (H) piston, (I) rot, (J) submerg, (K) turb, (L) other T Deep Shallow

Power (type): (A) diesel, (B) elec, (C) gas, (D) gasoline, (E) hand, (F) gas, (G) wind, (H) H.P. H.A.H.S Trans. or meter no. _____

Descrip. MP 3 above _____ ft below LSD, Alt. MP _____

Alt. LSD: _____ Accuracy: (source) _____ 4

Water Level: _____ ft above MP; _____ ft below LSD 10 Accuracy: _____ D

Date meas: 6-7-71 Yield: 1450 gpm 1450 Method determined _____

Drawdown: _____ ft _____ Accuracy: _____ Pumping period _____ hrs _____

QUALITY OF WATER DATA: Iron _____ ppm Sulfate _____ ppm Chloride _____ ppm Hard. _____ ppm

Sp. Conduct _____ K x 10⁶ Temp. _____ °F Date sampled _____

Taste, color, etc. _____

Well No. A-37

HYDROGEOLOGIC CARD

SAME AS ON MASTER CARD Physiographic Province: 0.3 Section: _____

E Drainage Basin: 151 Subbasin: _____

Topo of well site: (D) depression, stream channel, dunes, flat, hilltop, sink, swamp, (E) (F) (H) (K) (L) (O) (P) (S) (T) (U) (V) offshore, pediment, hillside, terrace, undulating, valley flat _____

MAJOR AQUIFER: system _____ series OG aquifer, formation, group m:A

Lithology: _____ Origin: 2 Aquifer Thickness: 52 ft

Length of well open to: _____ ft 48 Depth to top of: _____ ft 7.2

MINOR AQUIFER: system _____ series _____ aquifer, formation, group _____

Lithology: _____ Origin: _____ Aquifer Thickness: _____ ft

Length of well open to: _____ ft _____ Depth to top of: _____ ft _____

Intervals Screened: 6" Doerr

Depth to consolidated rock: _____ ft _____ Source of data: _____

Depth to basement: _____ ft _____ Source of data: _____

Surficial material: _____ Infiltration characteristics: _____

Coefficient Trans: _____ gpd/ft² _____ Coefficient Storage: _____

Coefficient Perm: _____ gpd/ft²; Spec cap: _____ gpm/ft; Number of geologic cards: _____

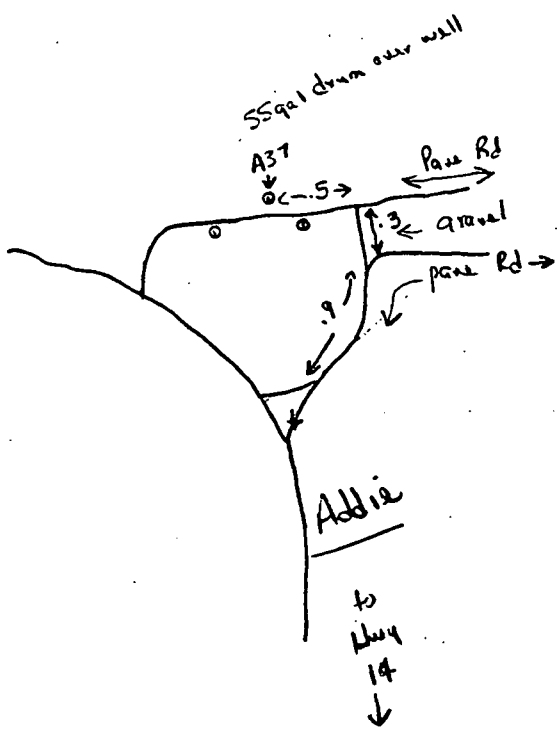
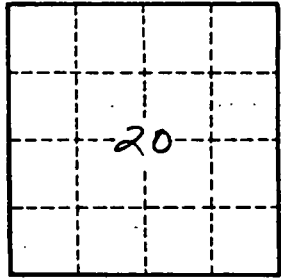

Well No.

A-37

ISSAQUENA

~~SHARKEY~~
A-37
6-18-71

MISSISSIPPI
BOARD OF WATER COMMISSIONER
416 North State Street
Jackson, Mississippi 39201

CODED

WATER WELL DRILLERS LOG ISSAQUENA

6-18 1971 FIVE COUNTY FARMERS ASSN ~~SHARKEY~~
date well completed firm name county well located

LANDOWNER: DR. EUSTICE WINN	description of formations encountered	from	to
GREENVILLE MISS. (mailing address)	TOP SOIL	0	14
	SAND	14	20 1/2
	CLAY	20 1/2	27
WELL LOCATION: sec. 20 T. 13 N. R. 9 E 3 miles SW of GLEN ALLEN (distance) (direction) (nearest town)	CLAY	27	33 1/2
	CLAY	33 1/2	40
	CLAY	40	46 1/2
	CLAY	46 1/2	53
	CLAY	53	59 1/2
WELL PURPOSE: IRRIGATION (home, irrigation, municipal, industrial)	CLAY	59 1/2	66
	CLAY	66	72 1/2
WELL COMPLETION DATA:	SAND ? GRAVEL	72 1/2	79
(1) diameter (inches) 6"	SAND : GRAVEL	79	85 1/2
(2) total depth (feet) 124 1/2'	SAND ? GRAVEL	85 1/2	92
(3) static water level (feet) 10' below top of ground.	SAND ? GRAVEL	92	98 1/2
(4) casing SCHEDULE 40 76 1/2" (material) (depth)	SAND ? GRAVEL	98 1/2	105
6" if telescope see back. (size)	SAND : GRAVEL	105	111 1/2
(5) screen 148' 76 1/2" (length) (depth to top)	SAND : GRAVEL	111 1/2	118
6" Doerr (size) (material)	SAND : GRAVEL	118	124 1/2
(6) pump Haws 1450 (HP) (yield gpm)			
(type power)			
(7) electric log No (yes or no)			
(organization running log)			
(8) how well bottom plugged WELDED			
DRILLERS REMARKS:			

CODED

JUL 15 1971

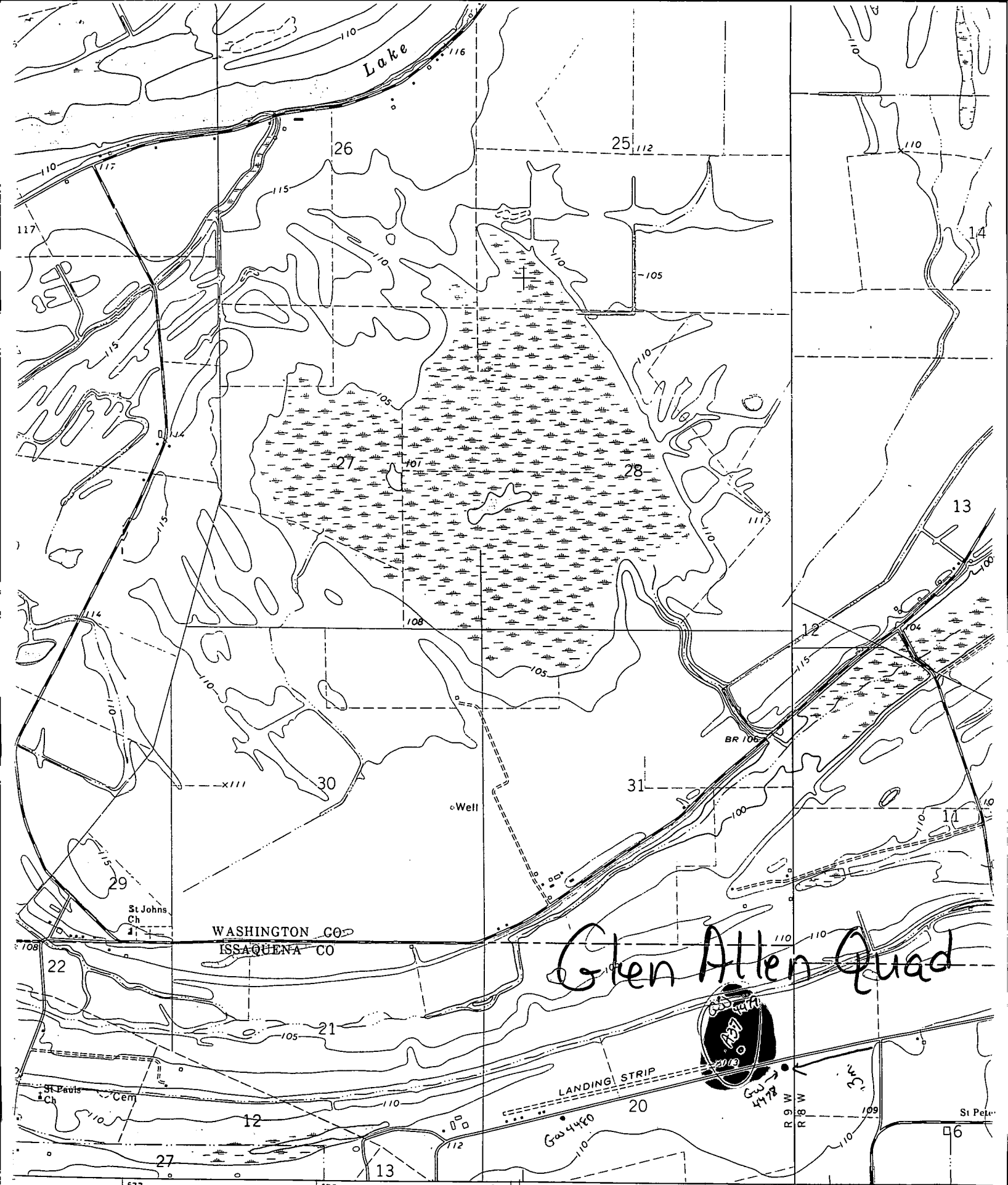

WASHINGTON CO
ISSAQUENA CO

Glen Allen Quad



the Geological Survey

s from aerial
J 1970
rican datum

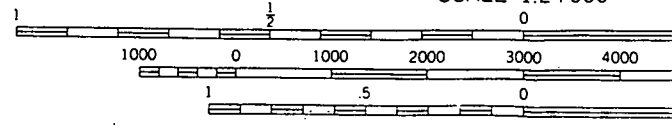
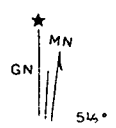

MAYERSVILLE 8 MI. (MAYERSVILLE)
2749 1 NE

SCALE 1:24 000