

In use 1955
S.W.P.C.

9-185-July 1935
Revised

UNITED STATES
DEPARTMENT OF THE INTERIOR
GEOLOGICAL SURVEY
WATER RESOURCES BRANCH

OBSERVATION
well
HUMPHREYS

WELL SCHEDULE

Date Jan. 19, 1939 Field No. 42
Record by J. F. Brown Office No. (56)
Source of data Layne - Central K156

This well reported deepened. ENB.

1. Location: State Miss. County Humphreys.
Map Bayland
NE 1/4 NE 1/4 sec. 15 T 13 N R 4 W

2. Owner: Town Lounge Address Louise, Miss
Tenant D.W. Holaday Address town clerk
Driller W.R. Praytor Address Layne - Central

3. Topography plain

4. Elevation _____ ft. above
_____ ft. below

5. Type: Dug (drilled), driven, bored, jetted Jan 1939

6. Depth: Rept. 909 ft. Meas. _____ ft.

7. Casing: Diam. 8 in., to (6) in. Type _____
Depth _____ ft. Finish Screen

8. Chief Aquifer white fine sand. From 846 ft. to 909 ft.

Others _____
9. Water level 21.2 ft. rept. May 3 1939 above
top of casing on 4" pump pipe which is 2 ft. above surface,
below against 4" head window

10. Pump: Type top deep well turbine Capacity 125 G. M.
Power: Kind electric Horsepower 3

11. Yield: Flow 125 G. M., Pump 150 G. M., Meas., Rept. Est. _____
Drawdown _____ ft. after _____ hours pumping _____ G. M.

12. Use: Dom., Stock, (PS), RR., Ind., Irr., Obs. _____
Adequacy, permanence _____

13. Quality _____ Temp. 80°F
19 1/4°F °F

Taste, odor, color _____ Sample No. 9-15-64
Unfit for _____ Ph=8.8

14. Remarks: (Log, Analyses, etc.) Nearly complete set of
samples obtained of sediments - Pumps
140 gpm against 30 ft. head.

Aug. 17, 1939 - water level 22.3. WSP 1944

OBS WCM
K156

UNITED STATES
DEPARTMENT OF THE ARMY
ENGINEER REGIMENT

1-1950-3111-10
11-1950-11

substitute uses gage for
city gage

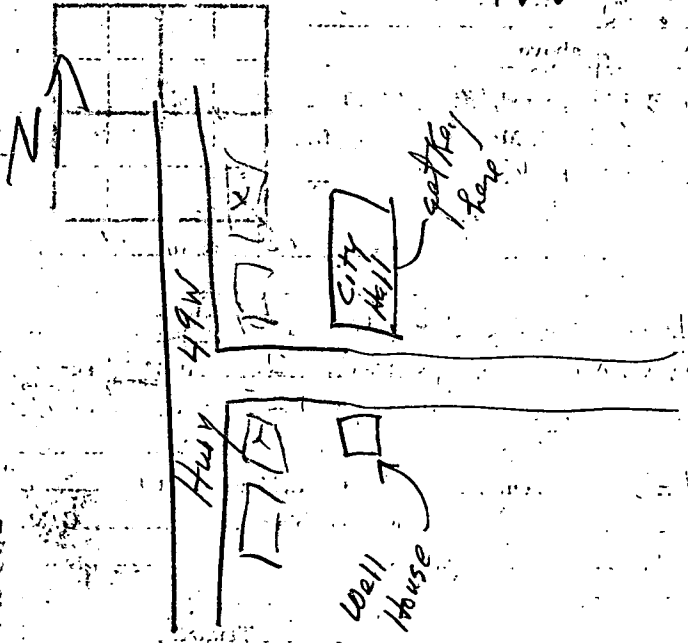

Handwritten notes on the right margin, including '10/12/50' and '10/12/50'.

DEPARTMENT OF ENVIRONMENTAL QUALITY - OLWR

PUBLIC SUPPLY WELLS PROJECT

GPS LOG

USER NAME(S): LAR / CAH DATE: 12/12/94

UNIT DEQ #: 82555 FILE #: C121216A

HEALTH DEPT. #: 270004-01 ELEV. 100

USGS #: _____ OLWR #: _____

OWNER: Town of Louise QUAD: Louise

LOCATION: SE/SE S 10 T 13N R 4W COUNTY: Humphreys

LOCATION DESCRIPTION: Well is in alley in large green brick house.

CASING DIA: 6" PUMP TYPE & SIZE: Turbine / 10

GPS FIELD LOCATION: LAT. 32° 58.56 N LONG. 90° 35.28 W

GPS CORRECTED LOCATION: LAT. 32.98184757 LONG. 90 59¹⁰⁷372

REMARKS: go to 1st street south of new city Hall turn left. go .005 turn right in alley. green pump house on left. GPS at well outside of pump house.

UNITED STATES
DEPARTMENT OF THE INTERIOR
GEOLOGICAL SURVEY

