

TRANSMITTED FOR ADE Louise

Recorded by WTO
Date 5/23/77

U.S. GEOLOGICAL SURVEY
WATER RESOURCES DIVISION
MISSISSIPPI DISTRICT
WELL RECORD

Well No. K26
E-Log No. 50
County Humphreys
187B LOUISE

10/23/79
33.02

Site ID 325704090341401 R=0* T=A* 2=W*

GEN. SITE DATA
Data reliab. 3-C*U Report. agency 4-USGS* Dist. 312 6=28* 7=28* Co. 8-053*
Lat. _____
Long. 9-325704* 10-0903414* Well No. 12-K026*
Location 13-SESE 24 T 13 N R 04 W* Alt. 16-99* 100 DEE
Hyd. Unit (OWDC) 20- Date 21-05/04/1977*
Well use 23-W* Water Use 24-NQ* Hole depth 27-373.* Well depth 28-360.*
WL 30-26.* Date 31-05/13/1977* Source 33-D* 97
Status 273=Y* 20
77

OWNER
R=158* T=A* Date 159# 05/13/1977* Owner No. TH#2
Owner 161-ANDERSON MINNOW FARM*

FIELD OW
R=192* T=A* Date 193# Temp. 196#00010* 197-
R=192* T=A* Date 193# Cond. 196#00095* 197-
R=192* T=A* Date 193# pH 196#00400* 197-

CONSTR.
R=58* T=A* 59# 1* Date 60-05/13/1977* Remarks _____
Drig. 63-334* Name Jefcoat Method 65-H* Finish 66-S*

CASING
R=76* T=A* 59# 1*
Top csng. 77# 0.* Bot. csng. 78-320.* Diam. 79# 4.*
R=76* T=A* 59# 1*
Top csng. 77# Bot. csng. 78- Diam. 79#

OPENINGS
R=82* T=A* 59# 1* Top 83# 320.* Bottom 84-360.*
Type 85-S* Diam. 87-4.* Size 88-
R=82* T=A* 59# 1* Top 83# Bottom 84-
Type 85- Diam. 87- Size 88-

YIELD
R= 146* T=A* 147# 1* Q 150-100.* Q/S 272-
134 flows 146 pumped

LIFT

R=42* T= A * Lift type 43# S* Intake 44= Power type 45= E*

Date 38= 05/13/1977 H.P. 46= 5*

LOGS

R=198* T= A * Log 199# D* Top 200= 10.0 Bot 201= 36.0*

R=198# T= A * Log 199# E* Top 200= 10.0 Bot 201= 37.2*

R=189* T= A * E Log No. 190# 050* 191= M I S S I D I S I *

ANAL.

R=114* T= A * Year 115# Type 120= A *

AQUIFERS

R=90* T= A * 256# 1 * Top 91= 320.* Bot 92= 370.*

Unit ID 93= 124 CCKF * Name of Unit 124 CCKF

R=90* T= A * 256# 1 * Top 91= Bot 92=

Unit ID 93= Name of Unit

HYDRAULICS

R=98* T= A * 99# 1 * Unit tested 100=

R=105* T= A * 99# 1 * Test No. 106# *

107= Transmissivity (gal/d)/ft

108= Hydraul. cond. (gal/d)/ft²

110= Storage coeff. Boundaries

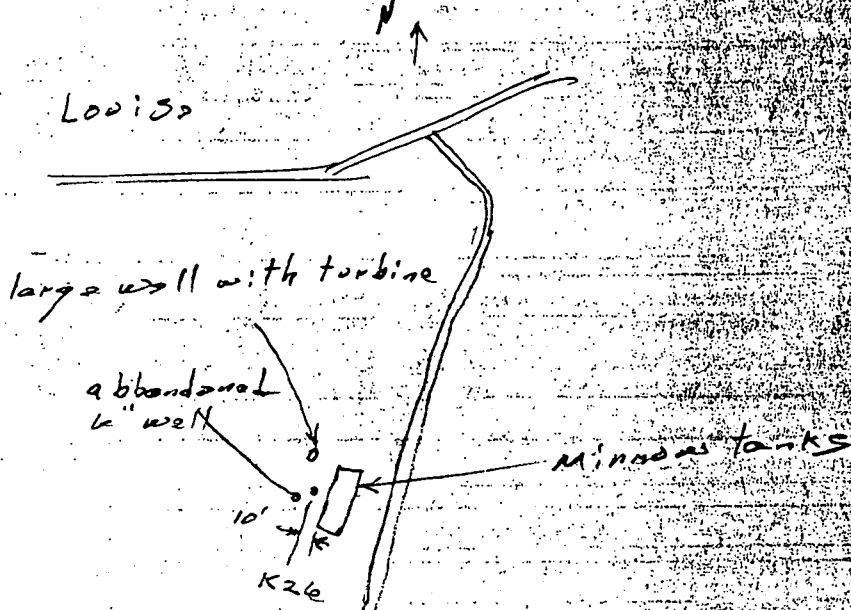

HUMPHREYS
K26
5-13-77
File # 50

MISSISSIPPI
BOARD OF WATER COMMISSIONERS
416 North State Street
Jackson, Mississippi 39201

CODED

WATER WELL DRILLERS LOG

May 13 1977 Jefcoat Drilling Co Humphreys
date well completed firm name county well located

LANDOWNER: <u>Anderson</u>	description of formations encountered	from	to
<u>Marrow Farm</u>			
<u>7000 1/2 Ave. Vicksburg</u> (mailing address)	<u>Clay</u>	<u>0</u>	<u>30</u>
WELL LOCATION:	<u>Gravel</u>	<u>30</u>	<u>98</u>
sec. <u>24</u> T. <u>13</u> N R. <u>4</u> W	<u>Clay</u>	<u>98</u>	<u>180</u>
<u>2 1/2</u> miles <u>S/E</u> of <u>Louis</u>	<u>Clay with sandy shale</u>	<u>180</u>	<u>214</u>
(distance) (direction) (nearest town)	<u>Sand</u>	<u>214</u>	<u>318</u>
WELL PURPOSE: <u>Municipal</u>		<u>318</u>	<u>360</u>
(home, irrigation, municipal, industrial)			<u>373</u>
WELL COMPLETION DATA:			<u>TD</u>
(1) diameter (inches) <u>4"</u>			
(2) total depth (feet) <u>360</u>			
(3) static water level (feet) <u>26'</u> below top of ground.			
(4) casing <u>PVC</u> , <u>320</u> (material) (depth)			
<u>4"</u> (size) If telescope see back.			
(5) screen <u>40ft</u> , <u>320</u> (length) (depth to top)			
<u>4"</u> , <u>PVC</u> (size) (material)			
(6) pump <u>5</u> , <u>100</u> (HP) (yield gpm)			
<u>AC</u> (type power)			
(7) electric log <u>Yes</u> (yes or no)			
<u>M.L.S.</u> (organization running log)			
(8) how well bottom plugged <u>backwash</u>			
DRILLERS REMARKS:			

CODED

RECEIVED
MAY 19 1977

MISS. BD. OF WATER COMM

COCKFIELD DATA SHEET-VERIFICATION CHECKLIST

COUNTY HUMPHREYS

QUAD LOUISE

WELL OWNER ANDERSON MINNOW FARM

U.S.G.S. NO. 1K26

B.O.H. NO. _____

OLWR NO. _____

CHECKED
EJP
11-8-95

LOCATION:

MAP SE, SE, SE, SE S24, T13N, R4W

GPS _____

97' (in pit below ground level) at base of levee 8/12/96 LUV

ELEV. (MSL) 100' (prob. higher on levee?)

W.L. (L.S.) (1) -87.05' 5-11-95

(2) -86.30' "

HEAD (MSL) 9
12.95'

SCREENED INTERVAL 320'-360' (LS) | -22³' - -26³' (MSL)

AQUIFER VERIFIED COCKFIELD

PREVIOUS W.L. -33.02' (10/23/89) | -29.12' (10/10/80) | -26' (5/13/77)

DATA ENTERED _____

JWJ
L
JWJ

