

GW 13309 OOH# 270004-02 Louise

WRD Exp. (GW)  
April 1966

Well No.

K11

WELL SCHEDULE

U. S. DEPT. OF THE INTERIOR

GEOLOGICAL SURVEY

WATER RESOURCES DIVISION

OCT 20 1975

MASTER CARD JAE

senior-Layne

10-19-75

LOUISE

PUNCHED

Record by P.E. Grantham Source of data E Log + Dvr Date 7-1-67 Map Bayland Grad

State Mississippi 52 County Humphreys 2

Latitude: 32 59 02 N Longitude: 09 03 03 W Sequential number: 2

Lat-long accuracy: 2 T. 13 R. 4 Sec 10 SENE SW SE

Local well number: K 0 1 1 C D 1 0 1 3 N O 4 W Other number: B & H

Local use: 0 6 4 0 2 7 Owner or name: Town of Louise #2

Owner or name: LOUISE Address:

Ownership: County, Fed Gov't, City, Corp or Co, Private, State Agency, Water Dist M

Use of Air cond, Bottling, Comm, Dewater, Power, Fire, Dom, Irr, Med, Ind, P S, Rec, water:

Stock, Instit, Unused, Repressure, Recharge, Desal-P S, Desal-other, Other P

Use of well: Anode, Drain, Seismic, Heat Res, Obs, Oil-gas, Recharge, Test, Unused, Withdraw, Waste, Destroyed. W

DATA AVAILABLE: Well data Freq. W/L meas.: Field aquifer char.

Hyd. lab. data:

Qual. water data; type: 372 (USGS) C

Freq. sampling: Pumpage inventory: no, period:

Aperture cards:

Log data: E Log 10-905 D Log (MBWC) D E

WELL-DESCRIPTION CARD

SAME AS ON MASTER CARD Depth well: 907 ft Meas. 9 0 7 accuracy 3

Depth cased: 867 ft Casing type: Steel Diam. 8.6 in

Finish: porous gravel w. gravel w. horiz. open (C) (F) (G) (H) (O) (P) (S) (T) (W) (X) (Z) S

Method: air bored, cable, dug, hyd jetted, air (A) (B) (C) (D) (H) (J) (P) (R) (T) (V) (W) (X) (Z) H

Drilled: -6-67 9 6 7 Pump intake setting: 5" Pump below ft 1 4 8

Driller: Layne Central Jackson, Miss

Lift (type): air, bucket, cent, jet, multiple, multiple, none, piston, rot, submerg, turb, other T Deep

Power (type): diesel, gas, gasoline, hand, gas, wind; H.P. 30 V Trans. or meter no.

Descrip. MP 110 ft below LSD, Alt. MP

Alt. LSD: 100' 1 0 0 Accuracy: 5' CI

Water Level 16 ft below MP; Ft below LSD 1 6 Accuracy:

Date meas: 6 6 7 Yield @ 70' 2 5 0 gpm Method determined

Drawdown: Accuracy: Pumping period hrs

QUALITY OF WATER DATA: Iron Sulfate Chloride Hard.

Sp. Conduct 370 K x 10^6 3 Temp. 26 C F 2 6 0 Date sampled 3-??-72 3 7 2

Taste, color, etc. pH=9.05

10/23/89  
WL = 36.14

960' 8"  
40' 6"  
.010

Turbines  
11/10/80  
5' min  
30  
3.81  
26.19  
3.0 MDC  
23.17  
105  
23  
8%

PUNCHED and VERIFIED

Well No.

Latitude-longitude \_\_\_\_\_  
N  
S  
d m s d m s

**HYDROGEOLOGIC CARD**

**SAME AS ON MASTER CARD** Physiographic Province: 0:3 Section: \_\_\_\_\_

Drainage Basin: E 15:4 Subbasin: \_\_\_\_\_

Topo of well site: (D) depression, (C) stream channel, (E) dunes, (F) flat, (H) hilltop, (K) sink, (L) swamp, (M) offshore, (P) pediment, (S) hillside, (T) terrace, (U) undulating, (V) valley flat \_\_\_\_\_

MAJOR AQUIFER: system \_\_\_\_\_ series TE aquifer, formation, group SPRT 5:5

Lithology: \_\_\_\_\_ Origin: 2 Aquifer Thickness: ≥ 60 ft

Length of well open to: \_\_\_\_\_ ft 4:0 Depth to top of: \_\_\_\_\_ ft 8:4:5

MINOR AQUIFER: system \_\_\_\_\_ series \_\_\_\_\_ aquifer, formation, group \_\_\_\_\_

Lithology: \_\_\_\_\_ Origin: \_\_\_\_\_ Aquifer Thickness: \_\_\_\_\_ ft

Length of well open to: \_\_\_\_\_ ft \_\_\_\_\_ Depth to top of: \_\_\_\_\_ ft \_\_\_\_\_

Intervals Screened: 867-907, .010 GA, 6" SS

Depth to consolidated rock: \_\_\_\_\_ ft \_\_\_\_\_ Source of data: \_\_\_\_\_

Depth to basement: \_\_\_\_\_ ft \_\_\_\_\_ Source of data: \_\_\_\_\_

Surficial material: \_\_\_\_\_ Infiltration characteristics: \_\_\_\_\_

Coefficient Trans: \_\_\_\_\_ gpd/ft \_\_\_\_\_ Coefficient Storage: \_\_\_\_\_

Coefficient Perm: \_\_\_\_\_ gpd/ft<sup>2</sup>; Spec cap: \_\_\_\_\_ gpm/ft; Number of geologic cards: \_\_\_\_\_

*log still in sand.*

*Pump not installed as of 7-20-67, no capacity test run.*

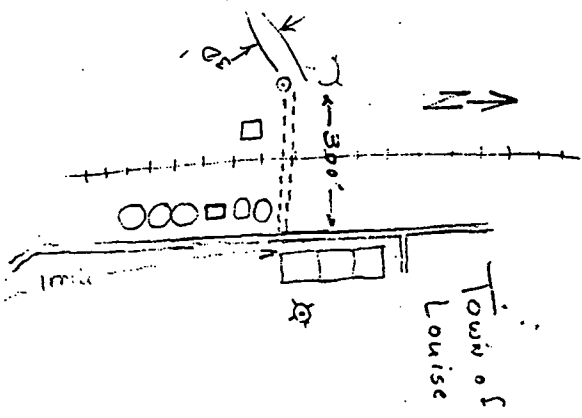
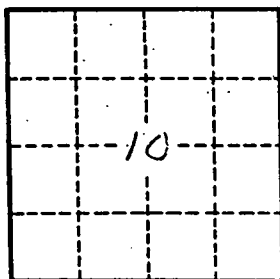

Well No. \_\_\_\_\_

CODED  
5 107 + 27

Humphreys  
K 11  
7-67  
Elec Log

MISSISSIPPI  
BOARD OF WATER COMMISSIONERS  
416 North State Street  
Jackson, Mississippi 39201

WATER WELL DRILLERS LOG

1967 Layne-Central Co. Humphreys  
date well completed firm name county well located

LANDOWNER:	description of formations encountered	from	to
TOWN OF LOUISE, MISS.	Brown Clay	0	18
" " (mailing address)	FINE SAND STRS OF CLAY	18	60
WELL LOCATION:	COARSE SAND & GRAVEL	60	148
sec. 10 T-13 N R-4 E	Clay	148	230
6 1/2 miles (distance) of Louise (direction) (nearest town)	Sandy Shale	230	312
WELL PURPOSE: Municipal (home, irrigation, municipal, industrial)	FINE SAND, STRS SHALE & LIGNITE	312	400
WELL COMPLETION DATA:	Shale, STRS OF SAND	400	540
(1) diameter (inches) 8"	Tough Gumbo, Hard STRS	540	550
(2) total depth (feet) 909'	Shale and Sand	550	600
(3) static water level (feet) 16' below top of ground.	Clay with hard STRS,	600	667
(4) casing Steel (material), 867' (depth)	Gumbo	667	830
8" (size) If telescope see back.	Sandy Shale	830	859
(5) screen 40' (length), 867' (depth to top)	Sand	859	907
6" (size), Stainless Steel (material)	Clay	907	909
(6) pump 30 (HP), (yield gpm)			
Electric (type power)			
(7) electric log YES (yes or no)			
U.S.G.S. (organization running log)			
(8) how well bottom plugged			
DRILLERS REMARKS:			
Pump not installed as of this date. NO CAPACITY TEST RUN -			

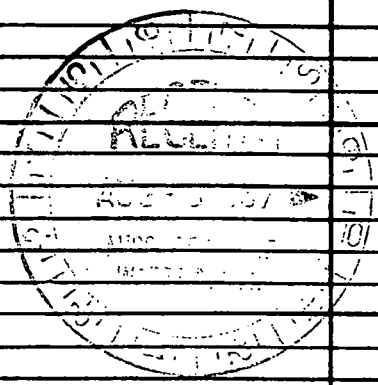

DATA SHEET-VERIFICATION CHECKLIST

COUNTY HUMPHREYS QUAD LOUISE

WELL OWNER LOUISE (Well #2)

CHECKED  
EMB  
11-7-95

U.S.G.S. NO. K-11

B.O.H. NO. 270004-02

JNH

OLWR NO. \_\_\_\_\_

LOCATION:

MAP <sup>SE</sup> NE, SW, SE S10, T13N, R4W

L

GPS \_\_\_\_\_

\_\_\_\_\_

ELEV. (MSL) 105'

L

W.L. (L.S.) (1) -34.45' 5-9-95

L

(2) -34.45' "

L

HEAD (MSL) 70.55'

L

SCREENED INTERVAL 867'-907' (LS) | -762' - -802' (MSL)

JNH

AQUIFER VERIFIED SPARTA

L

PREVIOUS W.L. -36.14' (10/23/89) | -23.19' (11/10/80) | -16' (6/1/67)

JNH

DATA ENTERED \_\_\_\_\_

\_\_\_\_\_

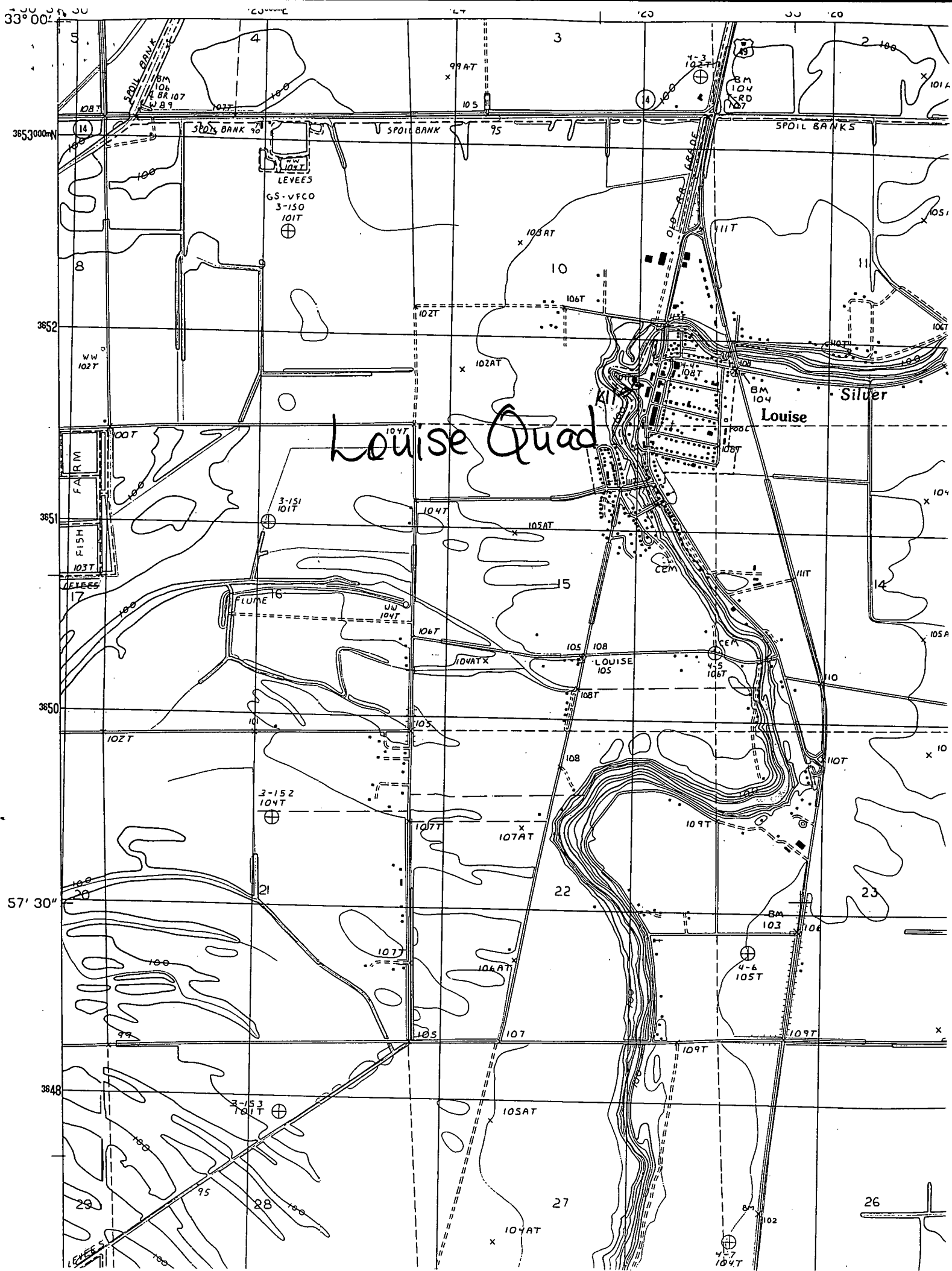

DEPARTMENT OF ENVIRONMENTAL QUALITY - OLWR

PUBLIC SUPPLY WELLS PROJECT

GPS LOG

USER NAME(S): LAR / CAH DATE: 12/12/94  
UNIT DEQ #: 82555 FILE #: C121215A  
HEALTH DEPT. #: 270004-02 ELEV. 100  
USGS #: \_\_\_\_\_ OLWR #: \_\_\_\_\_  
OWNER: Town of Louise QUAD: Louise  
LOCATION: SW/SE S 10 T B N R 4W COUNTY: Humphreys  
LOCATION DESCRIPTION: well located in lg. fenced area SW  
of Elevated Tank.  
CASING DIA: 6" PUMP TYPE & SIZE: Turbine / 30 <sup>Elev.</sup>  
GPS FIELD LOCATION: LAT. 32° 58.57 N LONG. 90° 35.33 W  
GPS CORRECTED LOCATION: LAT. 32.98306764 LONG. 90.59241147  
REMARKS: From Co. Line 3 1/2 miles, North Turn At Louise  
(old 49w Hwy) sign left, go 1.4 miles NW to Elevated Tank.  
GPS At well  
(Streets in Louise do not have street names.)

UNITED STATES  
DEPARTMENT OF THE INTERIOR  
GEOLOGICAL SURVEY

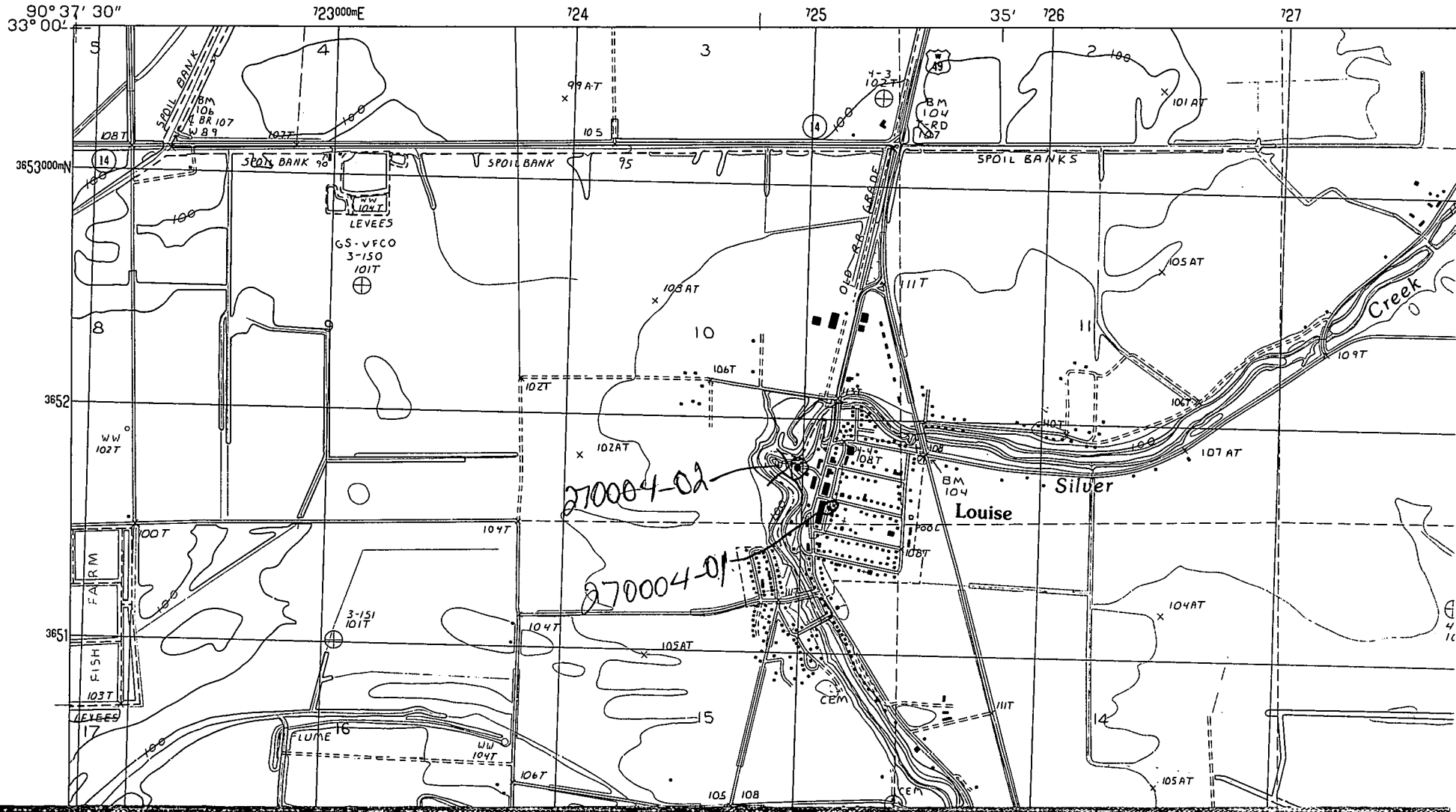

90° 37' 30"  
33° 00'

723000mE

724

725

35' 726

727

3653000mN

3652

3651

270004-02

270004-01

Louise

Silver

Creek

