

Coded By 16/198
Checked By 16/198
Entered By 1/24/11
Date 1/25

U.S. GEOLOGICAL SURVEY
WATER RESOURCES DIVISION
MISSISSIPPI DISTRICT

Well No. J83
E-Log No. _____
County HUMPHREYS
Agency _____

WELL RECORD

Agency Code U S G S Site Id 143131010151010910121913101011 Project No. 5 *Hatchery Well*

Station Name 12 J1018131 ISIANDILLINGIS I+ SITEVIEWNSI * Latitude 9 3131010510 Longitude 104 0191021913101

Lat/Long Ac. 11 S F T M Dist 6=28 State 7=28 County 8=015131 Land Net 13 NW 1/4 SEC 13 T11N R14E S13W *

Location Map 14= IS112LVIEK1 K1171Y1 Altitude 16=11021 Met/Meas 17= A L M Accuracy 18= 1 131 Hydrologic Unit 20= 0181013101210171

Agency Use 803= A Y O Date Inventoried 711= Station Type Y Data Type 804=

Instru. 805= Remarks 806= Relia. 3= C L M U 2=W

Date of Construction 21= 051 / 12181 / 111918171 * Well Use 23= W * Water Use 24= P * Primary Aquifer 714= 124151P K T T * Hole Depth 27= 1910101

Well Depth 28= 1910101 Water Level 30= 13171 Water Level Date 31= 0151 / 12181 / 111918171 * Method 34= 1 * Status 37= 1 * Source 33= D

CONSTRUCTION DATA

Construction Date 60= 0151 / 12181 / 111918171 * Contractor 63= 446171 Name JERROL Method 65= H1 Finish 66= P1

CONSTRUCTION CASING DATA

Top/Casing 77= 11101 Bot/Casing 78= 1118101 Diameter 79= 141

Top/Casing 77= 1118101 Bot/Casing 78= 1815101 Diameter 79= 121

CONSTRUCTION OPENINGS DATA

Top/Depth 83= 1815101 Bot/Depth 84= 1910101 Diameter 87= 121 Type 85= P * Length 89= 15101 Width 88= 101101

Top/Depth 83= Bot/Depth 84= Diameter 87= Type 85= Length 89= Width 88=

CONSTRUCTION LIFT DATA

Lift Type 43= S Date 38= 0151 / 12181 / 111918171 * Intake 44= 1110151

Power 45= H.P. 46= Serial No. 49=

MISCELLANEOUS OWNER DATA

Date of Ownership 159= 0151 / 12181 / 111918171 * Owner Name 161= ISIANDILLINGIS I+ SITEVIEWNSI

MISCELLANEOUS OTHER ID DATA

E-Log No. 190= Assigner 191= M I S S I D I S T *

MISCELLANEOUS QW DATA

R=192	T=A	738#1	Date of Measurement 1934 / / / / / / / / *	Aquifer Sampled 1954 / / / / / / / / *	Par. Code 196#00010	Value 1974 / / / / /
R=192	T=A	738#2	Date of Measurement 1934 / / / / / / / / *	Aquifer Sampled 1954 / / / / / / / / *	Par. Code 196#00095	Value 1974 / / / / /
R=192	T=A	738#3	Date of Measurement 1934 / / / / / / / / *	Aquifer Sampled 1954 / / / / / / / / *	Par. Code 196#00400	Value 1974 / / / / /

MISCELLANEOUS LOGS DATA

R=198	T=A	739#1	Log Type 199#D *	Beg. Depth 2004 / / / 0 / *	End Depth 2014 1100 / *
R=198	T=A	739#1	Log Type 199# / *	Beg. Depth 2004 / / / / / *	End Depth 2014 / / / / / *

MISCELLANEOUS NETWORK DATA

R=114	T=A	730#1	Network Type 706 / *	Beg. Year 1154 / 9 / / *	End Year 1164 / 9 / / *
R=121	T=A	730#1	Analysis 120 / *	Agency Source 1174 / / / / *	Freq. 1184 / *

MISCELLANEOUS REMARKS DATA

R=183	T=A	311#1	Date of Remarks 1844 / / / / / / / / *	Remarks 1854 / / / / / *
-------	-----	-------	---	-----------------------------

DISCHARGE DATA

R=146	T=A	147#1	148-0151 / 12181 / 11918171 *	703#PH	1504 / / / 1812 / *	2724 / / / / / *
-------	-----	-------	-------------------------------	--------	---------------------	------------------

GEOHYDROLOGIC DATA

R=90	T=A	721#1	Depth Top 914 1810101 / *	Depth Bot. 924 / / / / / *	Unit Id 934 / 1214 / SPIRIT *
------	-----	-------	------------------------------	-------------------------------	----------------------------------

HYDRAULIC DATA

R=98	T=A	790#1	Unit Tested 1004 / / / / / / / / *	1034 / / *	WELL YIELDED 80 GPM WITH 45 FT. DRAWDOWN AFTER 1 HOUR
------	-----	-------	---------------------------------------	------------	---

6 mi. E of Midnight

836-5431 James Sandling
836-5719 Chuck McCarty
836-5340 office + hatching

DESCRIPTION OF FORMATIONS ENCOUNTERED	FROM	TO
Top	0	20
Sand + Gravel	20	123
Sand set	800	900

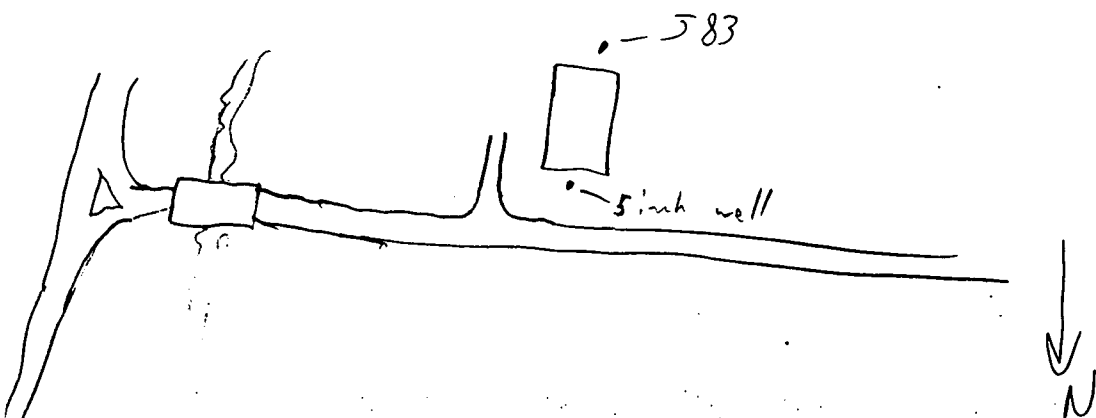

MISSISSIPPI DEPARTMENT OF NATURAL RESOURCES

Bureau of Land and Water Resources

COUNTY WELL LOCATED <i>Humphreys</i>	
WELL NUMBER <i>5 83</i>	CODER <input checked="" type="checkbox"/>
DATE WELL COMPLETED <i>5-28-87</i>	

PERMIT NUMBER
NAME OF DRILLING FIRM <i>Teerdt's P. & Well</i>

P.O. Box 10631
Jackson, Mississippi 39209
WATER WELL DRILLERS LOG

NAME & MAILING ADDRESS OF LANDOWNER <i>Sandlings + Stevens Fisheries Silver City Ms.</i>			
WELL LOCATION: SEC	TOWNSHIP	RANGE	
<i>0</i>	<i>34</i>	<i>14</i>	<i>N 3 E</i>
DISTANCE	DIRECTION	NEAREST TOWN	
<i>6</i> Miles	<i>E</i>	of <i>Midnight</i>	
OTHER LANDMARK			
WELL PURPOSE: Home, Irrigation, <input checked="" type="checkbox"/> Municipal, Industrial, Fish Pond, etc.			

PUMP DATA		
PUMP TYPE (Circle One): <input checked="" type="checkbox"/> Submersible, <input type="checkbox"/> Turbine, <input type="checkbox"/> Jet, <input type="checkbox"/> Flowing Well, <input checked="" type="checkbox"/> Other (Describe)		
POWER TYPE (Circle One): <input type="checkbox"/> Electric, <input type="checkbox"/> Tractor, <input type="checkbox"/> Diesel, <input type="checkbox"/> Gasoline, <input type="checkbox"/> Butane, <input type="checkbox"/> Other (Describe)		
Pump Capacity (GPM)	No. of Stages	Setting Depth
<i>80</i>	<i>13</i>	<i>105</i> FT.
PUMP TEST		
Well yielded <i>80</i> GPM with a drawdown of <i>45</i> ft. after <i>1</i> hours of pumping		

WELL DATA		
Well Depth	Casing Diameter (In.)	Casing Length (Ft.)
<i>900</i>	<i>4x2</i>	<i>850'</i>
Type of Casing	Hole Depth	Depth to Static Water Level
<i>PVC</i>	<i>900</i>	<i>37</i>
TYPE OF COMPLETION: (Circle One or More): <input type="checkbox"/> Gravel Packed, <input type="checkbox"/> Underreamed, <input checked="" type="checkbox"/> Telescoped, <input type="checkbox"/> Natural Development, <input type="checkbox"/> Open Hole, <input type="checkbox"/> Other (Describe)		
Top of Lap Pipe or Reduction in Casing		
<i>180</i> FEET	IF TELESCOPED OR MORE THAN ONE SCREEN: USE BACK PAGE	

LOG DATA	
TYPE OF LOG RUN (Circle One): <input checked="" type="checkbox"/> No Log Run, <input type="checkbox"/> Electric, <input type="checkbox"/> Gamma Ray, <input type="checkbox"/> Density, <input type="checkbox"/> Sonic, <input type="checkbox"/> Neutron, <input type="checkbox"/> Other (Describe)	
Name of Organization Running Log	

SCREEN DATA		
Diameter - Inches	Length - Feet	Slot Size - Inches
<i>2"</i>	<i>50</i>	<i>.010</i>
Screen Type	Depth to Bottom - Feet	
<i>PVC</i>	<i>850 to 900</i>	

GEOLOGIC DATA (Office Use Only)			
Surface Elev.	Geologic Unit	Unit Thickness	Depth to Top
Subs. SWL	Date	Analysis	Aquifer Test
Driller's Remarks			

DESCRIPTION OF FORMATIONS ENCOUNTERED	FROM	TO	FORMATIONS (Continued)	FROM	TO
<i>Top</i>	<i>0</i>	<i>20</i>	RECEIVED <i>NOV 13 1987</i> Department of Natural Resources Bureau of Land & Water Resources		
<i>Sand + Gravel</i>	<i>20</i>	<i>123</i>			
<i>Sand set</i>	<i>800</i>	<i>900</i>			

IF MORE SPACE IS NEEDED, USE BACK

If well telescopes please sketch and show depths.

GROUND LEVEL

180'
4"

PVE

670'
2"

PVE

50'

2" PVE
Screen

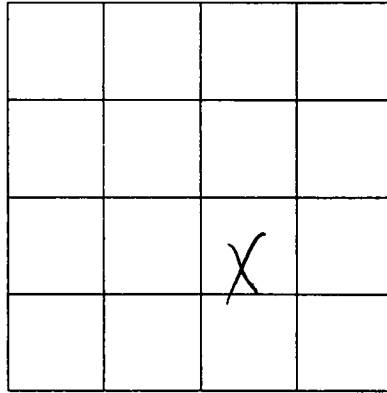

SECTION _____

Please indicate well location X.

ADDITIONAL INFORMATION

If more than one screen,
show location of each on sketch.

DATA SHEET-VERIFICATION CHECKLIST

COUNTY HUMPHREYS

QUAD SILVER CITY

WELL OWNER SANDLING & STEVENS (SILVER CITY) Hatchery Well

CHECKED
EJB
11-8-95

U.S.G.S. NO. J-83

B.O.H. NO. _____

OLWR NO. _____

LOCATION:

NW CORNER of
MAP SW NW NE S34 T14N R3W

✓

GPS _____

ELEV. (MSL) 102'

✓

W.L. (L.S.) (1) -29.38' 1-29-96

JHJ

(2) -29.39' "

JHJ

HEAD (MSL) 72.61'

JHJ

SCREENED INTERVAL 850'-960' (LS) | -748' - -798' (MSL)

JHJ

AQUIFER VERIFIED SPARTA

✓

PREVIOUS W.L. -37' (5/28/87)

JHJ

DATA ENTERED _____

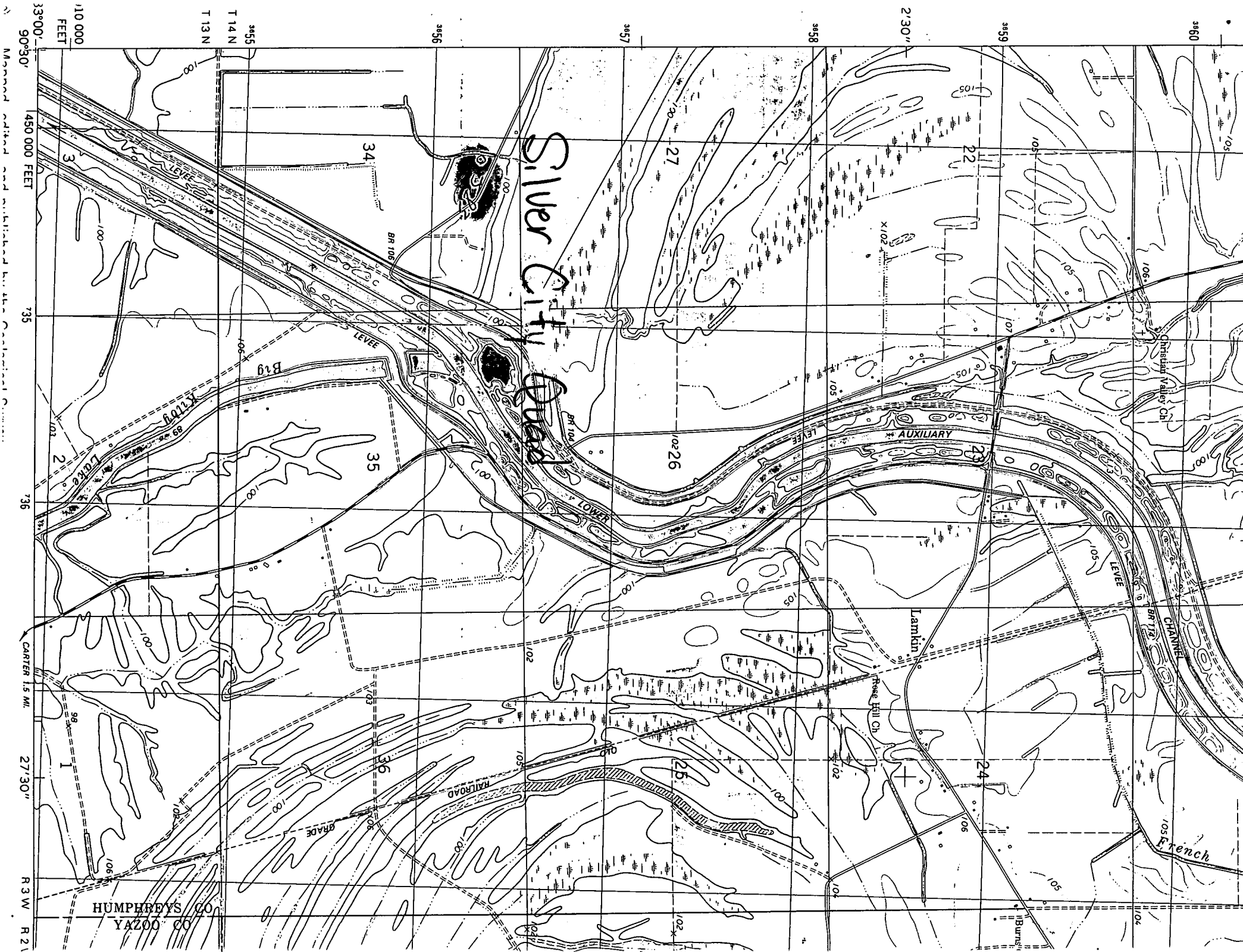

Silver City Duval

HUMPHREYS CO
YAZOO CO

33°00' 33°30' N
90°30' 90°00' W
Manned edited and published by the National Oceanic and Atmospheric Administration

1:10,000 FEET
450,000 FEET
CARTER 1.5 MI.
R 3 W R 2 E