

Was called J500

GW08227

1610
Midnight Quad

TRANSMITTED FOR ADP

Recorded by BRR

Date 2/14/86

Agency USGS

U.S. GEOLOGICAL SURVEY
WATER RESOURCES DIVISION
MISSISSIPPI DISTRICT

Well No. J 74

E-Log No. _____

County HUMPHREYS

WELL RECORD

Site Id 3302080903112401 R=0* T=A* 2=W* Data reliab. 3=U* &

Dist. 6=28* State 7=28* Co. 8=1053* Lat. Long. 9=3302081* 10=090311241*

GEN SITE DATA
Well NO. 12=J0741* Location SW 13=NEW E S 20 T 114 N R 03 W 1* Alt. 16=1000.1*

Hyd. Unit (MWD) 20=080302071* Date 21=19851051081* (YYYYMMDD)

Agency Use 803=01* Well Use 23=W1* Water Use 24=01* Hole depth 27=1114.1* Well depth 28=1114.1*

ML 30=128.1* Date 31=19851051081* Source 33=01*

Project No. 5= owner from permit:
Elizabeth Roberts

LIFT
R=42* T=A* 254#1* Date 38=19851051081* Lift Type 43=S1* Intake 44=

Power Type 45=E1* H.P. 46=10.1*

CONSTR
R=58* T=A* 723#1* Date 60=19851051081* Drlg 63=405* Name LARRY'S WELL
NAME

Method 65=R1* Finish 66=S1* Remarks _____

CASING
R=76* T=A* 725#1* 59#1* Top csng 77# Bot. csng 78=174.1* Diam. 79# 8.1*

R=76* T=A* 725#2* 59#1* Top csng 77# Bot. csng 78= Diam. 79#

R=82* T=A* 726#1* 59#1* Top 83# Bottom 84=1114.1* Type 85=S1*

OPENINGS
Diam. 87# 8.1* Size 88=

R=82* T=A* 726#2* 59#1* Top 83# Bottom 84= Type 85=

87= 88=

AQUIFERS
R=90* T=A* 721#1* Top 91=154.1* Bot 92=1114.1* Unit Id 93=112MRA*

R=90* T=A* 721#2* Top 91= Bot 92= Unit Id 93=

HYDRAULICS
R=98* T=A* 99#1* Unit tested 100= 103=

R=105* T=A* 99#1* Test No. 106# 107= Transmissivity (gal/d)/ft _____

108= Hydraulic cond. (gal/d)/ft² _____ 110= Storage coeff. Boundaries _____

If well telescopes please sketch and show depths.

GROUND LEVEL

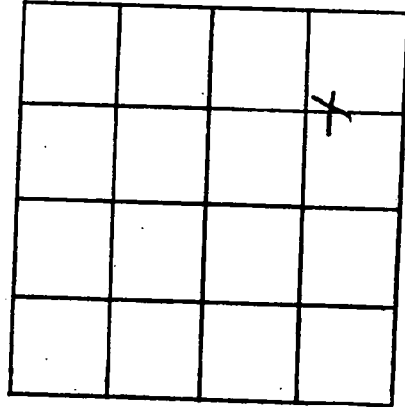

SECTION 20

Please indicate well location X.

ADDITIONAL INFORMATION

If more than one screen, show locations of each on sketch.

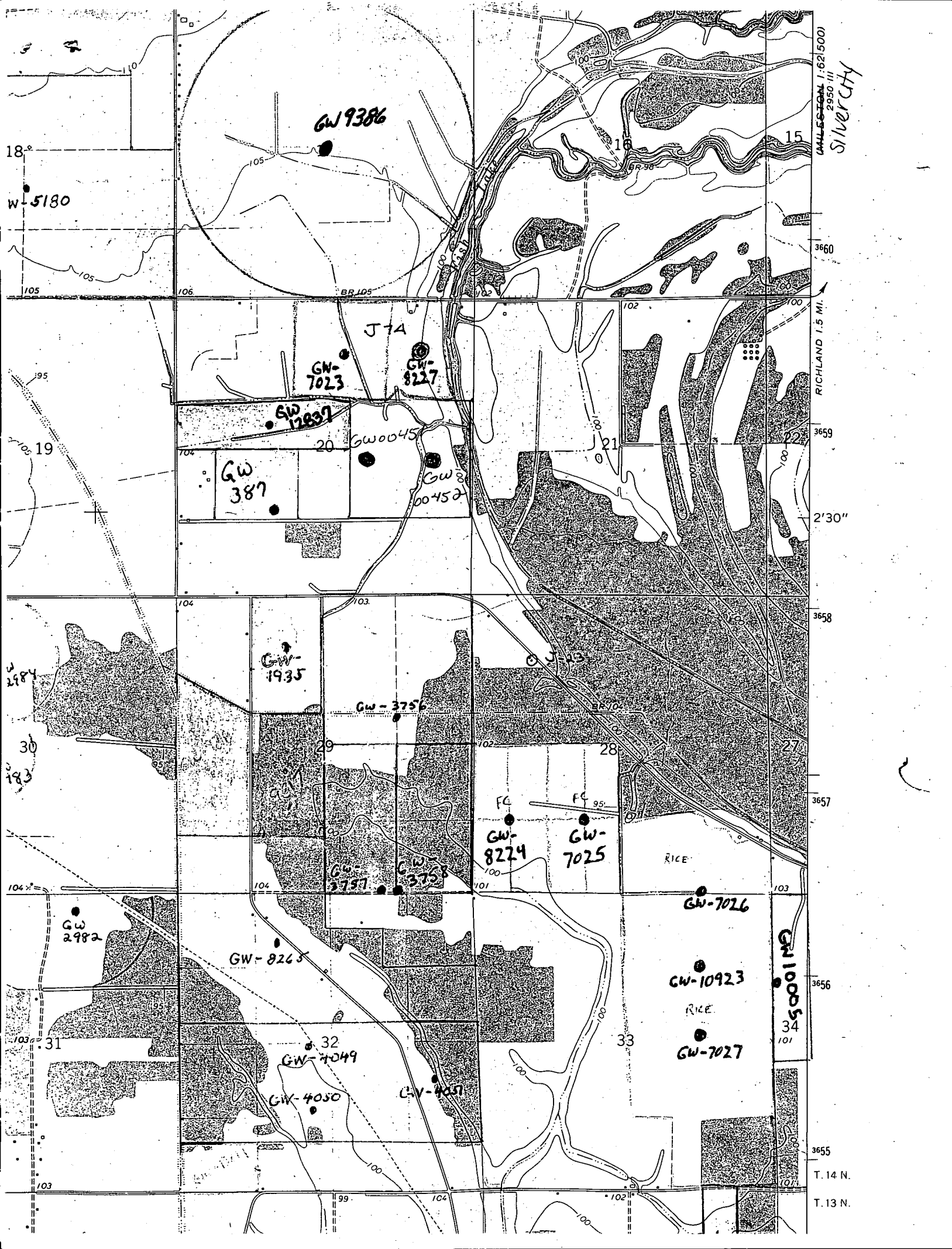

CALIFORNIA 1:62,500
2950 III
SILVER CITY

RICHLAND 1.5 MI.

2'30"

T. 14 N.
T. 13 N.

GW 9386

W 5180

J 74

GW 7023

GW 8227

GW 12837

GW 0045

GW 387

GW 0045

GW 1935

GW 3756

FC 95
GW 8224

FC 95
GW 7025

RICE

GW 7026

GW 10923

RICE

GW 7027

GW 8263

GW 4049

GW 4050

GW 4051

GW 10925

34

RETURN COMPLETED FORM TO:
Bureau of Land and Water Resources
P.O. Box 10631
Jackson, Mississippi 39209
Telephone (601) 961-5200

For Office Use Only:	
County:	<u>Humphreys 053</u>
Date Received:	<u>1-6-88</u>
Permit No:	<u>Gr-008227</u>
Quad Map:	<u>Midnight</u>
Water Management Dist:	
Hydrologic River Basin:	<u>D8030207</u>

NC
CMG

Department of Land & Water Resources
Bureau of Land & Water Resources

NOTICE OF CLAIM FOR CONTINUED USE OF SURFACE/GROUND WATERS FOR BENEFICIAL USE

Pursuant to the laws of the State of Mississippi, namely §51-3-5 (2) or (3), as amended, I, the landowner, _____

Elizabeth Roberts (Name) 426-16 7279 (S/S or Tax ID No.)
P.O. Box 84 (Address) Silver City (City or Town) MS 39166 (State and Zip)
(601) 247-1993 (Telephone Number)

_____, do hereby file claim for the continued use of: (circle one)

surface water ground water for the following beneficial use: (circle one or more)

municipal; irrigation; recreation; livestock water; fish culture; industrial;

Other _____ (Specify)

1. Name & Address of agent or applicant if different from landowner.

~~Silver City Farms~~ (Name) 64-0726 258 (S/S or Tax ID No.) P.O. Box 84 (Address)
Silver City (City or Town) MS 39166 (State and Zip) (601) 247-1993 (Telephone Number)

2. Location of point of diversion/withdrawal (include location map with claim)

NE 1/4 of NE 1/4 of Section 20, Township 14N, Range 3W, County Humphreys 053

3. Volume of water diverted/withdrawn:

- (1) 600 125 acre feet per year, diverted/withdrawn at a maximum rate of 2000 1000 gallons per minute; or
- (2) _____ million gallons per day, diverted/withdrawn at a maximum rate of _____ gallons per minute.

4. Description of lands on which water will be used:

(a) Copy legal description of property upon which water is to be used (may be copied word for word from your deed).

Attach separate sheet if necessary _____

(b) Has the above described land any water right or source of water supply other than that herein applied for?

(Water Rights Number(s) _____) Describe the nature and amount of any additional supply _____

SECTION A (to be completed if source of water is from surface supply)

1. Prior water rights permit/license number ISS. 3-28-89, dated EXP. 3-28-99

2. Source of supply is LAT. 33-02-58 which drains into LONG. 90-31-22
ELEV. 100 which drains into _____

3. Description of diversion works:

(a) Water obtained directly from stream: _____ (Name)

Pump _____ (Size and type) Power Unit _____ (Size and type)

Lift _____ ft. Maximum capacity _____ gpm

(b) Storage reservoir _____ (Name)

Height of dam _____ feet. Surface area at normal pool _____ acres

Storage capacity at normal pool _____ acre feet

SECTION B (to be completed if source of water is from underground supply)

- Source of supply: M5 River Alluvium aquifer(s)
 - Description of water well:
 - Well data:**
 - Date well completed 2-1-85
 - Depth drilled 116 feet
 - Type of completion _____
 - Surface elevation _____ feet
 - Screen data:**
 - Depth to bottom 116 feet
 - Length 40 feet
 - Diameter 12 inches
 - Type Steel
 - Slot _____ inches
 - Casing data:**
 - Length(s) 28 feet;
 - Type PVC
 - Pump data:**
 - Type & Size _____
 - Capacity 2000 gpm
 - No. stages _____
 - Setting depth _____ feet
- Well Driller Harry Wells Pump (Name of Company)

WATER USE DATA

1. IRRIGATION use: (a) Show number of acres to be irrigated by 40-acre blocks:

TOWN-SHIP	RANGE	SEC.	NE¼				NW¼				SW¼				SE¼				TOTALS
			NE¼	NW¼	SW¼	SE¼	NE¼	NW¼	SW¼	SE¼	NE¼	NW¼	SW¼	SE¼	NE¼	NW¼	SW¼	SE¼	

- List the acres to be irrigated: Rice _____; Cotton _____; Corn _____; Pasture _____; Truck _____; Other crops (_____) _____ acres.
- If for MUNICIPAL use: (a) Present population _____, (based on 19____ Census)
 (b) Estimated average daily consumption during periods of maximum use at the end of each five-year period in next twenty years:
 _____ 19____; _____ 19____; _____ 19____; _____ 19____.
 - If for INDUSTRIAL use: (a) If water is to be released into a watercourse, indicate: Amount released each year _____; rate of release _____; location of release point in reference to diversion point _____ (show location on map)
 (b) Explain any change in quality of water to be released: _____
 - If for RECREATIONAL use: Explain how water will be used _____
 - If for FISH CULTURE use: (a) Explain in detail how water will be used flush ponds
 (b) Number of times reservoir will be emptied and filled annually: _____
 - If for ANY OTHER use: (a) Explain in detail _____

REMARKS _____

List below the name and address of person to be contacted for additional information, if required.
Ronnie Roberts
 (Name)
508 Ave
 (Address)
Belzoni, MS

The accompanying map is hereby declared a part of this application.
Ronnie Roberts
 (Signature)

Subscribed and sworn to before me this 4th day of January 1988, at Belzoni
 County of Lumpkin, Mississippi. My commission expires My Commission Expires 8-26-90
Deanne Rodgers Dault Notary Public