

6/75 WTC

GW-03808

DOI # 870018-01

T/ADP/9/83

Recorded by LR/BW

U.S. GEOLOGICAL SURVEY
WATER RESOURCES DIVISION
MISSISSIPPI DISTRICT

midnight quad

Well No. H 31

Date 11/10/80

E-Log No. 58 58

^{10/27/79} WL = 36.02

WELL RECORD

MIDNIGHT
167D

County Humphreys

WL - 27.52 ↓ MP

MP - top of base

WL - 29.52 ↓ LSD

Site ID 330245090342901

R=0*

T=A*

2=W*

Data reliab. 3=C*^C

Report agency 4=USGS*

Dist. 6=28*

7=28*

Co. 8=053*

Lat.

Long. 9=330245N*

10=0903429*

Well No. 12=H031*

Location

13=SENE S 23 T 14 N R 04 W*

Alt. 16=110* 107

Hyd. Unit (OWDC)

20=

Date 21=1010611980*

Well use

23=W*

Water Use

24=P*

Hole depth

27=745*

Well depth

28=741*

WL 30=25*

Date 31=1111011980*

Source 33=S*

Status 273=

Project No. 5=

R=158* T=A*

Date 159#1012211980*

Owner No. Well #2

Owner 161=HUMPHREYS, C. W. A. *

near midnight

at midnight

R=192* T=A*

Date 193#0411011981*

Temp. 196#00010*

197=22.5*

R=192* T=A*

Date 193# / / *

Cond. 196#00095*

197=

R=192* T=A*

Date 193#0411011981*

pH 196#00400*

197=8.9*

R=58* T=A*

Date 60=1012211980*

Remarks

Drlg. 63=064*

Name Layne Overland

Method 65=H*

Finish 66=

R=76* T=A*

59#1*

Top csgn. 77# 0.*

Bot. csgn. 78=701.*

Diam. 79# 10.*

R=76* T=A*

59#1*

Top csgn. 77#

Bot. csgn. 78=

Diam. 79#

R=82* T=A*

59#1*

Top 83# 701.*

Bottom 84=741.*

Type 85=S*

Diam. 87=6.*

Size 88=.020*

R=82* T=A*

59#1*

Top 83#

Bottom 84=

Type 85=

Diam. 87=

Size 88=

YIELD R=146*

T=A*

147# 1*

Q 150=361.*

Q/S 272=

134 flows 146 pumped

60#

LIFT R=42* T= A * Lift type 43# T* Intake 44= 117* Power type 45= E*
 Date 38= 1/1/1/1/1980* H.P. 46= 25.*

LOGS R=198* T= A * Log 199# E* Top 200= 4.0.* Bot 201= 994.*
 R=198* T= A * Log 199# * Top 200= *.* Bot 201= *.*
 R=189* T= A * E Log No. 190# 058* 191= M I S S D I S T *

ANAL. R=114* T= A * Year 115# * Type 120= *

AQUIFERS R=90* T= A * 256# 1 * Top 91= 5.35.* Bot 92= 7.3/8.*
 Unit ID 93= 1245.P.R.T. * Name of Unit Sparta Sand
 R=90* T= A * 256# 1 * Top 91= *.* Bot 92= *.*
 Unit ID 93= * Name of Unit *

HYDRAULICS R=98* T= A * 99# 1 * Unit tested 100= * 103= *
 R=105* T= A * 99# 1 * Test No. 106# *
 107= * Transmissivity (gal/d)/ft *
 108= * Hydraul. cond. (gal/d)/ft² *
 110= * Storage coeff. Boundaries *

R=121* T= * Yr Begin 122# * Network 258=

Water Level Data Collection (1)

See Log 25.78 gpm/ft.

Fe = .2

DS = 258

H₂S small

WL 25.8 10/22/1980

33 gpm/ft rpt

0-24	14	Clay
24-32	58	Sand
32-76	19	Coarse sand & pebbles
76-108	72	Coarse sand & gravel
108-160	100	Sand
160-204	110	Clay
204-240	77	Sand
240-276	31	Sandy clay
276-312	42	Clay
312-348	216	Sand
348-392	154	Clay
392-436	15	Sandy clay & sandstone
436-480	15	Sandy silt
480-524	52	Hard clay

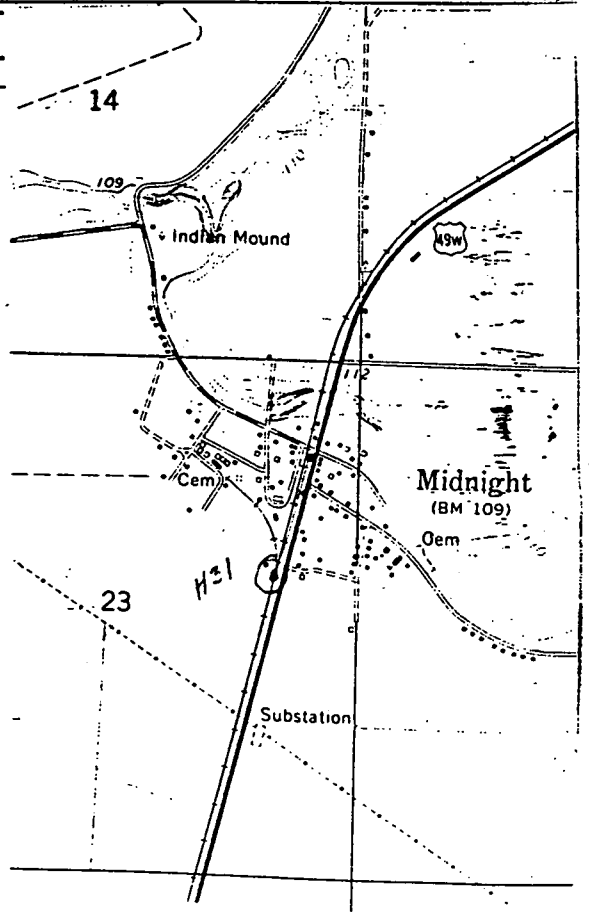

SPARTA DATA SHEET-VERIFICATION CHECKLISTCOUNTY HUMPHREYSQUAD: MIDNIGHTWELL OWNER HUMPHREYS CO. W.A. (MIDNIGHT WELL) (WELL #2)CHECKEDEWBU.S.G.S. NO. H-31B.O.H. NO. 270018-01JNH

OLWR NO. _____

LOCATION:

MAP S.W., SE, NE S23, T14N, R4W

GPS _____

ELEV. (MSL) 110'W.L. (L.S.) (1) -33.08' 5-9-95(2) -34.08' "HEAD (MSL) 75.92'SCREENED INTERVAL 701'-741' (LS) / -591' - -631' (MSL)AQUIFER VERIFIED SPARTAPREVIOUS W.L. -36.02' (10/27/89) / -24.52' (11/10/80) / -25.8' (10/22/80)

DATA ENTERED _____

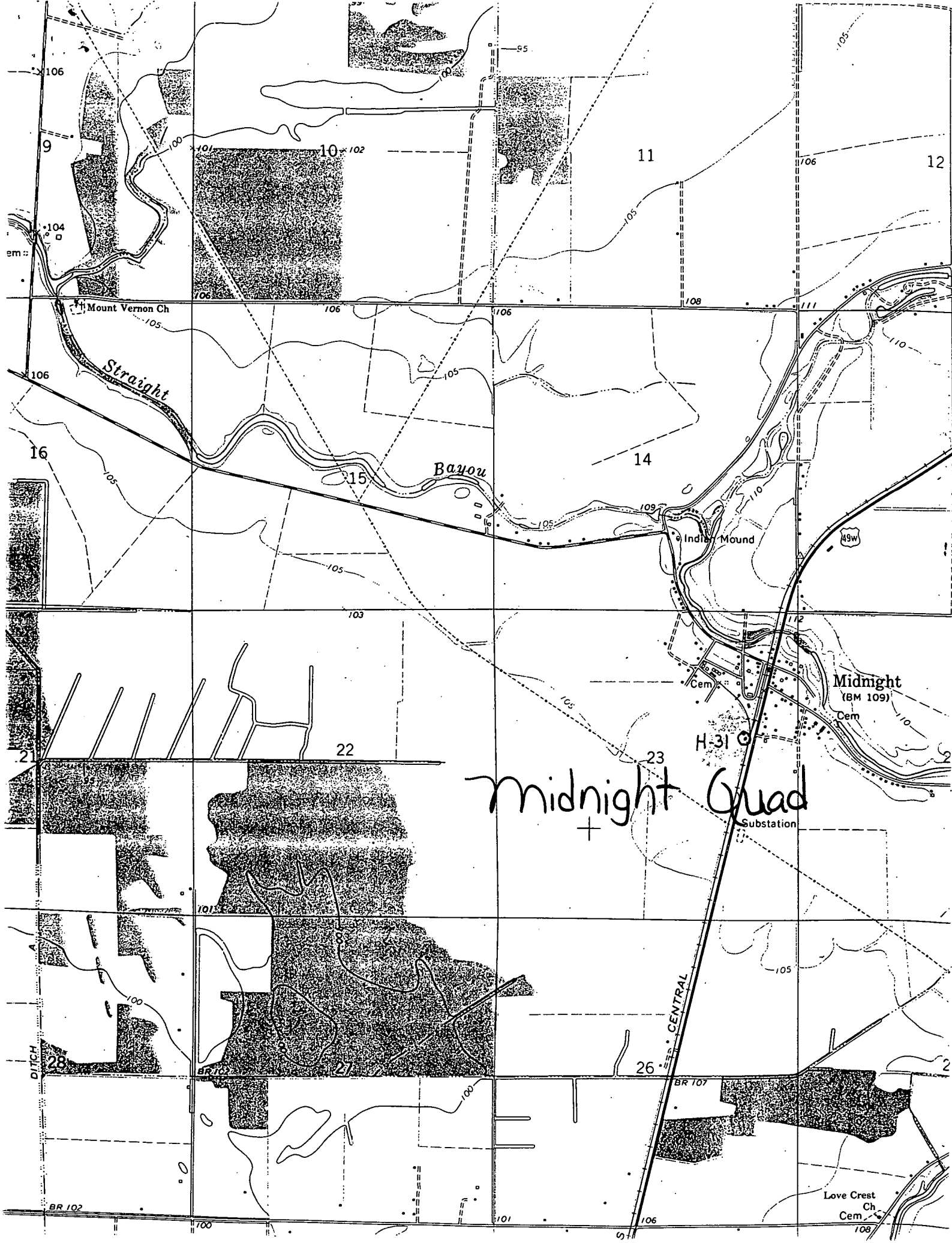

Midnight Quad

Straight

Bayou

Midnight
(BM 109)
Cem

H-31

Substation

Love Crest
Ch
Cem

CENTRAL

106

11

12

9

10

16

15

14

21

22

23

26

27

28

BR 102

BR 107

101

106

108

Mount Vernon Ch

Indian Mound

em

104

95

105

101

102

106

105

106

106

108

111

110

105

105

103

105

105

100

100

100

101

106

108

DITCH

BR 102

S

DEPARTMENT OF ENVIRONMENTAL QUALITY - OLWR

PUBLIC SUPPLY WELLS PROJECT

GPS LOG

USER NAME(S): LAR/CAH DATE: 12/13/94

UNIT DEQ #: 82555 FILE #: C121316A

HEALTH DEPT. #: 270018-01 ELEV. 105

USGS #: H-31 OLWR #: MS-6W-03808

OWNER: Humphreys Co. W.A. #1 QUAD: Midnight

LOCATION: SE/NE S 23 T 14N R 4W COUNTY: Humphreys

LOCATION DESCRIPTION: well in lg. fenced area, south of
ground tank.

CASING DIA: _____ PUMP TYPE & SIZE: Turbine Eled. 125

GPS FIELD LOCATION: LAT. 33° 02.46 N LONG. 90° 34.28 W

GPS CORRECTED LOCATION: LAT. 33.04624916 LONG. 90.57430704

REMARKS: Go ^{N.} 3.6 from Louise Take ^{old} 49W off to the left
into midnight, go .4 well on left side of
road.
cut on while

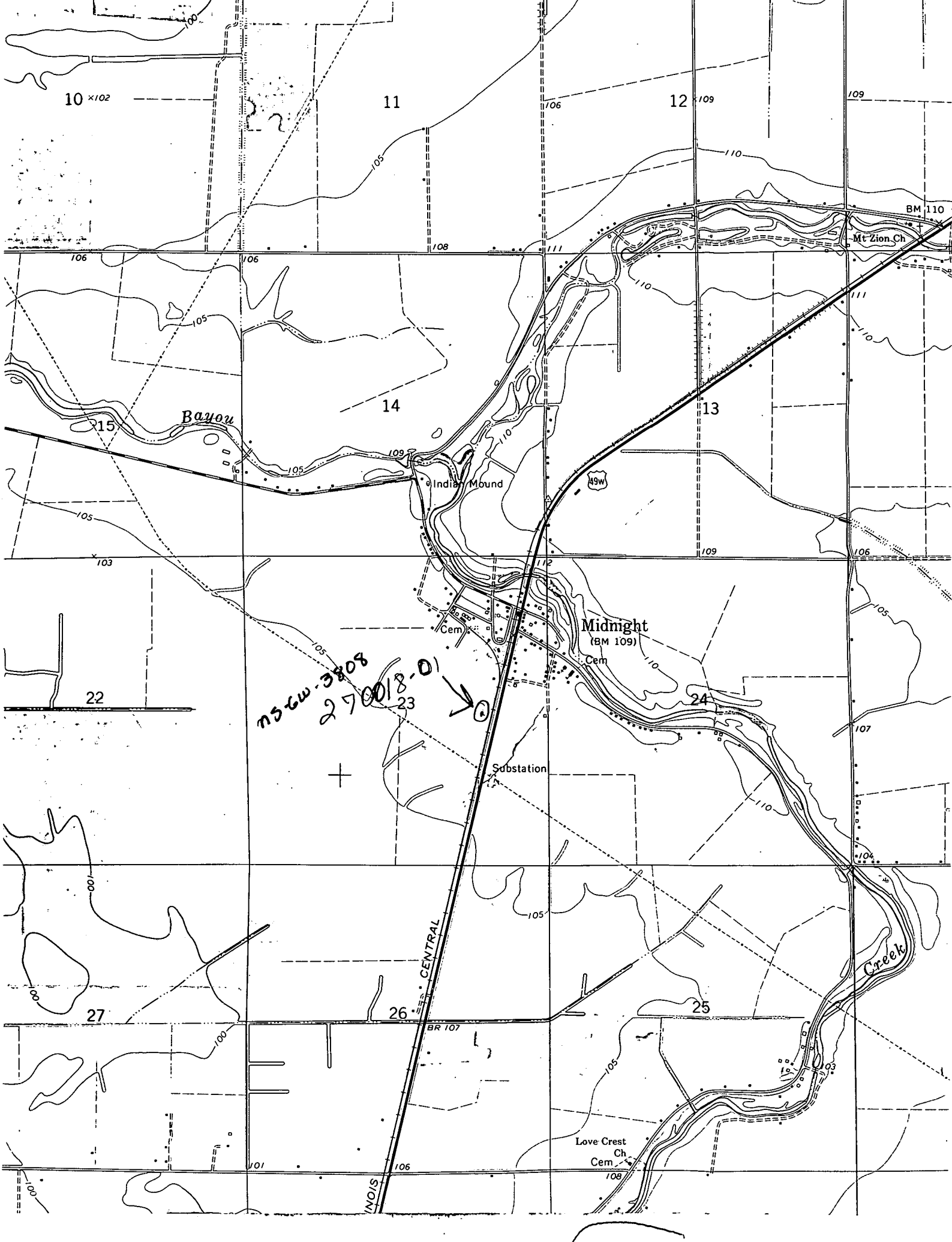

10 x102

11

12 x109

109

BM 110

Mt Zion Ch

Bayou

14

13

Indian Mound

149W

22

NS 6w-3808
2700/8-01



Midnight
(BM 109)

Cem

Substation

107

104

Creek

27

26

25

CENTRAL

BR 107

Love Crest
Ch
Cem

108

101

106