

WELL SCHEDULE

U. S. DEPT. OF THE INTERIOR

GEOLOGICAL SURVEY

WATER RESOURCES DIVISION

PUNCHED PUNCHED

MASTER CARD BSW-1974

Record by EJH Source of data \_\_\_\_\_ Date 1/5/54 Map mileston

State Missouri 28 County (or town) Humphreys 37

Latitude: 33<sup>deg</sup> 09<sup>min</sup> 02<sup>sec</sup> N Longitude: 090<sup>degrees</sup> 26<sup>min</sup> 17<sup>sec</sup> Sequential number: 1

Lat-long accuracy: 20 T 15 S, R 1 Sec 18 t, SE t, NE t, \_\_\_\_\_ B & M

Local well number: 6001DA1815NO1W Other number: \_\_\_\_\_

Local use: \_\_\_\_\_ Owner or name: \_\_\_\_\_

Owner or name: S S LOVE Address: \_\_\_\_\_

Ownership: County, Fed Gov't, City, Corp or Co, Private, State Agency, Water Dist P

Use of water: (A) Air cond, (B) Bottling, (C) Comm, (D) Dewater, (E) Power, (F) Fire, (G) Dom, (H) Irr, (I) Med, (J) P S, (K) Rec, \_\_\_\_\_

Use of well: (S) Stock, (T) Instit, (U) Unused, (V) Repressure, (W) Recharge, (X) Desal-P S, (Y) Desal-other, (Z) Other U

Use of well: (A) Anode, (D) Drain, (G) Seismic, (H) Heat Res, (I) Obs, (J) Oil gas, (K) Recharge, (L) Test, (M) Unused, (N) Withdraw, (O) Waste, (P) Destroyed. φ

DATA AVAILABLE: Well data □ Freq. W/L meas.: \_\_\_\_\_ Field aquifer char. □

Hyd. lab. data: \_\_\_\_\_

Qual. water data; type: \_\_\_\_\_

Freq. sampling: \_\_\_\_\_ Pumpage inventory: □ yes no, period: \_\_\_\_\_

Aperture cards: \_\_\_\_\_ yes □

Log data: \_\_\_\_\_ □ □

WELL-DESCRIPTION CARD

SAME AS ON MASTER CARD Depth well: \_\_\_\_\_ ft 67 Meas. rept accuracy □

Depth cased; (first perf.) \_\_\_\_\_ ft \_\_\_\_\_ Casing type: \_\_\_\_\_ Diam. 1 1/2 in \_\_\_\_\_

Finish: (C) porous concrete, (F) gravel w. (G) gravel w. (H) horiz. (I) open (J) perf., (K) screen, (L) sd. pt., (M) shored, (N) open hole, (O) other □

Method: (A) air rot, (B) bored, (C) cable, (D) dug, (E) hyd rot., (F) jetted, (G) air percussion, (H) rotary, (I) reverse, (J) trenching, (K) driven, (L) drive wash, (M) other □

Date Drilled: \_\_\_\_\_ Pump intake setting: \_\_\_\_\_ ft \_\_\_\_\_

Driller: \_\_\_\_\_ name (L) (M) address \_\_\_\_\_

Lift (type): (A) air, (B) bucket, (C) cent, (D) jet, (E) multiple, (F) multiple, (G) none, (H) piston, (I) rot, (J) submerg, (K) turb, (L) other □ Deep □ Shallow □

Power (type): diesel, elec, gas, gasoline, hand, gas, wind; H.P. \_\_\_\_\_ Trans. or meter no. \_\_\_\_\_

Descrip. MP Lower Water at 28 ft above below LSD, Alt. MP \_\_\_\_\_

Alt. LSD: \_\_\_\_\_ Accuracy: (source) \_\_\_\_\_ 4

Water Level 14.45 ft above below MP; Ft below LSD 12 Accuracy: \_\_\_\_\_ A

Date meas: 1/5/54 Yield: 154 gpm \_\_\_\_\_ Method determined \_\_\_\_\_

Drawdown: \_\_\_\_\_ ft \_\_\_\_\_ Accuracy: \_\_\_\_\_ Pumping period \_\_\_\_\_ hrs \_\_\_\_\_

QUALITY OF WATER DATA: Iron \_\_\_\_\_ ppm Sulfate \_\_\_\_\_ ppm Chloride \_\_\_\_\_ ppm Hard. \_\_\_\_\_ ppm

Sp. Conduct \_\_\_\_\_ K x 10 6 Temp. \_\_\_\_\_ °F \_\_\_\_\_ Date sampled \_\_\_\_\_

Taste, color, etc. \_\_\_\_\_

Well No. 61

Latitude-longitude \_\_\_\_\_  
d m s d m s

**HYDROGEOLOGIC CARD**

SAME AS ON MASTER CARD 03 Section: \_\_\_\_\_  
Province: \_\_\_\_\_

D Drainage Basin: 15J Subbasin: \_\_\_\_\_

Topo of well site: (D) depression, (C) stream channel, (E) dunes, (F) flat, (H) hilltop, (K) sink, (L) swamp, (M) offshore, (P) pediment, (S) hillside, (T) terrace, (U) undulating, (V) valley flat

MAJOR AQUIFER: Q.R series Miss R. Allen aquifer, formation, group MA

Lithology: U.R Origin: 3 Aquifer Thickness: \_\_\_\_\_ ft

Length of well open to: \_\_\_\_\_ ft Depth to top of: \_\_\_\_\_ ft

MINOR AQUIFER: \_\_\_\_\_ series \_\_\_\_\_ aquifer, formation, group \_\_\_\_\_

Lithology: \_\_\_\_\_ Origin: \_\_\_\_\_ Aquifer Thickness: \_\_\_\_\_ ft

Length of well open to: \_\_\_\_\_ ft Depth to top of: \_\_\_\_\_ ft

Intervals Screened: \_\_\_\_\_

Depth to consolidated rock: \_\_\_\_\_ ft Source of data: \_\_\_\_\_

Depth to basement: \_\_\_\_\_ ft Source of data: \_\_\_\_\_

Surficial material: \_\_\_\_\_ Infiltration characteristics: \_\_\_\_\_

Coefficient Trans: \_\_\_\_\_ gpd/ft Coefficient Storage: \_\_\_\_\_

Coefficient Perm: \_\_\_\_\_ gpd/ft<sup>2</sup>; Spec cap: \_\_\_\_\_ gpm/ft; Number of geologic cards: \_\_\_\_\_

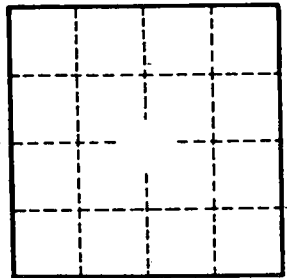
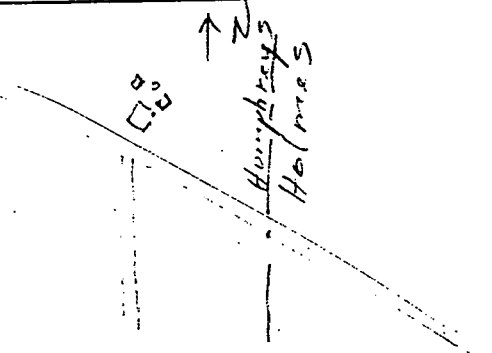

Well No. \_\_\_\_\_