

6/78 WTO

GW3797
TRANSMITTED FOR ADP

Midnight
F64

Recorded by WTO
Date 4/23/79

U.S. GEOLOGICAL SURVEY
WATER RESOURCES DIVISION
MISSISSIPPI DISTRICT
WELL RECORD
MAY 1979

Well No. _____
E-Log No. _____
County Humphreys

Site ID 330627090321001 R=0* T=A* 2=W*

Data reliab. 3-U* Report. agency 4-USGS* Dist. 6=28* 7=28* Co. 8=053*

Lat. _____ Long. 9=330627* 10=0903210* Well No. 12=F064*

Location 13=N, W, N, W, S, 32, T, 15, N, R, 03, W* Alt. 16=103.*

Hyd. Unit (OWDC) 20= Date 21=03/13/1979*

Well use 23=U* Water Use 24=I* Hole depth 27=115.* Well depth 28=115.*

WL 30=12.* Date 31=03/13/1979* Source 33=D*

Status 273= Project No. 5=

R=158* T=A* Date 159#03/13/1979* Owner No. (Fish pond)

Owner 161=LAMAR, KIKES*

R=192* T=A* Date 193# Temp. 196#00010* 197=

R=192* T=A* Date 193# Cond. 196#00095* 197=

R=192* T=A* Date 193# pH 196#00400* 197=

R=58* T=A* 59#1* Date 60=03/13/1979* Remarks _____

Drlg. 63=40A* Name Lanyie Method 65=R* Finish 66=S*

R=76* T=A* 59#1*

Top csgn. 77#0.* Bot. csgn. 78=75.* Diam. 79#12.*

R=76* T=A* 59#1*

Top csgn. 77# Bot. csgn. 78= Diam. 79#

R=82* T=A* 59#1* Top 83#75.* Bottom 84=115.*

Type 85=L* Diam. 87=12.* Size 88=

R=82* T=A* 59#1* Top 83# Bottom 84=

Type 85= Diam. 87= Size 88=

R= 46* T=A* 147#1* Q 150=2000.* Q/S 272=

134 flows 146 pumped

GEN. SITE DATA

OWNER

FIELD QW

CONSTR.

CASING

OPENINGS

YIELD

LIFT

R=42* T= A * Lift type 43# T* Intake 44= * Power type 45= D*

Date 38= 03/13/1979* H.P. 46= 30.*

LOGS

R=198* T= A * Log 199# D* Top 200= 0.* Bot 201= 115.*

R=198* T= A * Log 199# * Top 200= * Bot 201= *

R=189* T= A * E Log No. 190# * 191= M I S S D I S T *

ANAL.

R=114* T= A * Year 115# * Type 120= *

R=90* T= A * 256# 1 * Top 91= 20.* Bot 92= 115.*

Unit ID 93= 112MRVA * Name of Unit

R=90* T= A * 256# 1 * Top 91= * Bot 92= *

Unit ID 93= * Name of Unit

HYDRAULICS

R=98* T= A * 99# 1 * Unit tested 100= * 103= *

R=105* T= A * 99# 1 * Test No. 106# *

107= * Transmissivity (gal/d)/ft

108= * Hydraul. cond. (gal/d)/ft²

110= * Storage coeff. Boundaries

R=121* T= * Yr Begin 122# * Network 258= *

Water Level Data Collection (1)

description of formations encountered	from	to
clay	0	20
fine sand	20	30
coarse sand	30	45
very coarse sand/gravel	45	115

HUMPHREYS
F64
3-13-79

MISSISSIPPI
 BOARD OF WATER COMMISSIONERS
 416 North State Street
 Jackson, Mississippi 39201

CODED

WATER WELL DRILLERS LOG

3-13 19 79 Larry's Well & Pump Co. Humphreys
 date well completed firm name county well located

LANDOWNER: James Kibus
Silver City, Miss
 (mailing address)

description of formations encountered	from	to
<u>clay</u>	<u>0</u>	<u>20'</u>
<u>fine sand</u>	<u>20'</u>	<u>30'</u>
<u>fine coarse sand</u>	<u>30'</u>	<u>45'</u>
<u>fine coarse sand gravel</u>	<u>45'</u>	<u>115'</u>

WELL LOCATION:
 sec 32 T 15 N R 3 W
1 mi W miles 2 west of Silver City
 (distance) (direction) (nearest town)

WELL PURPOSE: high pond
 (home, irrigation, municipal, industrial)

- WELL COMPLETION DATA:
- (1) diameter (inches) 12"
 - (2) total depth (feet) 115'
 - (3) static water level (feet) 12' below top of ground.
 - (4) casing steel 75'
 (material) (depth)
 (size) if telescope see back.
 - (5) screen 40' 75'
 (length) (depth to top)
12" steel
 (size) (material)
 - (6) pump 30 2000
 (HP) (yield gpm)
0
 (type power)
 - (7) electric log no
 (yes or no)
 (organization running log)
 - (8) how well bottom plugged steel plate

CODED

Miss. Board of Water Comm.

APR 16 1979

DRILLERS REMARKS:

RECEIVED

*CONTOUR
Bellewood
Ditch*

INDIANOLA 28 MI.
BELZONI 4.5 MI.

90° 30'
33° 07' 30"

729 32' 30"

730

440 000 FEET 731

733

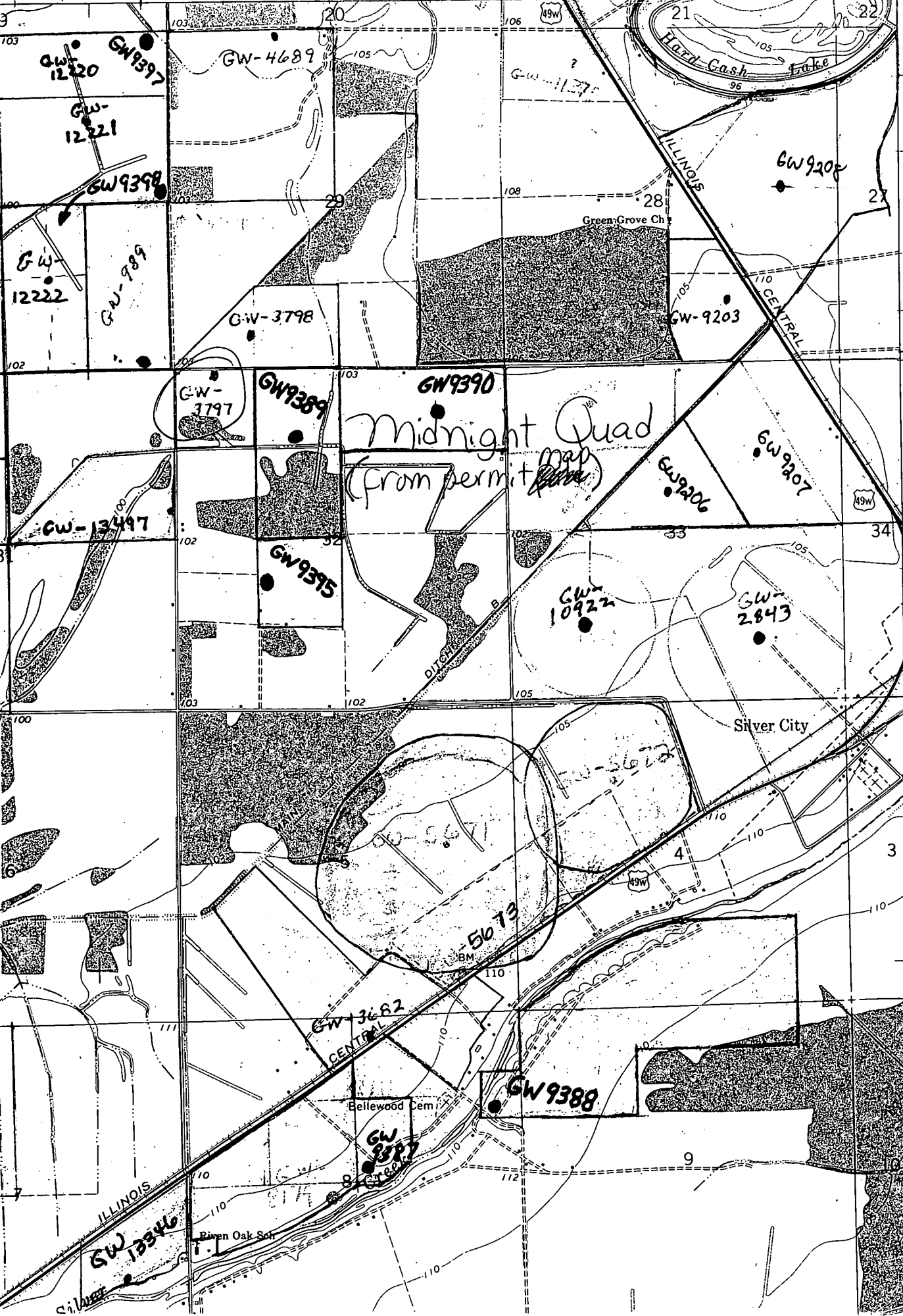

*Midnight Quad
(from permit map)*

950 000
FEET

T. 15 N.
T. 14 N.

3664

3662

3667

3666

3665

3664

3664

3662

27

34

33

105

3

5'

9

10

21

105

108

106

110

102

103

102

100

105

110

110

110

110

110

110

110

110

110

110

110

110

110

106

108

106

110

102

103

102

100

105

110

110

110

110

110

110

110

110

110

110

110

110

110

110

106

108

106

110

102

103

102

100

105

110

110

110

110

110

110

110

110

110

110

110

110

110

110